



**THE  
BASEMENT  
WATCHDOG™  
Special**

# Battery Backup Sump Pump System

---

## Instruction Manual

---





*Battery Operated*  
**SUMP PUMP**

TEST

Push to  
Test  
System

RESET

Push to  
Silence  
Pump Alarm

Warning	What to do
● BATTERY	Terminals corroded or battery defective Clean terminals or replace battery
● FUSE	Replace with 25 amp auto fuse If fuse blows again, replace pump
● WATER	Add distilled water to battery
● PUMP	Pump was activated Check main pump for failure
● POWER	Check circuit breaker & charging plug If power is on, replace charger

Charger Operating ●

# Table of Contents

## Important Safety Instructions

General . . . . .1  
AC Power Requirements . . . . .1  
Personal Precautions . . . . .1  
Preparing to Charge . . . . .1  
DC Connection Precautions . . . . .1

## Introduction

Items Included in System . . . . .2  
Additional Items Needed . . . . .2

## Pump & Pipe

### Installation Instructions

Direct Discharge to Outside . . . . .3,4  
Hookup to Existing Discharge Pipe . . .5,6

## Battery Instructions

Preparation of the Battery . . . . .7

## Control Unit Hookup

Positioning the Float Switch . . . . .8  
Installing the Battery Fluid Sensor . . .8  
Hooking Up the Pump . . . . .8  
Hooking Up the Battery . . . . .8  
Hooking Up the Charger . . . . .8

## Understanding the Warning

### Lights and Alarms

Silencing the Alarm  
During an Emergency . . . . .9  
Battery Alarm . . . . .9  
Cable or Terminal Problems . . . . .9, 10  
Replacing the Battery . . . . .10  
Fuse Alarm . . . . .10  
Water Alarm . . . . .10  
Power Alarm . . . . .11  
Pump Alarm . . . . .11  
Replacing the Pump . . . . .11  
Charger Operating . . . . .11  
Test Button . . . . .11  
Testing the Float Switch . . . . .11

## Parts & Service Information

Technical Support . . . . .11

# Important Safety Instructions

## General

Do not expose the control unit to rain or snow.

Pull the plug rather than the cord when disconnecting the control unit.

An extension cord should not be used unless absolutely necessary.

To reduce the risk of electric shock, unplug the control unit and disconnect the cables from the battery before attempting any maintenance or cleaning.

Do not disassemble the control unit. When service is required, contact Glentronics technical support at (800) 991-0466, option 3.

## AC Power Requirements

The control unit must receive 115 volts AC +/- 5% from the AC outlet. Any voltage lower than this will cause the power failure alarm to activate. Lower voltages can be caused by utility company brown outs or heavy power draw from other appliances on the same circuit.

## Personal Precautions

Wear eye protection and avoid touching your eyes while working near the battery.

If battery acid contacts skin or clothing, wash immediately with soap and water. If acid enters eye, immediately flood eye with running cold water for at least 10 minutes and get medical attention.

Never smoke or allow a spark or flame in the vicinity of the battery.

Remove personal metal items such as rings, bracelets, watches, etc. when working with a lead-acid battery.

## Preparing to Charge

Charge only LEAD-ACID batteries with the Basement Watchdog Special control unit. Do not use the control unit for charging dry-cell batteries that are most commonly used with home appliances.

Be sure the area around the battery is well-ventilated.

When cleaning or adding water to the battery, gas can be forcefully blown away from the top of the battery by using a piece of cardboard or other *non-metallic* material as a fan.

Clean the battery terminals. Be careful to keep corrosion from coming in contact with your eyes.

## DC Connection Precautions

Connect and disconnect the battery cable rings only after removing the charger from the electric outlet. *Never allow the rings to touch each other.*

Coat the terminals with a thin coat of petroleum jelly to retard corrosion.

Attach the rings on the ends of the battery cables to the battery posts and secure them with wing nuts to insure a good connection.

Follow these steps when the battery is installed. A spark near the battery may cause a battery explosion. To reduce the risk of a spark near the battery:

Check the polarity of the battery posts. The POSITIVE (+) battery post usually has a larger diameter than the NEGATIVE (-) post.

Connect the large ring on the POSITIVE (RED) wire from the control unit to the POSITIVE (+) post of the battery. Connect the small ring on the NEGATIVE (BLACK) wire from the control unit to the NEGATIVE (-) post of the battery.

When disconnecting the control unit, first disconnect the charger, and then remove the rings from the battery terminals.

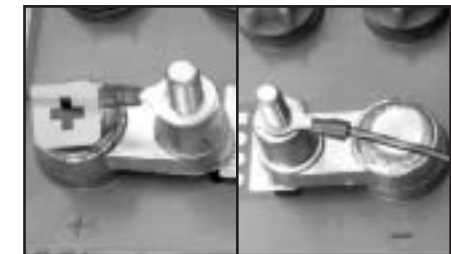

POSITIVE POST HAS LARGER DIAMETER

NEGATIVE POST HAS SMALLER DIAMETER

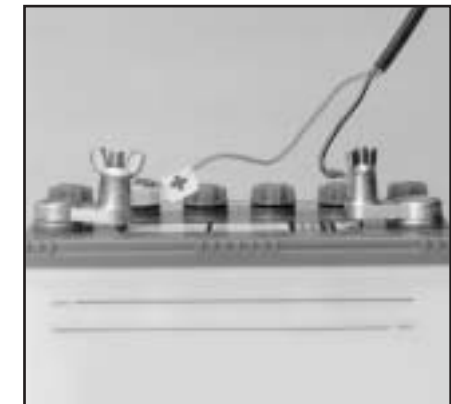

## Introduction

The Basement Watchdog Special backup sump pump system is battery-operated. It is designed as an emergency backup system to support your regular AC sump pump, and it will automatically begin pumping if your main AC pump fails. Should any malfunction or emergency occur that involves the sump pump, the battery, or the AC power, your Basement Watchdog system will sound an alarm and indicate the nature of the problem and the solutions by means of a lighted display on the control panel.

### **The Basement Watchdog sump pump system includes:**

- A control unit with a float switch and a battery fluid level sensor
- A pump with 1 1/2" PVC pipe adapter
- A plastic wire tie for mounting the float switch
- A battery box with safety strap
- A battery cap with a hole to accommodate the fluid sensor
- A battery charger
- A 20 amp fuse
- A plug to silence the POWER alarm

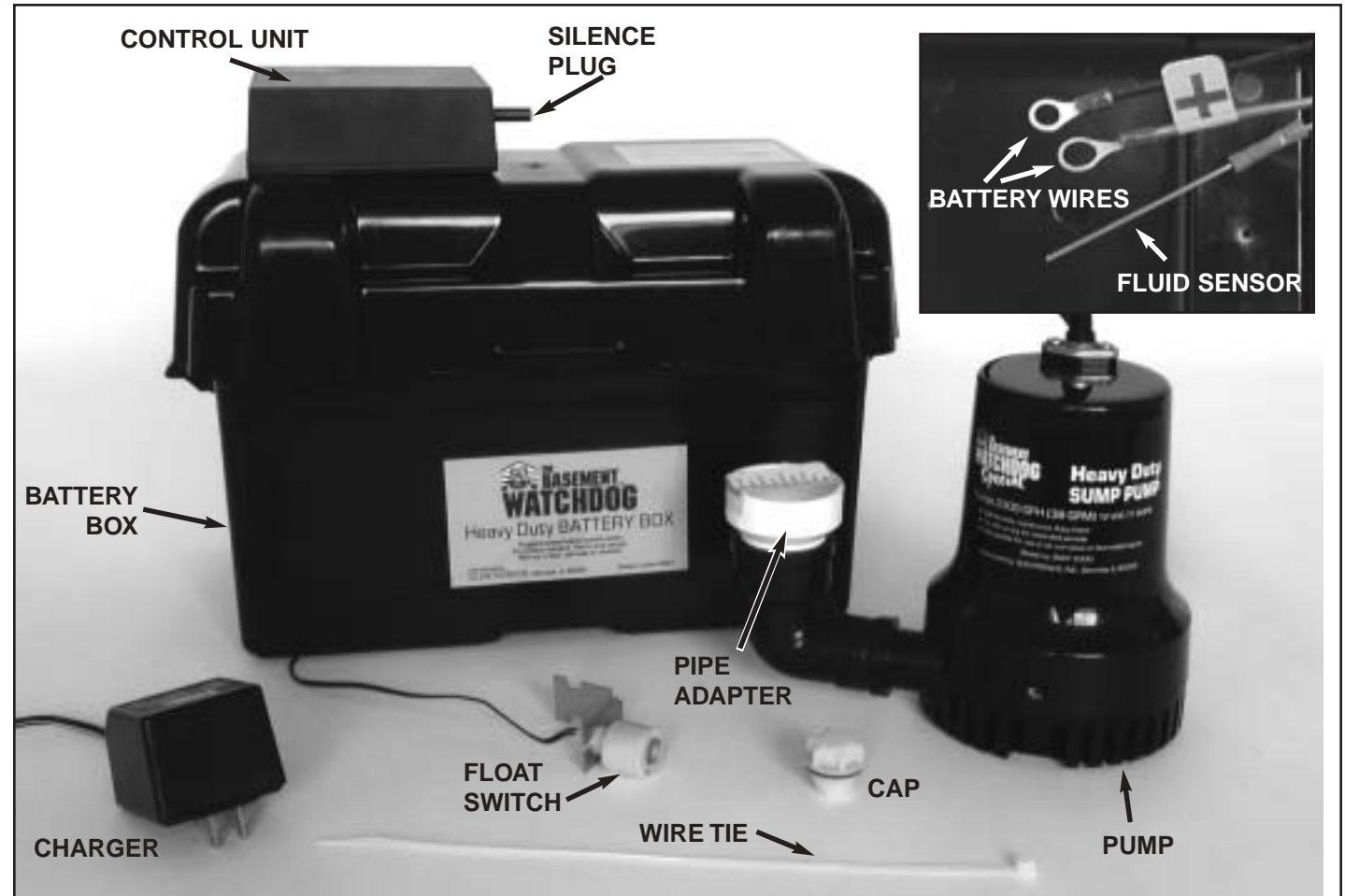

### **You will also need to supply:**

- A Basement Watchdog 7.5 Hour Battery, or another deep cycle battery (*Do not use a maintenance-free or a sealed battery.*)
- 1 1/2" PVC pipe and fittings
- PVC cement and primer
- A rubber union with hose clamps or a "Y" connector and two (2) check valves depending on the installation method you use
- Six (6) quarts of 1.265 specific gravity battery acid



### **For narrow sump pits you will need some additional parts:**

- An "L" bracket at least 6 inches long. (Preferably one that will not rust.)
- Two (2) stainless steel hose clamps
- One (1) stainless steel screw (#8-32 x 3/4"), a matching washer & nut



## Pump & Pipe Installation Instructions (Direct Discharge to Outside)

There are two basic methods that can be used to install the pump, (A) a direct discharge to the outside of the building, or (B) a hookup to an existing discharge pipe.

Whenever possible, install your Basement Watchdog Special system with a direct discharge to the outdoors. By using this method, there will always be an outlet for the water from the sump. During times of very heavy rain, many storm sewers fill up. If your pump is trying to discharge water into a full sewer, there is nowhere for the water to go. This defeats the purpose of the backup system. By discharging directly outdoors, there is always an outlet for the water that is pumped out of the sump.

There are two options for installing your sump pump with a direct discharge to the outside. If you have a sump pit wide enough to place the backup pump next to the main pump, use Method A. If your sump pit is too narrow, the pump may be mounted above the main pump. In this instance use the instructions for Method Aa.

### METHOD A: DIRECT DISCHARGE TO THE OUTSIDE OF THE BUILDING (Diagram A)

1. Cut a four-foot (4') piece of 1 1/2" rigid PVC pipe and cement it to the threaded fitting that is attached to the elbow on the pump.
2. Secure the pump wire so that the plug on the end will not fall into the sump. Attach the wire to the pipe with a piece of tape.

3. Place the pump with the 4' PVC pipe attachment on the bottom of the sump floor next to the main AC pump. Do not mount the pump to any existing pipes...it should be placed on the floor of the sump. A brick may be placed under the pump if there are rocks or other debris on the sump floor.

4. Attach a rubber union (sold separately) to the top of the 1 1/2" pipe. This will allow the pump to be removed easily, should the need arise.

The path of the rest of the pipe and the details of each installation will vary. Using sound plumbing practices try to route the discharge pipe to an exterior wall via the shortest path with the fewest turns. The pipe section exiting the building should be on a downward slope so that the water in the pipe will exit outside rather than return to the sump. Extend the discharge pipe outside the building as far as possible to avoid the return of discharged water to the sump. Be sure to seal the hole in the wall where the pipe exits and cement or clamp all connections securely to prevent leaking. No check valve is needed with this method of installation, as long as you use less than 20 feet of pipe.

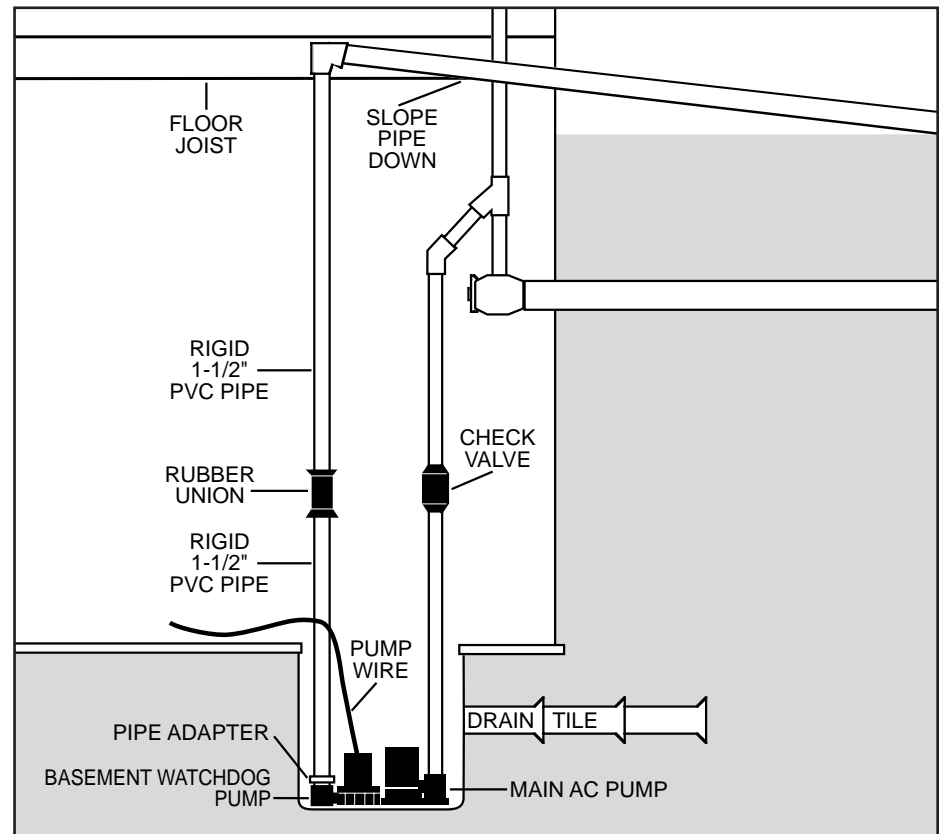
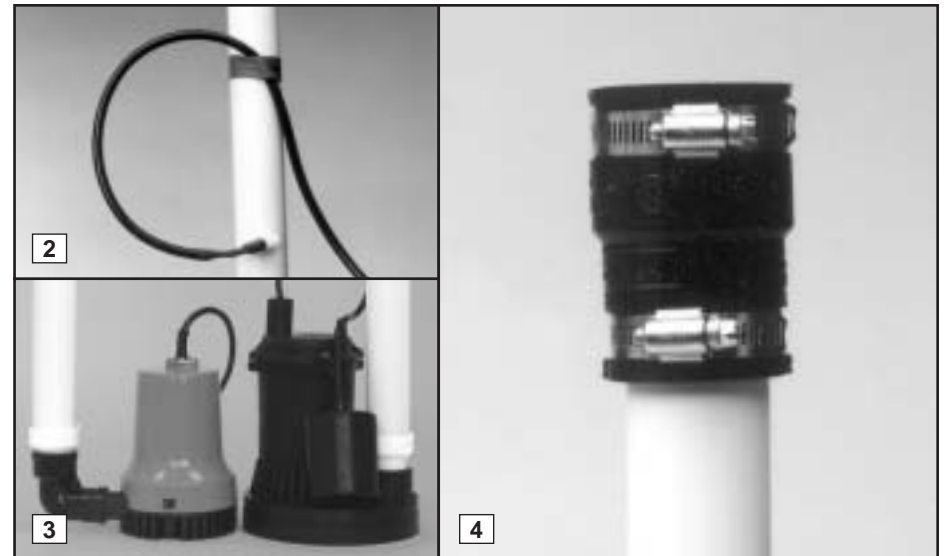

Diagram A

## Pump & Pipe Installation Instructions (Direct Discharge to Outside)

### METHOD Aa: DIRECT DISCHARGE TO THE OUTSIDE OF THE BUILDING FOR NARROW SUMP PITS (Diagram Aa)

- Attach an "L" bracket to the discharge pipe of the main AC pump with two (2) stainless steel hose clamps. Position the bracket so the bottom of the "L" is just above the top of the main pump, and out of the way of any float switch on the main pump.
- (a) Remove the black bottom strainer of the pump by pressing in the two tabs on the strainer. There are holes suitable for mounting on the bottom of the strainer. (b) Using a #8-32x3/4" stainless screw, washer & nut, attach the strainer to the "L" bracket. (c) Once the strainer is attached, simply press the pump body onto the mounted strainer.
- Cut a three-foot (3') piece of 1 1/2" rigid PVC pipe and cement it to the threaded fitting that is attached to the elbow on the pump.
- Secure the pump wire so that the plug on the end will not fall into the sump. Attach the wire to the pipe with a piece of tape.
- Attach a rubber union (sold separately) to the top of the 1 1/2" pipe. This will allow the pump to be removed easily, should the need arise.

The path of the rest of the pipe and the details of each installation will vary.

Using sound plumbing practices try to route the discharge pipe to an exterior wall via the shortest path with the fewest turns. The pipe section exiting the building should be on a downward slope so that the water in the pipe will exit outside rather than return to the sump. Extend the discharge pipe outside the building as far as possible to avoid the return of discharged water to the sump. *Be sure to seal the hole in the wall where the pipe exits and cement or clamp all connections securely to prevent leaking.* No check valve is needed with this method of installation, as long as you use *less than 20 feet* of pipe.

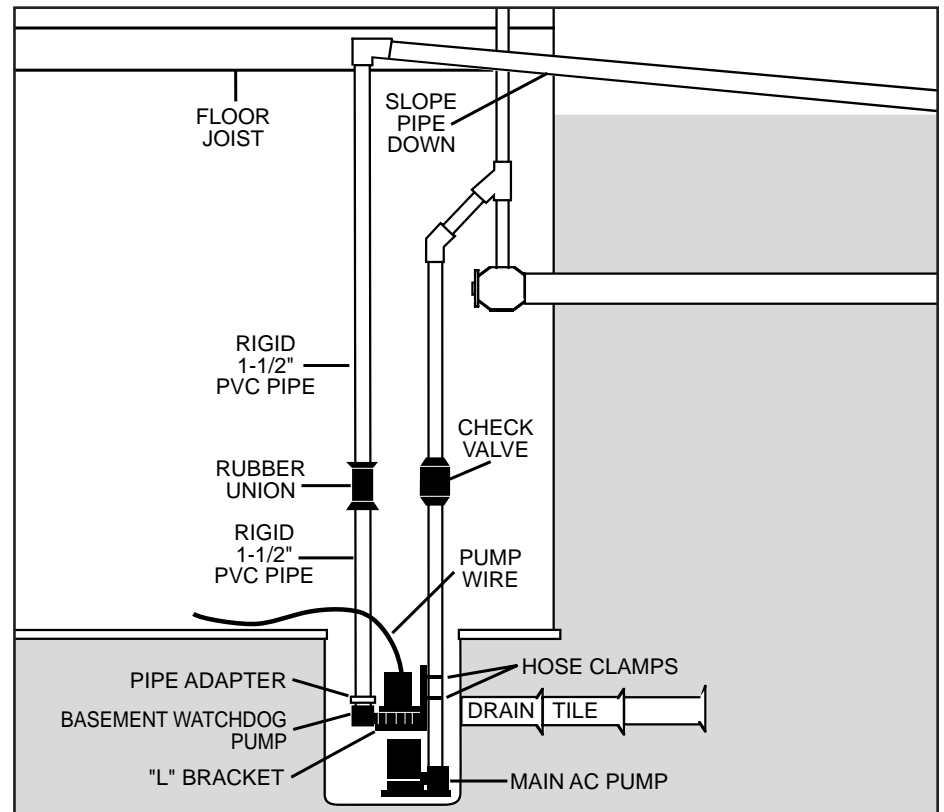
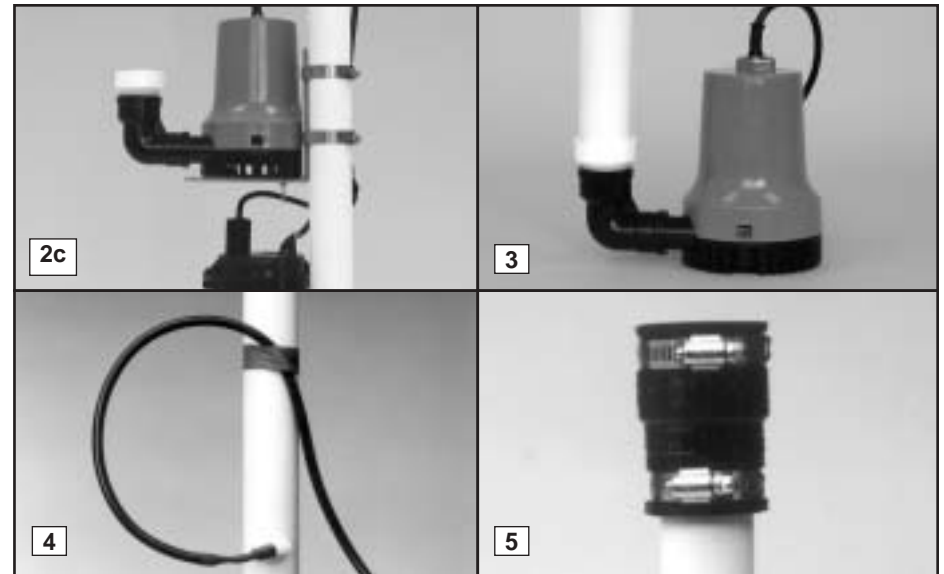
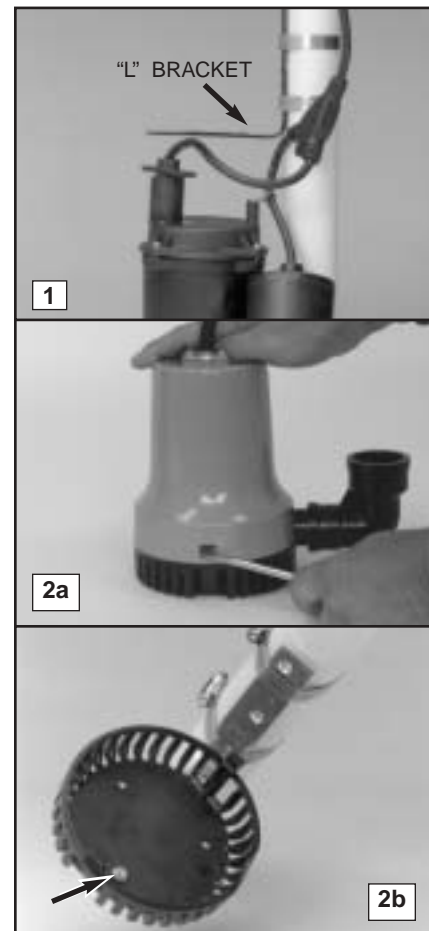

Diagram Aa



## Pump & Pipe Installation Instructions (Hookup to Existing Discharge Pipe)

If the direct discharge method (Method A) is not possible, the Basement Watchdog Special backup system can be hooked up to the same pipe as your AC sump pump by installing a "Y" connector and two check valves.

Check your local plumbing codes. Some municipalities prohibit the discharge of sump water into the sewer system.

If you have a sump pit wide enough to place the backup pump next to the main pump, use Method B. If your sump pit is too narrow, the pump may be mounted above the main pump. In this instance use the instructions for Method Bb.

### METHOD B: HOOKUP TO AN EXISTING DISCHARGE PIPE (Diagram B)

1. Cut a four-foot (4') piece of 1 1/2" rigid PVC pipe and cement it to the threaded fitting that is attached to the elbow on the pump.
2. (a) Install a check valve on the PVC pipe attached to the Basement Watchdog pump. (b) IMPORTANT: WHEN A CHECK VALVE IS USED, DRILL A 1/8" HOLE IN THE 1 1/2" PVC PIPE THREE INCHES (3") ABOVE THE CONNECTION TO THE BASEMENT WATCHDOG SPECIAL PUMP. Drill the hole at a 45° angle toward the bottom of the sump to avoid splashing water outside the sump pit. If a 1/8" hole is not drilled above the pump, an air lock may prevent the pump from pumping.
3. If there is no check valve on the

pipe of the main AC pump, one must be installed at this time. Then install a "Y" connector above the check valve on the discharge pipe for the main AC pump.

4. Secure the pump wire so that the plug on the end will not fall into the sump. Attach the wire to the pipe with a piece of tape.
5. Place the pump with the 4' PVC pipe attachment on the bottom of the sump floor, next to the main AC pump. *Do not mount the pump to any existing pipes...it should be placed on the floor of the sump.* A brick may be placed under the pump if there are rocks or other debris on the sump floor.
6. Connect a 1 1/2" diameter discharge pipe above the check valve of the Basement Watchdog pump, and attach a 45° elbow to that pipe. Extend another piece of pipe to reach the "Y" connector you have inserted above the check valve on the discharge pipe of the main pump.
7. Cement or clamp all connections securely to prevent leaking.

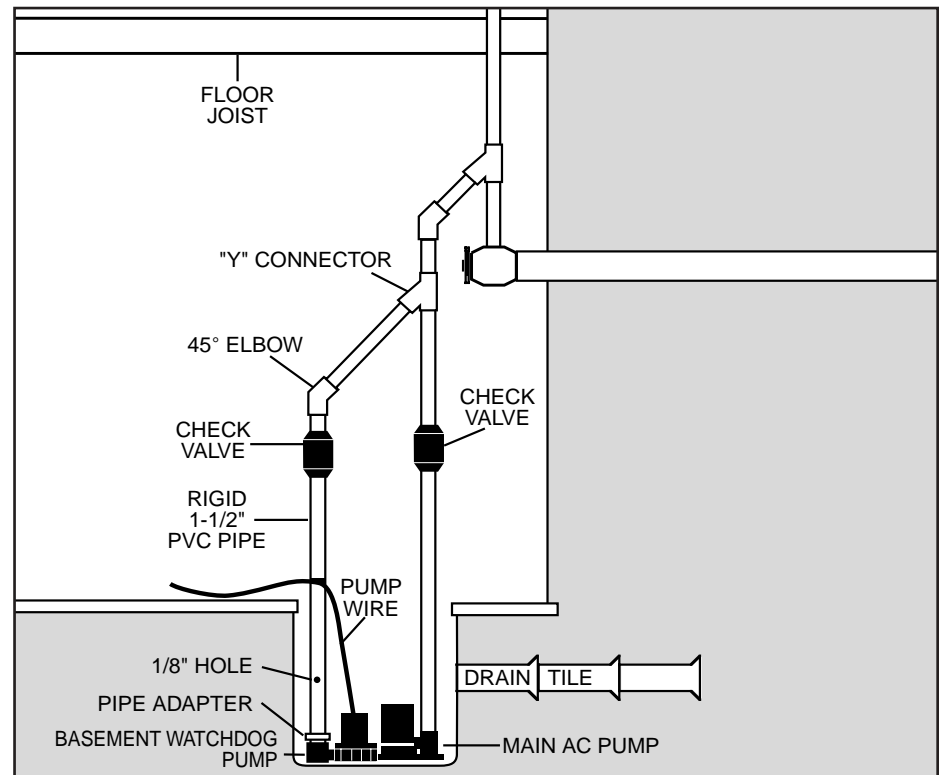
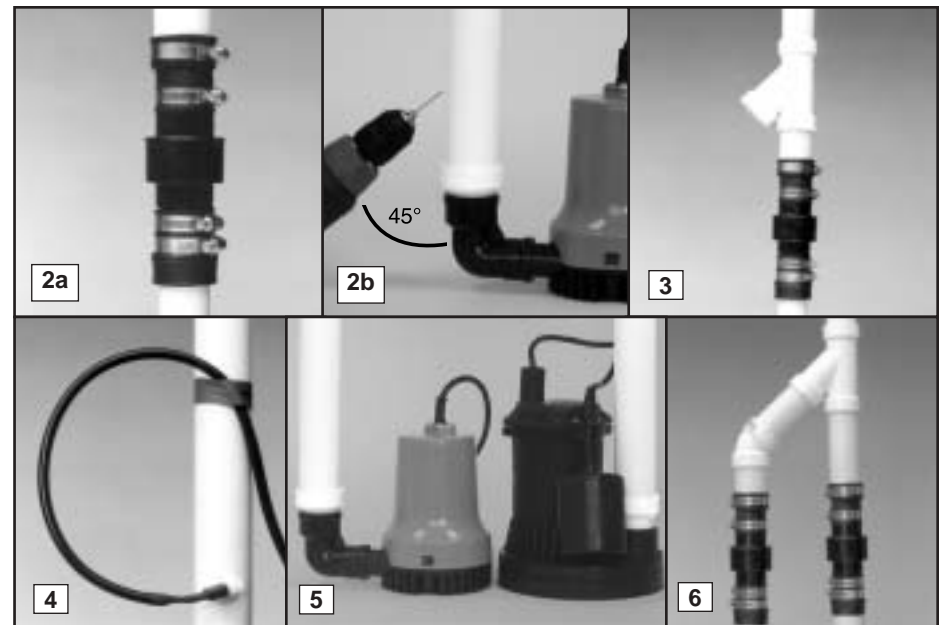
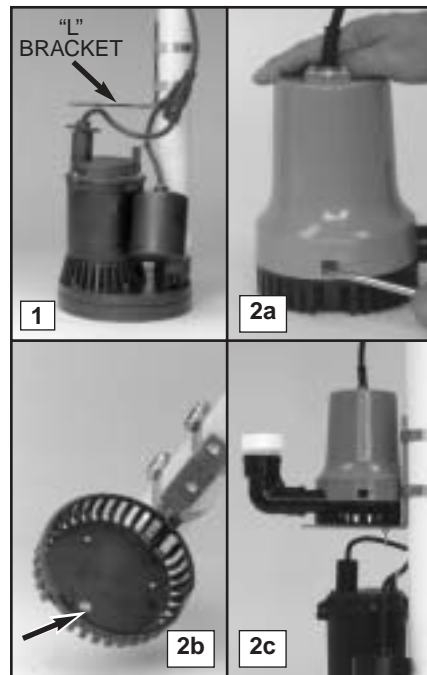

Diagram B

## Pump & Pipe Installation Instructions (Hookup to Existing Discharge Pipe)

### METHOD Bb: HOOKUP TO AN EXISTING DISCHARGE PIPE FOR NARROW SUMP PITS (Diagram Bb)

- Attach an "L" bracket to the discharge pipe of the main AC pump with two (2) stainless steel hose clamps. Position the bracket so the bottom of the "L" is just above the top of the main pump, and out of the way of any float switch on the main pump.
- (a) Remove the black bottom strainer of the pump by pressing in the two tabs on the strainer. There are holes suitable for mounting on the bottom of the strainer. (b) Using a #8-32x3/4" stainless screw, washer and nut, attach the strainer to the "L" bracket. (c) Once the strainer is attached, simply press the pump body onto the mounted strainer.
- Cut a three-foot (3') piece of 1 1/2" rigid PVC pipe and cement it to the threaded fitting that is attached to the elbow on the pump.
- (a) Install a check valve on the PVC pipe attached to the Basement Watchdog pump. (b) IMPORTANT: WHEN A CHECK VALVE IS USED, DRILL A 1/8" HOLE IN THE 1 1/2" PVC PIPE THREE INCHES (3") ABOVE THE CONNECTION TO THE BASEMENT WATCHDOG PUMP. Drill the hole at a 45° angle toward the bottom of the sump to avoid splashing water outside the sump pit. If a 1/8" hole is not drilled above the pump, an air lock may



prevent the pump from pumping.

- If there is no check valve on the pipe of the main AC pump, one must be installed at this time. Then install a "Y" connector above the check valve on the discharge pipe for the main AC pump.
- Secure the pump wire so that the plug on the end will not fall into the sump. Attach the wire to the pipe with tape.
- Connect a 1 1/2" diameter discharge pipe above the check valve of the Basement Watchdog pump, and attach a 45° elbow to that pipe. Extend another piece of pipe to reach the "Y" connector you have inserted above the check valve on the discharge pipe of the main pump.
- Cement or clamp all connections securely to prevent leaking.

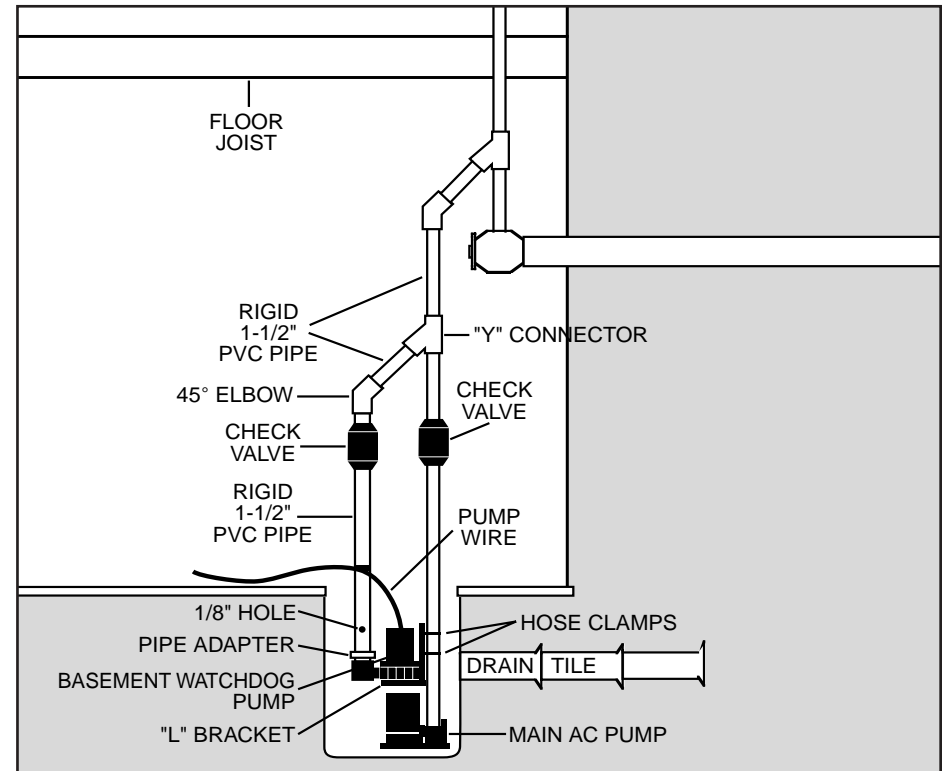
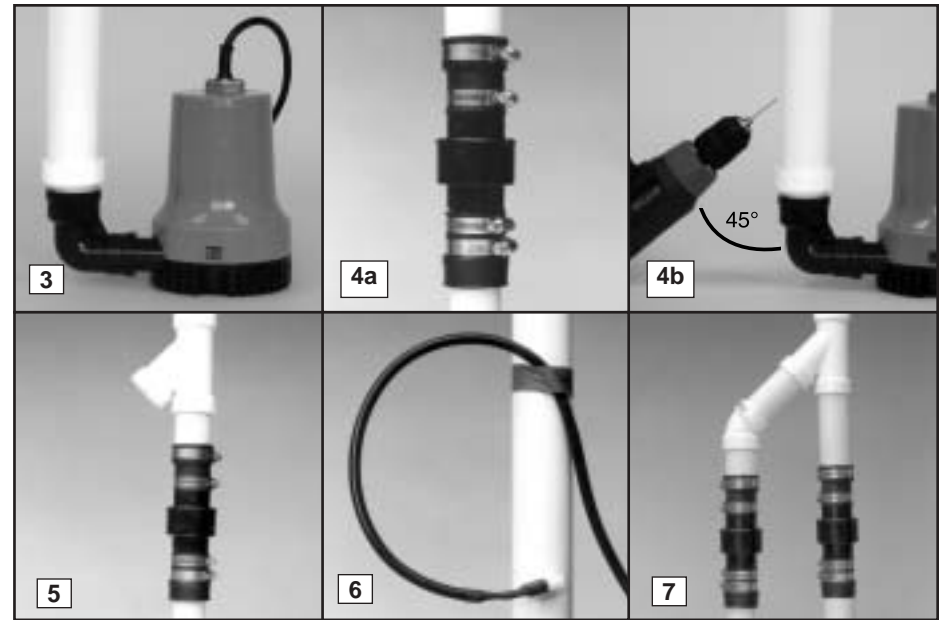

Diagram Bb

## Battery Instructions

The Basement Watchdog 7.5 Hour Standby Battery has been designed to run this system for a minimum of 7.5 hours of continuous pumping. However, most of the time the pump will turn on and off, and the battery will run the pump intermittently for days. In addition, the unique materials in the battery enable it to last for five to seven years in standby service.

The use of automotive batteries is *not* recommended. Automotive batteries are not designed for this application. They will only run the pump for a short time and will have a shorter life than a standby battery. Do not use a maintenance-free or sealed battery. They are made of different materials and will trigger a false "Battery problem" alarm.

In addition, the battery fluid sensor and cap are designed to fit the Basement Watchdog batteries. (As a safety precaution, do not use the cap on batteries of a different brand, and do not drill a hole in the cap of another brand of battery to accommodate the fluid sensor.)

### PREPARING THE BASEMENT WATCHDOG STANDBY BATTERY

The Basement Watchdog 7.5 Hour Standby Battery is shipped dry (without acid) so it never loses power before you take it home. A battery is activated when the acid is added, and then it slowly begins to deteriorate as it ages. By adding the acid just before use, the battery will always be fresh. Use 1.265 specific gravity battery acid to fill the battery. It is available where you purchased the battery.

### IMPORTANT: REVIEW THE SAFETY INSTRUCTIONS BEFORE YOU PROCEED

1. Place the battery box on the floor. Position the battery box safety strap under the box and through the loop on the top of the battery box.
2. Place the dry (unfilled) battery into the battery box. Remove the foil seal on the top of the battery.
3. (a) Carefully push in the perforated tab at the top of the acid pack. Pull up the large tab and pull out the dispensing hose. Hold the hose upright above the pack and squeeze the hose forcing all the acid back into the pack. Cut off the tip of the hose. (b) Position the acid pack and battery as shown in picture 3b. Insert the end of the hose into each cell. Control the flow by pinching the hose with thumb and forefinger. *Fill each cell of the battery to a level just covering the battery plates, and then go back and top off each cell equally. It is important to have the cells filled equally.* (c) The acid should reach a level just below the cap ring. (Diagram C)

A newly filled battery will sometimes require additional acid after about ten minutes. Re-examine the fill level and add additional acid, if necessary. The battery acid may bubble at this time and give off a sulfur-like smell, but this is normal. After the battery has been filled, screw the caps on the top of the battery.

Always be careful and avoid contact with skin, clothing, furniture or floor.

When you fill the battery for the first time, it will be the only time you add acid to the battery. When the fluid level is low, add distilled water to the cells. Never add more acid.

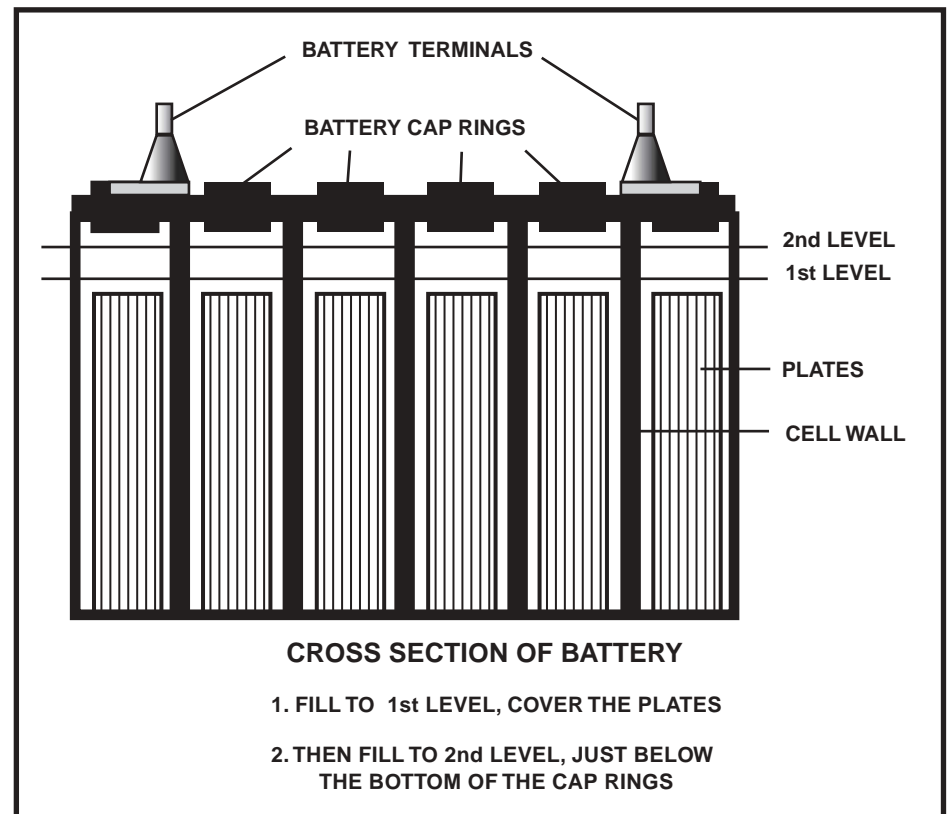
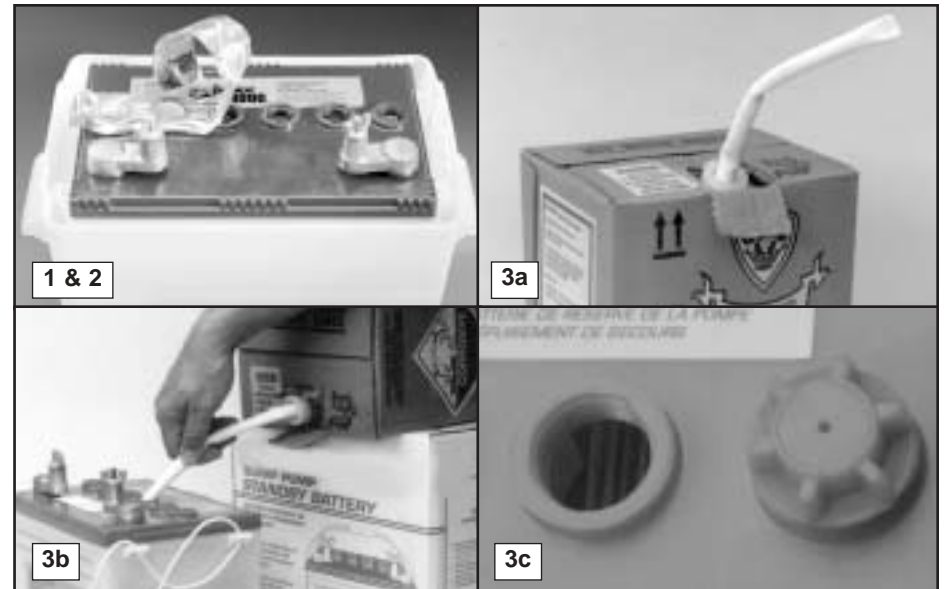

Diagram C



## Control Unit Hookup

When you position the control unit, be sure the charger cord will reach the AC power outlet and the pump cable and the float switch will reach the bottom of the sump. Position the unit in a well-ventilated area. (Diagram D)

1. **Positioning the float switch:** The float switch will turn on the pump when the water rises to the top of the switch, and it will remain running as long as the water is above the float switch. When the water drops below the float switch an internal timer in the control unit will keep the pump running an additional 30-40 seconds to empty the sump pit. The switch should be mounted six inches (6") above the activation level of the main AC pump. Attach the float switch very securely to the discharge pipe of the backup pump with the plastic wire tie. (If you are stacking the pumps in a narrow sump pit, the float may be attached to the elbow of the backup pump.) *Be sure the switch is positioned vertically with the mounting bracket at the top. Do not tilt the switch. Do not position the float switch on the side of the discharge pipe facing the drain tile or any incoming rush of water! Do not position it next to the power cord of the AC pump.*

2. **Installing the battery fluid sensor:** Replace the battery cap that is 2nd from the POSITIVE (+) post of the battery with the battery cap that is provided in the Basement Watchdog sump pump package. An arrow on the top of the battery marks this position. There are two holes in the sensor cap. Insert the fluid sensor in the hole

that is off-center on the top of the cap. *Do not glue the sensor into the cap. If you are not using the Basement Watchdog battery, you cannot use the battery fluid sensor, however you must attach the sensor to the POSITIVE (+) post of the battery or the alarm will sound continuously. The Basement Watchdog Special sump pump system will not warn you if the fluid level is low in this configuration. You will need to check your battery every couple of months to see if it needs water.*

3. **Hooking up the pump:** Plug the pump wires into the pump connector on the back of the control unit.
4. **Hooking up the battery:** Remove the wing nuts. Coat the terminals with a little petroleum jelly to prevent corrosion. Attach the battery cables to the battery...the RED wire to the POSITIVE (+) post, the BLACK wire to the NEGATIVE (-) post. Tighten the wing nuts.
5. **Hooking up the charger:** Immediately plug the charger into the charger hole on the back of the control unit and into an AC outlet on the wall.
6. If the pump alarm is sounding, press the reset button to silence the alarm.
7. Put the cover on the battery box, and secure it with the safety strap.

**The Basement Watchdog Special Battery Backup Sump Pump System is ready to use!**

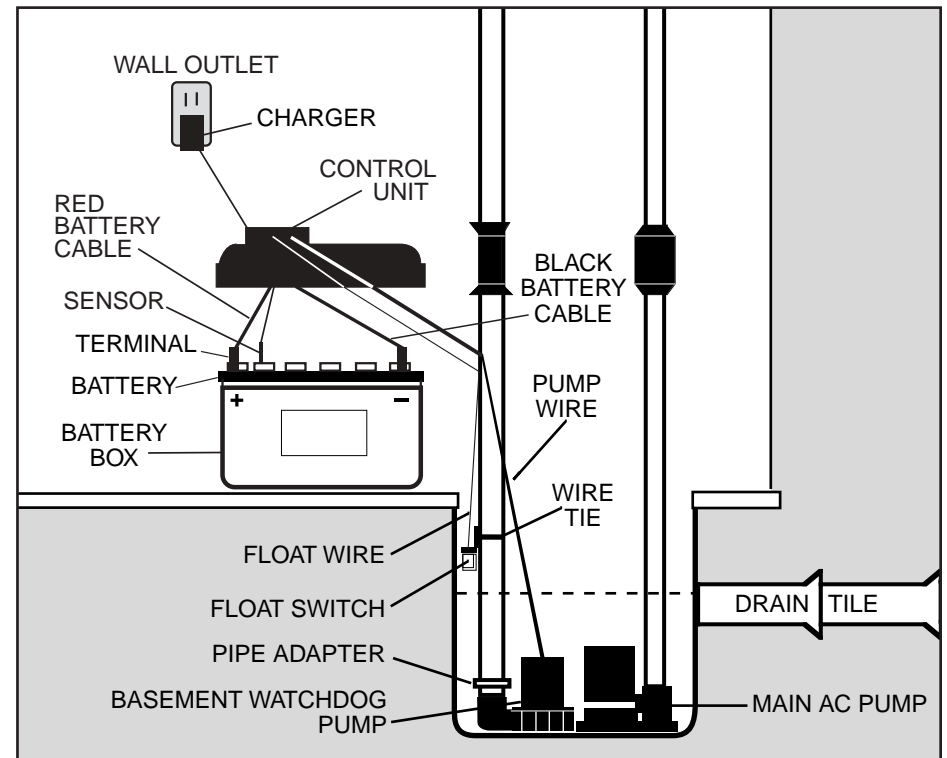
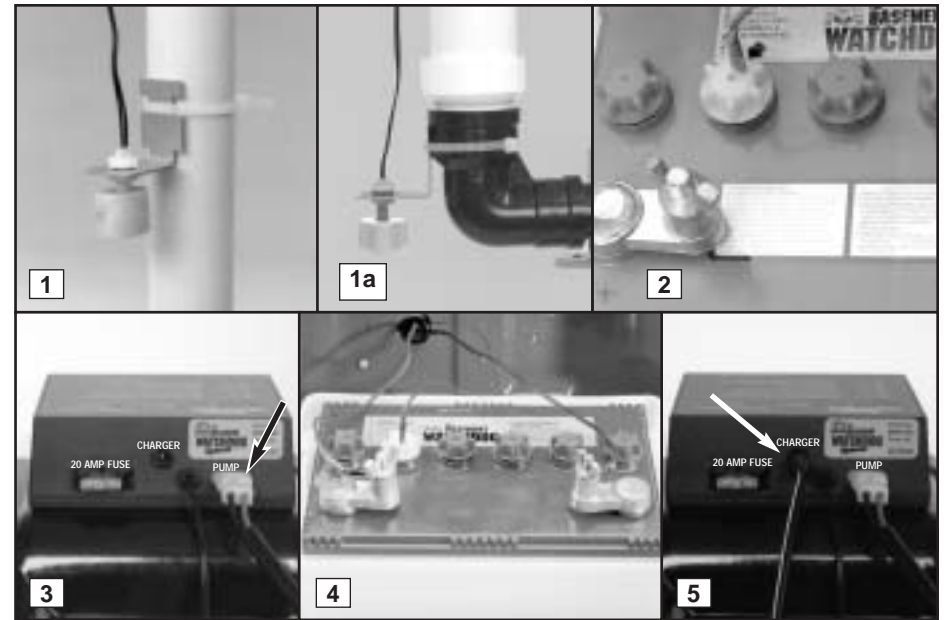

Diagram D

## Understanding the Warnings & Alarms

The Basement Watchdog Special control unit features a series of warning lights that pinpoint potential problems. In addition, an alarm sounds to alert you to the problem. In some cases, the lights and alarm will go off automatically when the problem has been solved. In others, the RESET button must be pushed to silence the alarm. Refer to the table below for a quick review of the features and their corresponding alarm status.

Warning	Alarm shuts off automatically when problem is corrected
BATTERY	Yes
FUSE	Yes
WATER	Yes
PUMP	No, must push "RESET" button
POWER	Yes

### FRONT PANEL OF CONTROL UNIT

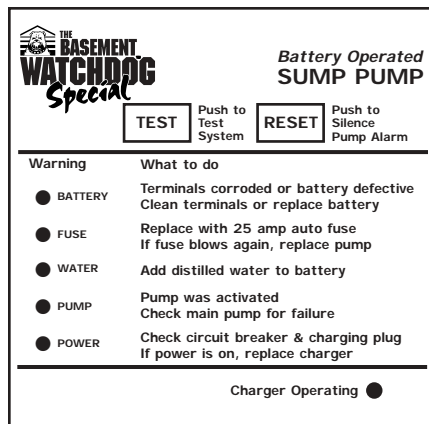

## SILENCING THE ALARM DURING AN EMERGENCY

Your Basement Watchdog Special sump pump system is equipped with a plug that allows you to silence the POWER and PUMP alarms during an emergency or power failure. The plug is located in a bag attached to the charger cord. To silence the alarm, insert the plug into the jack on the right side of the control unit. The plug must be removed and the alarm should be reactivated when the emergency is over, or when the power is restored. This plug does not effect the BATTERY, FUSE, and WATER alarms.

To reactivate the alarm, remove the plug and place it back in the bag on the charger cord. If your pump was activated during the power outage, the PUMP alarm will still be sounding. Press the RESET button to silence that alarm.

If you do not remove the plug, you will not be warned the next time a POWER or PUMP emergency arises.

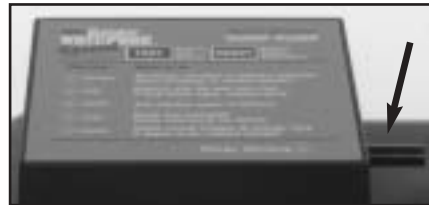

## BATTERY ALARM

This light and alarm will go on when the control unit senses that the battery has approximately 1/2 hour of pumping energy left. This could occur when the pump has been running for many hours and is reaching the last half-hour of operating power, or it could occur because the battery is getting old and should be replaced.

The alarm can also be triggered by corrosion of the battery cable and the

battery terminals. Clean and tighten the battery terminals as described at the right. If this warning goes on while the pump is running, you will have a minimum of 1/2 hour to replace the battery. (In most cases, the pump does not run continuously, and therefore, you actually have much longer.) In a severe emergency, if a replacement battery is not available, you could temporarily use your car battery.

Once the AC power is restored, the battery will recharge, unless it is old or damaged. The alarm will go off when the AC power is restored and the pumping energy reaches 1/2 hour or more.

In the event that your Basement Watchdog Special sump pump system has been called on to pump for extended periods of time, the battery can become very depleted. In this condition, when the AC power is returned to the unit, a BATTERY alarm will continue to sound. The battery may need a longer period to recharge.

For a fast recharge, an automotive or marine battery charger can be used to recharge the battery. **When another charger is used, first disconnect the controller from the battery.**

To silence the alarm while the battery is recharging, do the following:

1. Insert the plug into the jack on the right side of the control unit.
2. Press the TEST button, but not the RESET button.
3. Leave the system in this condition for 24 hours.
4. After a 24-hour charging period, remove the plug and press the RESET button.
5. If the battery is recharged, all alarms will be off.
6. If the alarm is still sounding, the battery is defective or the posts are corroded. Clean the terminals. If the alarm still sounds, replace the battery.



## TO CHECK FOR CABLE OR TERMINAL PROBLEMS

### IMPORTANT: REVIEW THE SAFETY INSTRUCTIONS BEFORE YOU PROCEED

1. Unplug the charger from the wall outlet.
2. Remove the battery cables and clean the battery posts with a battery post terminal cleaner or a wire brush and a 50/50 solution of water and baking soda. Do not allow the soda water to enter the battery. Thoroughly dry the posts and apply a thin coat of petroleum jelly or another terminal protective material.
3. Clean the corrosion off of the connectors on the end of the battery wires. Use a stiff brush or sandpaper.
4. Replace the battery cables, RED to the POSITIVE (+) post, and BLACK to the NEGATIVE (-) post.
5. Plug the charger into the wall outlet.
6. You may have to press the RESET button to silence the pumping alarm.

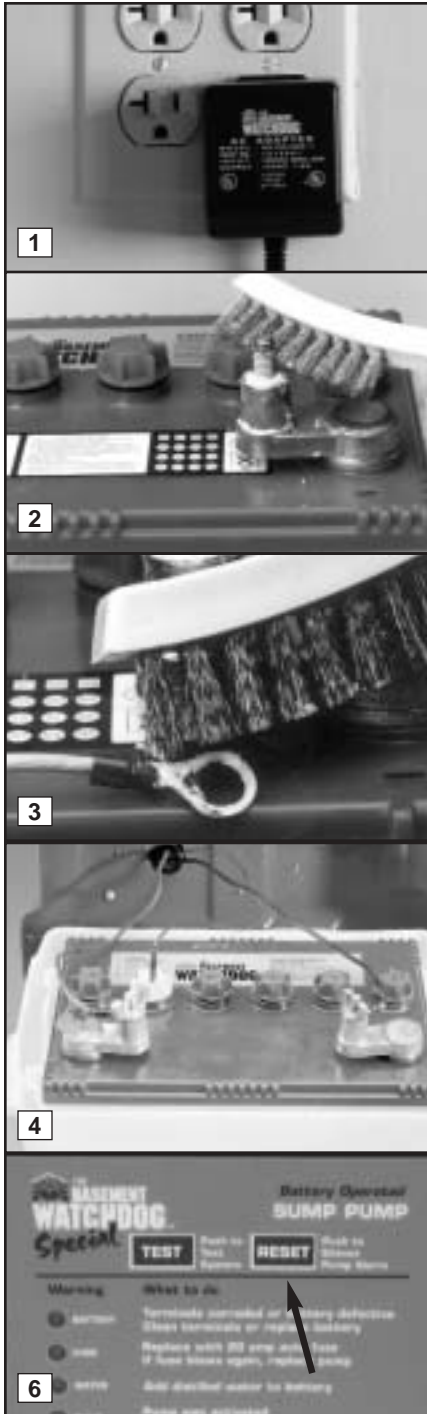

## REPLACING THE BATTERY

**IMPORTANT: REVIEW THE SAFETY INSTRUCTIONS BEFORE YOU PROCEED.**

1. Unplug the charger from the wall.
2. Remove the battery cables from the battery posts.
3. Fill the battery following the instructions on page 7.
4. Coat the battery terminals with a little petroleum jelly and replace the battery cables, RED to the POSITIVE (+) post and BLACK to the NEGATIVE (-) post. Replace the battery cap in the cell which is 2nd from the POSITIVE post with the yellow cap from the old battery. Insert the fluid sensor in the cap.
5. Plug the charger into the wall outlet.
6. You may have to press the reset button to silence the pumping alarm.

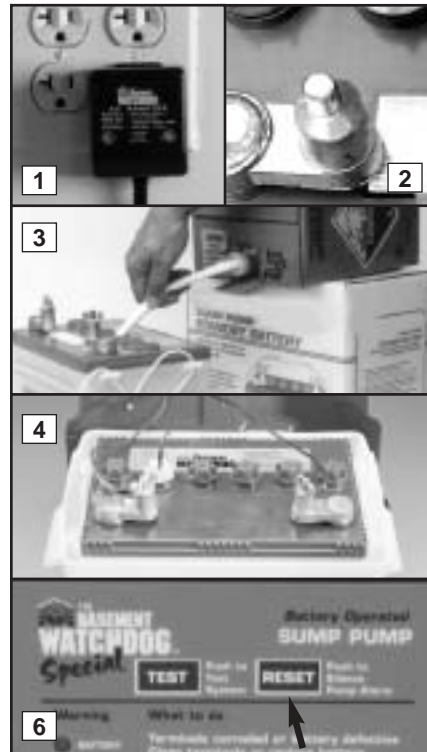

## FUSE

This alarm indicates that the 20-amp safety fuse on the back of the control unit has blown. This can be the result of a clogged pump motor, or pump wires that have been shorted out. To correct the problem:

1. Unplug the charger from the wall and remove the cables from the battery.
2. Check the pump for debris and remove it if any is found.
3. Check the pump wires. Make sure there are no exposed wires touching. Insulate any exposures with electrical tape.
4. Replace the 20-amp fuse on the back of the unit.
5. Reconnect the battery cables to the battery the RED cable to the POSITIVE (+) post, the BLACK cable to the NEGATIVE (-) post.
6. Plug the charger into the wall.
7. Press the test button. If the fuse blows again, replace the pump.

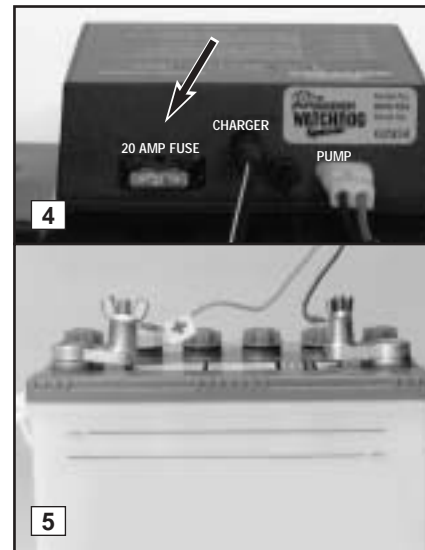

## WATER ALARM

If this warning light and alarm are on, you need to add distilled water to the battery.

**IMPORTANT; REVIEW THE SAFETY INSTRUCTIONS BEFORE YOU PROCEED**

Remove the top of the battery box. Unscrew the six battery caps. Add distilled water to each cell. If distilled water is not available; tap water with a low mineral content may be used. Well water is not recommended. *Never add more acid.* Fill the battery to the 2nd level as shown in Diagram C on page 7. Replace the caps and the fluid sensor. Be sure the fluid sensor is positioned in the 2nd cell from the positive post. It's marked with an arrow on the top of the battery. The warning light will turn off automatically when the battery is refilled.

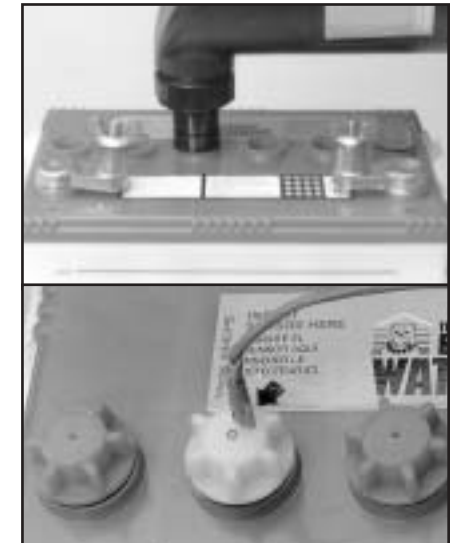



## POWER ALARM

There are several causes for power failure. The most common is a power outage by your electric company. During this emergency, the Basement Watchdog Special system will automatically switch to battery power and protect your basement from flooding. You can silence the POWER alarm temporarily by inserting the plug into the silence jack on the side of the control box (see page 9). The light and the alarm will both turn off. The Basement Watchdog Sump Pump System will continue to operate and pump while the alarm is silenced. This plug also silences the PUMP alarm.

If the power is on in the rest of the house, check the home circuit breaker or fuse box for failure, and correct the problem.

Check the charger. Make sure it is securely plugged into the wall outlet.

Check the charger plug that fits into the rear panel of the control unit. Make sure it is securely plugged into the control unit.

The control unit must receive 115 volts AC +/- 5% from the AC outlet. Any voltage lower than this will cause the power failure alarm to activate. Lower voltages can be caused by utility company brown outs or heavy power draw from other appliances on the same circuit.

If all the connections are secure and the wall outlet is operating, but the POWER warning light is still lit, replace the charger unit with a Basement Watchdog 1.6 amp charger. Contact Glentronics, Inc. at (800) 991-0466, option 3.

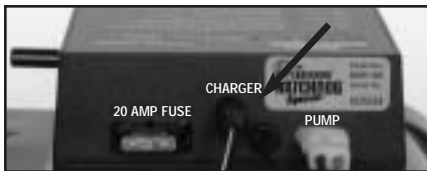

## PUMP ALARM

The PUMP warning stays on to alert you to the fact that the standby system was used to empty water from the sump. Try to determine what caused the system to operate. Check the main pump for failure. Another possibility is that the power was out while you were away and the backup system automatically pumped the water out of the sump. Or, if the incoming water was more than your AC sump pump could handle, then the backup system automatically pumped the water out of the sump. It is also possible that your check valve is stuck and needs to be replaced.

After determining the source of the problem, push the RESET button to silence the alarm.

## REPLACING THE PUMP

1. Unplug the charger and the pump from the back of the control unit.
2. Release the rubber union or check valve and remove the pump and the rigid PVC pipe section from the sump.
3. Unscrew the pipe and fitting from the old pump and screw them into the new pump.
4. Lower the pump into the sump and reconnect the rubber union or check valve.
5. Plug the pump wires and charger into the back of the control panel.

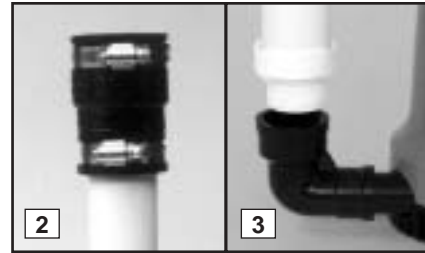
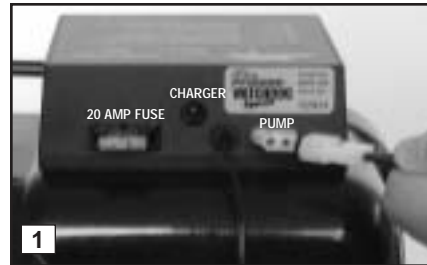

## CHARGER OPERATING

This green light should always be lit. It indicates that the charger is operating and that all connections are intact. If for any reason the AC power is interrupted, or a plug comes loose, this light will go off, the red POWER light will appear, and an alarm will sound.

Check the charger. Make sure it is securely plugged into the wall outlet.

Check the charger plug that fits into the rear panel of the control unit. Make sure it is securely plugged into the control unit.

If all connections are secure and the wall outlet is operating, but the POWER warning light is still flashing, replace the charger unit with a Basement Watchdog 1.6 amp charger from Glentronics, Inc.



## TEST BUTTON

The TEST button may be used to check the pump and system. Push the TEST button. This will activate the pump for as long as you hold the button, and it will activate the pumping cycle for 30-40 seconds after you release it.

## TESTING THE FLOAT SWITCH

**Manually testing the float switch periodically is highly recommended.**

Lift the float up and let go. This will activate the pump. The controller will run the pump for approximately 40 seconds so it can empty all the water in the sump pit. If there is no water in the sump, the pump can run dry for this amount of time. The alarm will sound and the pump light will go on. After the pump has stopped, push the RESET button to silence the alarm. If the RESET button is pressed before the pump has stopped, the alarm will go off temporarily. Wait for the pump to stop pumping, then push the RESET button to completely silence the alarm.



## PARTS & SERVICE INFORMATION

You can receive technical support, parts or service information by calling Glentronics, Inc. at (800) 991-0466, option 3. Send your unit to the following address for repairs:

Glentronics, Inc.  
1150 Willis Ave.  
Wheeling, IL 60090-5817