

**SECTIONAL VIEW**  
**EVMSU(L)1**

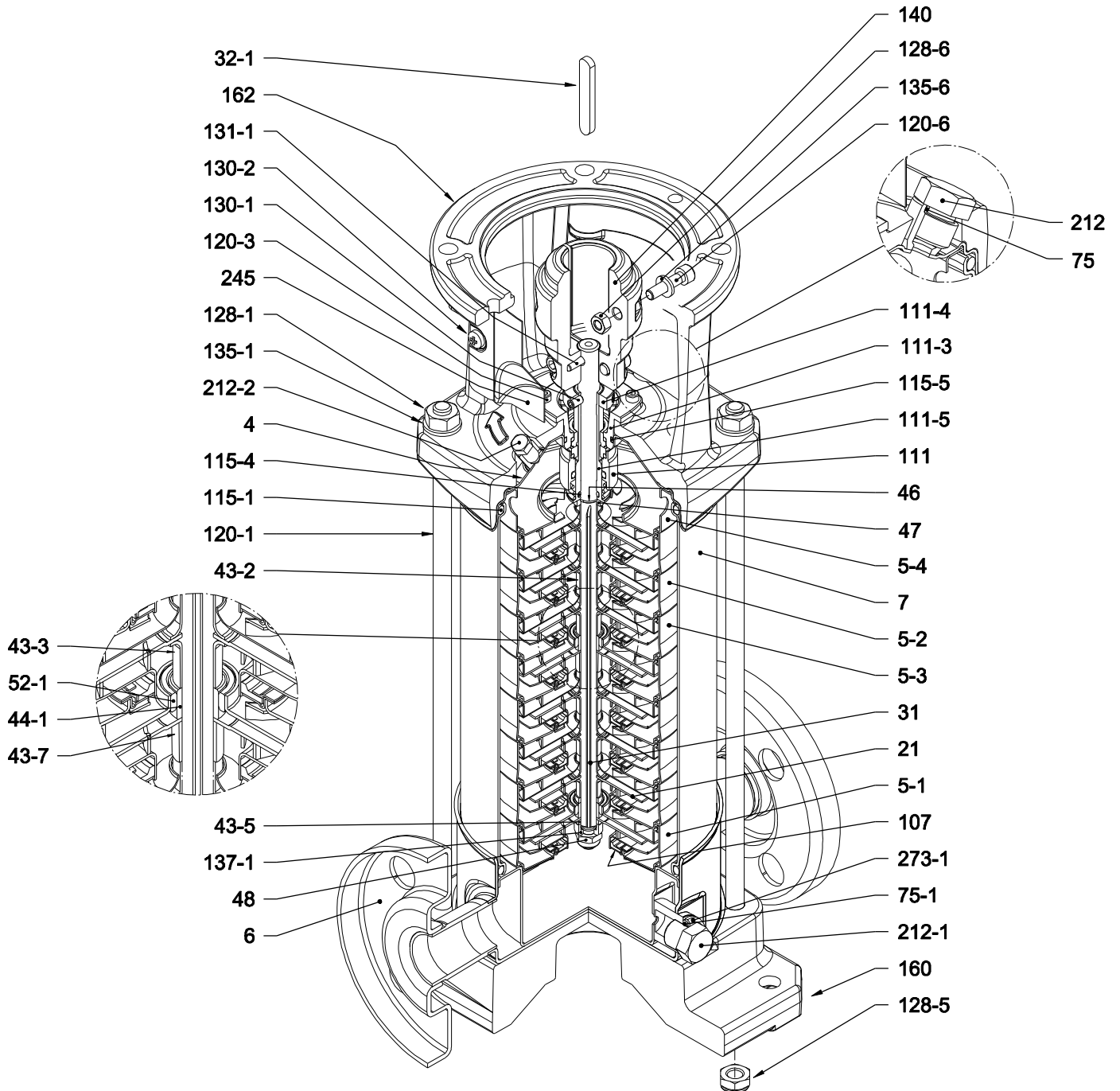

with Round (ANSI Compatible) flange (F)

**PIPE CONNECTION**  
**EVMSU(L)1**

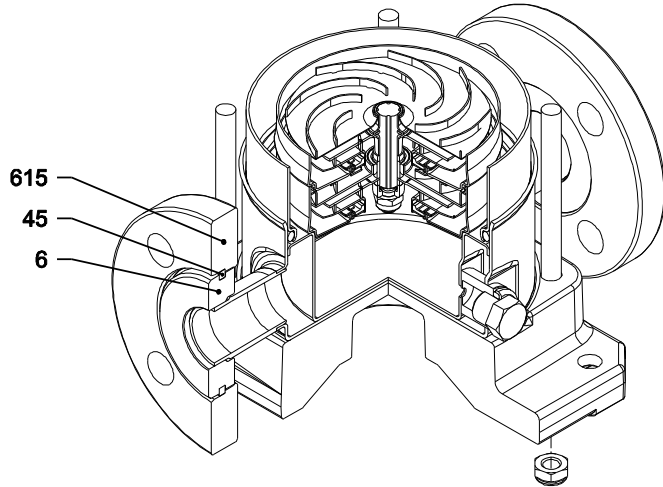

with Loose round ANSI compatible flange (L)

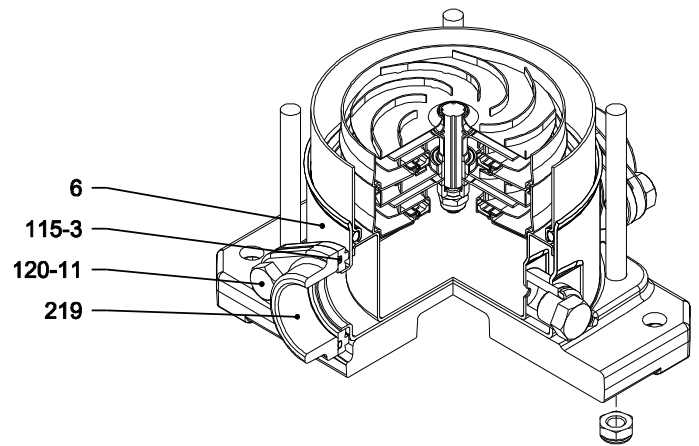

with Oval flange (N)

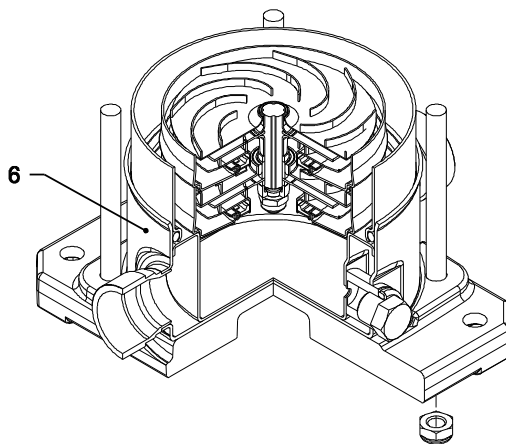

with victaulic connection (V)

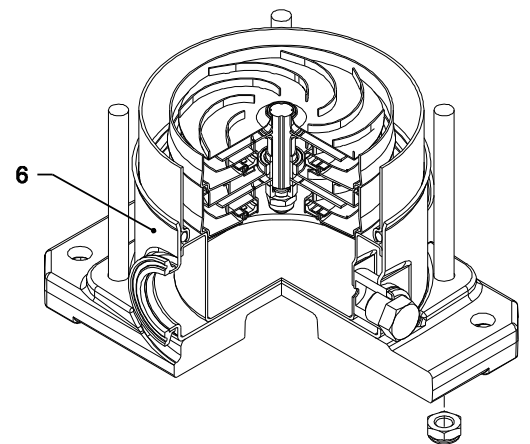

with Clamp connection (C)

**SECTIONAL VIEW PART REFERENCE**
**EVMSU(L)1**

N°	PART NAME	MATERIAL		DIMENSIONS [mm]	STANDARD
		EVMSU	EVMSUL		
4	Casing cover	AISI 304 (EN 1.4301)	AISI 316 (EN 1.4401)		
5-1	Suction casing	AISI 304 (EN 1.4301)	AISI 316 (EN 1.4401)		
5-2	Intermediate Casing	AISI 304 (EN 1.4301)	AISI 316 (EN 1.4401)		
5-3	Intermediate casing bearing	AISI 304 (EN 1.4301)	AISI 316 (EN 1.4401)		
5-4	Discharge casing	AISI 304 (EN 1.4301)	AISI 316 (EN 1.4401)		
6	Bottom casing	AISI 304 (EN 1.4301)	AISI 316 (EN 1.4401)		
7	Outer casing	AISI 304 (EN 1.4301)	AISI 316L (EN 1.4404)		
21	Impeller	AISI 304 (EN 1.4301)	AISI 316 (EN 1.4401)		
31	Shaft	AISI 304 (EN 1.4301)	AISI 316L (EN 1.4404)		
32-1	Adjuster Key	AISI 304 (EN 1.4301)			
43-2	Shaft sleeve (intermediate)	AISI 304 (EN 1.4301)	AISI 316L (EN 1.4404)	12x10	
43-3	Shaft sleeve (bearing)	AISI 304 (EN 1.4301)	AISI 316 (EN 1.4401)		
43-5	Shaft sleeve (last stage)	AISI 304 (EN 1.4301)	AISI 316 (EN 1.4401)		
43-7	Spacer	AISI 304 (EN 1.4301)	AISI 316L (EN 1.4404)	12x10	
44-1	Shaft sleeve bearing	Tungsten carbide			
45	Flange holder	AISI 304 (EN 1.4301)			
46	Ring (mechanical seal)	AISI 316L (EN 1.4404)			
47	Ring Holder	AISI 304 (EN 1.4301)	AISI 316 (EN 1.4401)		
48	Impeller nut	A2-70 UNI 7323 with inox insert	A4-70 UNI 7323 with inox insert	M8	
52-1	Bearing	Tungsten carbide			
75	O-Ring (plug)	FPM		D. 12.37x2.62	OR 3050
75-1	O-Ring (plug)	FPM			
107	Liner ring	AISI 304 (EN 1.4301) + PPS	AISI 316 (EN 1.4401) + PPS		
111	Mechanical Seal	SiC/Carbon/FPM			
111-3	Mechanical seal seat	AISI 304 (EN 1.4301)	AISI 316 (EN 1.4401)		
111-4	Seal holder	AISI 304 (EN 1.4301)			
111-5	Mechanical seal cartridge	AISI 304 (EN 1.4301)	AISI 316 (EN 1.4401)		
115-1	O-Ring (outer casing)	FPM		D. 129.54x5.34	OR 6510
115-3	O-Ring	FPM			
115-4	O-Ring (cartridge sleeve)	FPM		D. 11.91x2.62	OR 115
115-5	O-Ring (seal cover)	FPM		D. 32.99x2.62	OR 3131
120-1	Tie-rod	Galvanized steel 6.8 strength class ISO 898/1		M10	
120-3	Screw	A2-70 UNI 7323		M4x10	ISO 4762
120-6	Screw for coupling	Galvanized steel		M6x25	ISO 4762
120-11	Screw for counterflange	A2-70 UNI 7323			
128-1	Nut for tie rod	Galvanized steel		M10	UNI 5588
128-5	Nut for tie rod	A2-70 UNI 7323		M10	UNI 7474
128-6	Nut for coupling	Galvanized steel		M6	ISO 4032
130-1	Set screw	A2-70 UNI 7323		M5x8	UNI 5923
130-2	Screw for coupling guard	A2-70 UNI 7323		M5x6	UNI 7687
131-1	Pin for shaft	Carbon Steel		D. 4x32	UNI 4838
135-1	Washer	Galvanized steel		D. 10.5x21x2	UNI 6592
135-6	Washer	Carbon Steel		Ø6	
137-1	Impeller spacer	AISI 304 (EN 1.4301)	AISI 316 (EN 1.4401)		
140	Coupling	up to 5 HP Die cast Aluminium EN AB-AISI11Cu2 (Fe)			
160	Base	Die cast Aluminium EN AB-AISI11Cu2 (Fe)			
162	Motor bracket	Cast iron EN-GJL-200-EN 1561			
212	Plug	AISI 304 (EN 1.4301)	AISI 316 (EN 1.4401)	G 3/8 (BSPP)	
212-1	Plug	AISI 304 (EN 1.4301)	AISI 316 (EN 1.4401)	G 3/8 (BSPP)	
212-2	Venting plug	AISI 316L (EN 1.4404)			
219	Counter flange	AISI 304 (EN 1.4301)	AISI 316 (EN 1.4401)		
245	Coupling guard	AISI 304 (EN 1.4301)			
273-1	Plug Washer	AISI 304 (EN 1.4301)	AISI 316 (EN 1.4401)		
615	Flange	Nodular Cast Iron			



**PART QUANTITY FOR MODEL**  
**EVMSU(L)1**

Pump Type	N°																															
	4	5-1	5-2	5-3	5-4	6	7	21	31	32-1	43-2	43-3	43-5	43-7	44-1	45**	46	47	48	52-1	75	75-1	107	111	111-3	111-4	111-5	115-1	115-3*	115-4	115-5	
EVMSU(L)1 2	1	1	/	1	1	1	1	2	1	1	/	1	/	/	1	4	2	1	1	1	1	2	2	1	1	1	1	2	2	1	1	1
EVMSU(L)1 3	1	1	1	1	1	1	1	3	1	1	3	1	/	/	1	4	2	1	1	1	1	2	3	1	1	1	1	2	2	2	1	1
EVMSU(L)1 4	1	1	2	1	1	1	1	4	1	1	5	1	/	/	1	4	2	1	1	1	1	2	4	1	1	1	1	2	2	2	1	1
EVMSU(L)1 5	1	1	3	1	1	1	1	5	1	1	7	1	1	/	1	4	2	1	1	1	1	2	5	1	1	1	1	2	2	2	1	1
EVMSU(L)1 6	1	1	4	1	1	1	1	6	1	1	9	1	/	/	1	4	2	1	1	1	1	2	6	1	1	1	1	2	2	2	1	1
EVMSU(L)1 7	1	1	5	1	1	1	1	7	1	1	11	1	/	/	1	4	2	1	1	1	1	2	7	1	1	1	1	2	2	2	1	1
EVMSU(L)1 8	1	1	6	1	1	1	1	8	1	1	13	1	/	/	1	4	2	1	1	1	1	2	8	1	1	1	1	2	2	2	1	1
EVMSU(L)1 9	1	1	7	1	1	1	1	9	1	1	15	1	1	/	1	4	2	1	1	1	1	2	9	1	1	1	1	2	2	2	1	1
EVMSU(L)1 10	1	1	8	1	1	1	1	10	1	1	17	1	/	/	1	4	2	1	1	1	1	2	10	1	1	1	1	2	2	2	1	1
EVMSU(L)1 11	1	1	9	1	1	1	1	11	1	1	19	1	/	/	1	4	2	1	1	1	1	2	11	1	1	1	1	2	2	2	1	1
EVMSU(L)1 12	1	1	10	1	1	1	1	12	1	1	21	1	/	/	1	4	2	1	1	1	1	2	12	1	1	1	1	2	2	2	1	1
EVMSU(L)1 13	1	1	10	2	1	1	1	13	1	1	20	2	1	1	2	4	2	1	1	2	1	2	13	1	1	1	1	2	2	2	1	1
EVMSU(L)1 14	1	1	11	2	1	1	1	14	1	1	22	2	/	1	2	4	2	1	1	2	1	2	14	1	1	1	1	2	2	2	1	1
EVMSU(L)1 16	1	1	13	2	1	1	1	16	1	1	26	2	/	1	2	4	2	1	1	2	1	2	16	1	1	1	1	2	2	2	1	1
EVMSU(L)1 18	1	1	15	2	1	1	1	18	1	1	30	2	/	1	2	4	2	1	1	2	1	2	18	1	1	1	1	2	2	2	1	1
EVMSU(L)1 20	1	1	17	2	1	1	1	20	1	1	34	2	/	1	2	4	2	1	1	2	1	2	20	1	1	1	1	2	/	1	1	
EVMSU(L)1 22	1	1	19	2	1	1	1	22	1	1	38	2	/	1	2	4	2	1	1	2	1	2	22	1	1	1	1	2	/	1	1	
EVMSU(L)1 24	1	1	21	2	1	1	1	24	1	1	42	2	/	1	2	4	2	1	1	2	1	2	24	1	1	1	1	2	/	1	1	
EVMSU(L)1 26	1	1	23	2	1	1	1	26	1	1	46	2	/	1	2	4	2	1	1	2	1	2	26	1	1	1	1	2	/	1	1	
EVMSU(L)1 27	1	1	24	2	1	1	1	27	1	1	48	2	/	1	2	4	2	1	1	2	1	2	27	1	1	1	1	2	/	1	1	
EVMSU(L)1 29	1	1	26	2	1	1	1	29	1	1	52	2	/	1	2	4	2	1	1	2	1	2	29	1	1	1	1	2	/	1	1	

Pump Type	N°																						
	120-1	120-3	120-6	120-11*	128-1	128-5	128-6	130-1	130-2	131-1	135-1	135-6	137-1	140	160	162	212	212-1	212-2	219*	245	273-1	615**
EVMSU(L)1 2	4	4	4	4	4	4	4	3	4	1	4	4	1	2	1	1	1	2	1	2	2	2	2
EVMSU(L)1 3	4	4	4	4	4	4	4	3	4	1	4	4	1	2	1	1	1	2	1	2	2	2	2
EVMSU(L)1 4	4	4	4	4	4	4	4	3	4	1	4	4	1	2	1	1	1	2	1	2	2	2	2
EVMSU(L)1 5	4	4	4	4	4	4	4	3	4	1	4	4	1	2	1	1	1	2	1	2	2	2	2
EVMSU(L)1 6	4	4	4	4	4	4	4	3	4	1	4	4	1	2	1	1	1	2	1	2	2	2	2
EVMSU(L)1 7	4	4	4	4	4	4	4	3	4	1	4	4	1	2	1	1	1	2	1	2	2	2	2
EVMSU(L)1 8	4	4	4	4	4	4	4	3	4	1	4	4	1	2	1	1	1	2	1	2	2	2	2
EVMSU(L)1 9	4	4	4	4	4	4	4	3	4	1	4	4	1	2	1	1	1	2	1	2	2	2	2
EVMSU(L)1 10	4	4	4	4	4	4	4	3	4	1	4	4	1	2	1	1	1	2	1	2	2	2	2
EVMSU(L)1 11	4	4	4	4	4	4	4	3	4	1	4	4	1	2	1	1	1	2	1	2	2	2	2
EVMSU(L)1 12	4	4	4	4	4	4	4	3	4	1	4	4	1	2	1	1	1	2	1	2	2	2	2
EVMSU(L)1 13	4	4	4	4	4	4	4	3	4	1	4	4	1	2	1	1	1	2	1	2	2	2	2
EVMSU(L)1 14	4	4	4	4	4	4	4	3	4	1	4	4	1	2	1	1	1	2	1	2	2	2	2
EVMSU(L)1 16	4	4	4	4	4	4	4	3	4	1	4	4	1	2	1	1	1	2	1	2	2	2	2
EVMSU(L)1 18	4	4	4	4	4	4	4	3	4	1	4	4	1	2	1	1	1	2	1	2	2	2	2
EVMSU(L)1 20	4	4	4	/	4	4	4	3	4	1	4	4	1	2	1	1	1	2	1	/	2	2	2
EVMSU(L)1 22	4	4	4	/	4	4	4	3	4	1	4	4	1	2	1	1	1	2	1	/	2	2	2
EVMSU(L)1 24	4	4	4	/	4	4	4	3	4	1	4	4	1	2	1	1	1	2	1	/	2	2	2
EVMSU(L)1 26	4	4	4	/	4	4	4	3	4	1	4	4	1	2	1	1	1	2	1	/	2	2	2
EVMSU(L)1 27	4	4	4	/	4	4	4	3	4	1	4	4	1	2	1	1	1	2	1	/	2	2	2
EVMSU(L)1 29	4	4	4	/	4	4	4	3	4	1	4	4	1	2	1	1	1	2	1	/	2	2	2

\* only for Oval flange (N)  
\*\* only for Loose round flange (L)

**SECTIONAL VIEW**  
**EVMSU(L)3**

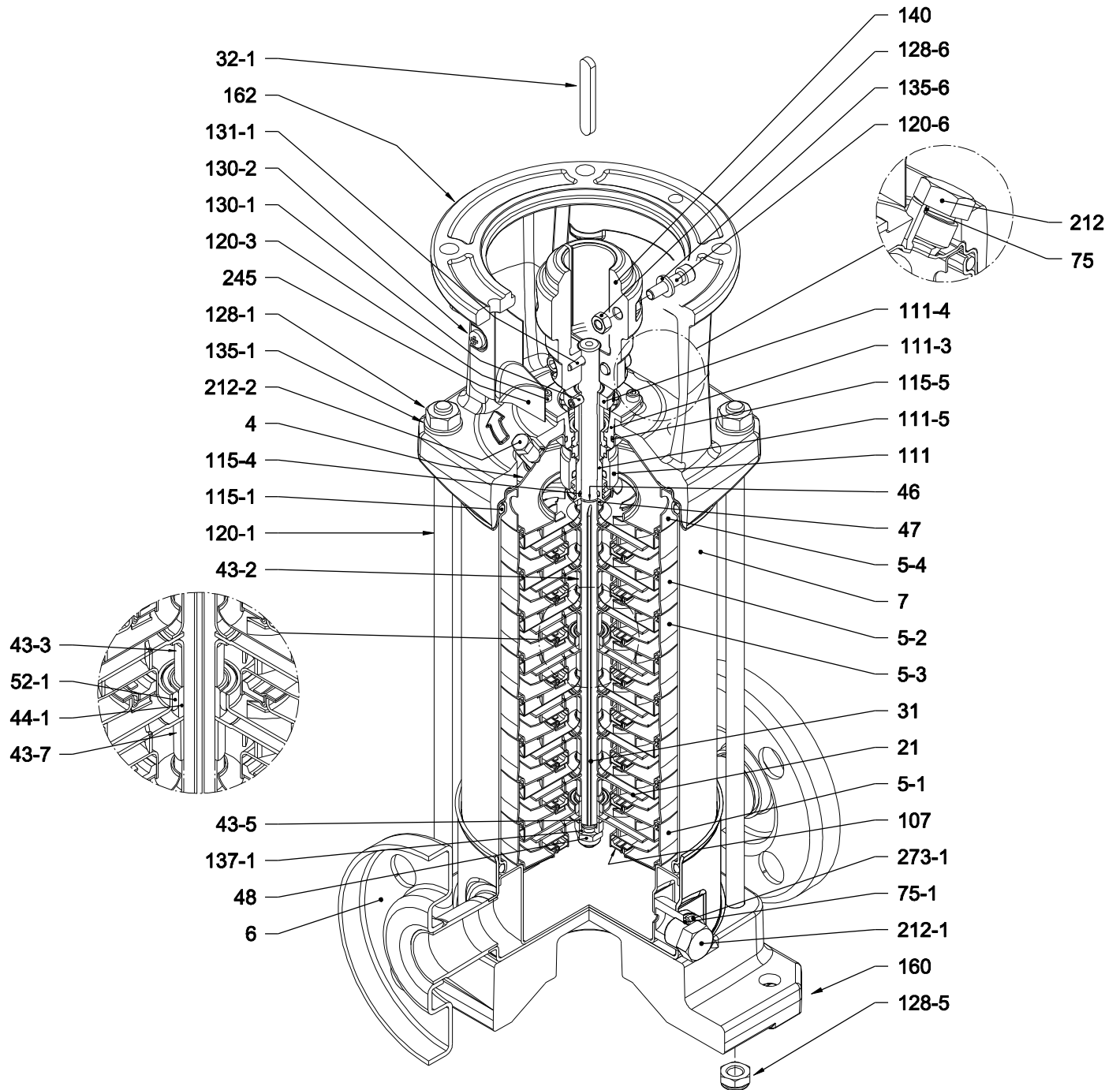

with Round (ANSI Compatible) flange (F)

**PIPE CONNECTION**

**EVMSU(L)3**

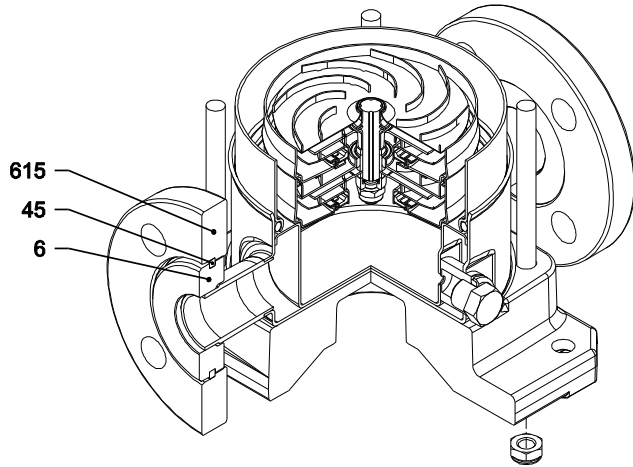

with Loose round ANSI compatible flange (L)

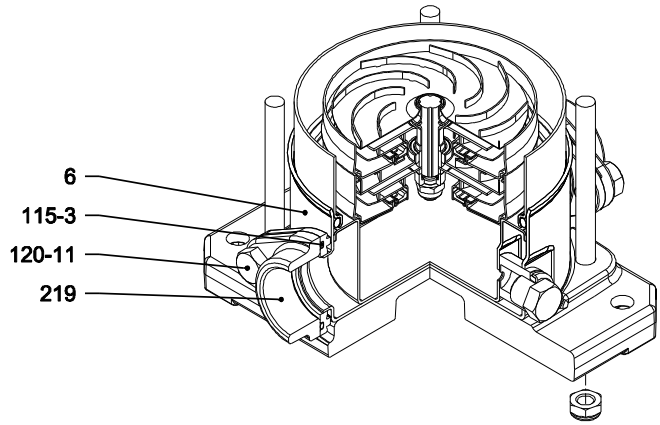

with Oval flange (N)

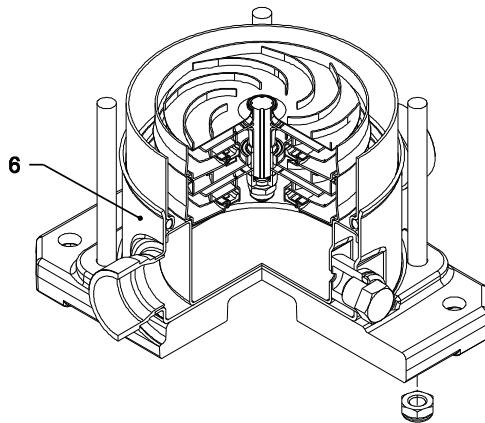

with victaulic connection (V)

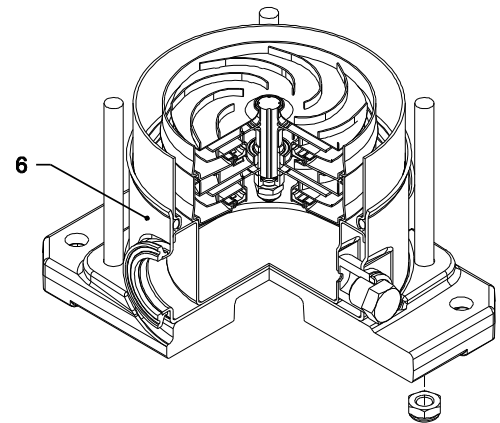

with Clamp connection (C)

**SECTIONAL VIEW PART REFERENCE**
**EVMSU(L)3**

N°	PART NAME	MATERIAL		DIMENSIONS [mm]	STANDARD
		EVMSU	EVMSUL		
4	Casing cover	AISI 304 (EN 1.4301)	AISI 316 (EN 1.4401)		
5-1	Suction casing	AISI 304 (EN 1.4301)	AISI 316 (EN 1.4401)		
5-2	Intermediate Casing	AISI 304 (EN 1.4301)	AISI 316 (EN 1.4401)		
5-3	Intermediate casing bearing	AISI 304 (EN 1.4301)	AISI 316 (EN 1.4401)		
5-4	Discharge casing	AISI 304 (EN 1.4301)	AISI 316 (EN 1.4401)		
6	Bottom casing	AISI 304 (EN 1.4301)	AISI 316 (EN 1.4401)		
7	Outer casing	AISI 304 (EN 1.4301)	AISI 316L (EN 1.4404)		
21	Impeller	AISI 304 (EN 1.4301)	AISI 316 (EN 1.4401)		
31	Shaft	AISI 304 (EN 1.4301)	AISI 316L (EN 1.4404)		
32-1	Adjuster Key	AISI 304 (EN 1.4301)			
43-2	Shaft sleeve (intermediate)	AISI 304 (EN 1.4301)	AISI 316L (EN 1.4404)		
43-3	Shaft sleeve (bearing)	AISI 304 (EN 1.4301)	AISI 316 (EN 1.4401)		
43-5	Shaft sleeve (last stage)	AISI 304 (EN 1.4301)	AISI 316 (EN 1.4401)		
43-7	Spacer	AISI 304 (EN 1.4301)		12x10	
44-1	Shaft sleeve bearing	Tungsten carbide			
45	Flange holder	AISI 304 (EN 1.4301)			
46	Ring (mechanical seal)	AISI 316L (EN 1.4404)			
47	Ring Holder	AISI 304 (EN 1.4301)	AISI 316 (EN 1.4401)		
48	Impeller nut	A2-70 UNI 7323 with inox insert	A4-70 UNI 7323 with inox insert	M8	
52-1	Bearing	Tungsten carbide			
75	O-Ring (plug)	FPM		D. 12.37x2.62	OR 3050
75-1	O-Ring (plug)	FPM			
107	Liner ring	AISI 304 (EN 1.4301) + PPS	AISI 316 (EN 1.4401) + PPS		
111	Mechanical Seal	SiC/Carbon/FPM			
111-3	Mechanical seal seat	AISI 304 (EN 1.4301)	AISI 316 (EN 1.4401)		
111-4	Seal holder	AISI 304 (EN 1.4301)			
111-5	Mechanical seal cartridge	AISI 304 (EN 1.4301)	AISI 316 (EN 1.4401)		
115-1	O-Ring (outer casing)	FPM		D. 129.54x5.34	OR 6510
115-3	O-Ring	FPM			
115-4	O-Ring (cartridge sleeve)	FPM		D. 11.91x2.62	OR 115
115-5	O-Ring (seal cover)	FPM		D. 32.99x2.62	OR 3131
120-1	Tie-rod	Galvanized steel 6.8 strength class ISO 898/1		M10	
120-3	Screw	A2-70 UNI 7323		M4x10	ISO 4762
120-6	Screw for coupling	Galvanized steel		M6x25	ISO 4762
120-11	Screw for counterflange	A2-70 UNI 7323			
128-1	Nut for tie rod	Galvanized steel		M10	UNI 5588
128-5	Nut for tie rod	A2-70 UNI 7323		M10	UNI 7474
128-6	Nut for coupling	Galvanized steel		M6	ISO 4032
130-1	Set screw	A2-70 UNI 7323		M5x8	UNI 5923
130-2	Screw for coupling guard	A2-70 UNI 7323		M5x6	UNI 7687
131-1	Pin for shaft	Carbon Steel		D. 4x32	UNI 4838
135-1	Washer	Galvanized steel		D. 10.5x21x2	UNI 6592
135-6	Washer	Carbon Steel		Ø6	
137-1	Impeller spacer	AISI 304 (EN 1.4301)	AISI 316 (EN 1.4401)		
140	Coupling	up to 5 HP Die cast Aluminium EN AB-AISI11Cu2 (Fe)			
160	Base	Die cast Aluminium EN AB-AISI11Cu2 (Fe)			
162	Motor bracket	Cast iron EN-GJL-200-EN 1561			
212	Plug	AISI 304 (EN 1.4301)	AISI 316 (EN 1.4401)	G 3/8 (BSPP)	
212-1	Plug	AISI 304 (EN 1.4301)	AISI 316 (EN 1.4401)	G 3/8 (BSPP)	
212-2	Venting plug	AISI 316L (EN 1.4404)			
219	Counter flange	AISI 304 (EN 1.4301)	AISI 316 (EN 1.4401)		
245	Coupling guard	AISI 304 (EN 1.4301)			
273-1	Plug Washer	AISI 304 (EN 1.4301)	AISI 316 (EN 1.4401)		
615	Flange	Nodular Cast Iron			

**PART QUANTITY FOR MODEL**  
**EVMSU(L)3**

Pump Type	N°																														
	4	5-1	5-2	5-3	5-4	6	7	21	31	32-1	43-2	43-3	43-5	43-7	44-1	45**	46	47	48	52-1	75	75-1	107	111	111-3	111-4	111-5	115-1	115-3*	115-4	115-5
EVMSU(L)3 2	1	1	/	1	1	1	1	2	1	1	/	1	/	1	1	4	2	1	1	1	1	4	2	1	1	1	1	2	2	1	1
EVMSU(L)3 3	1	1	1	1	1	1	1	3	1	1	3	1	/	1	1	4	2	1	1	1	1	4	3	1	1	1	1	2	2	1	1
EVMSU(L)3 4	1	1	2	1	1	1	1	4	1	1	5	1	/	1	1	4	2	1	1	1	1	4	4	1	1	1	1	2	2	1	1
EVMSU(L)3 5	1	1	3	1	1	1	1	5	1	1	7	1	1	1	1	4	2	1	1	1	1	4	5	1	1	1	1	2	2	1	1
EVMSU(L)3 6	1	1	4	1	1	1	1	6	1	1	9	1	/	1	1	4	2	1	1	1	1	4	6	1	1	1	1	2	2	1	1
EVMSU(L)3 7	1	1	5	1	1	1	1	7	1	1	11	1	/	1	1	4	2	1	1	1	1	4	7	1	1	1	1	2	2	1	1
EVMSU(L)3 8	1	1	6	1	1	1	1	8	1	1	13	1	/	1	1	4	2	1	1	1	1	4	8	1	1	1	1	2	2	1	1
EVMSU(L)3 9	1	1	7	1	1	1	1	9	1	1	15	1	1	1	1	4	2	1	1	1	1	4	9	1	1	1	1	2	2	1	1
EVMSU(L)3 10	1	1	8	1	1	1	1	10	1	1	17	1	/	1	1	4	2	1	1	1	1	4	10	1	1	1	1	2	2	1	1
EVMSU(L)3 11	1	1	9	1	1	1	1	11	1	1	19	1	/	1	1	4	2	1	1	1	1	4	11	1	1	1	1	2	2	1	1
EVMSU(L)3 12	1	1	10	1	1	1	1	12	1	1	21	1	/	1	1	4	2	1	1	1	1	4	12	1	1	1	1	2	2	1	1
EVMSU(L)3 13	1	1	10	2	1	1	1	13	1	1	21	1	1	1	2	4	2	1	1	2	1	4	13	1	1	1	1	2	2	1	1
EVMSU(L)3 14	1	1	11	2	1	1	1	14	1	1	23	1	/	1	2	4	2	1	1	2	1	4	14	1	1	1	1	2	2	1	1
EVMSU(L)3 15	1	1	12	2	1	1	1	15	1	1	25	1	/	1	2	4	2	1	1	2	1	4	15	1	1	1	1	2	2	1	1
EVMSU(L)3 16	1	1	13	2	1	1	1	16	1	1	27	1	/	1	2	4	2	1	1	2	1	4	16	1	1	1	1	2	/	1	1
EVMSU(L)3 17	1	1	14	2	1	1	1	17	1	1	29	1	1	1	2	4	2	1	1	2	1	4	17	1	1	1	1	2	/	1	1
EVMSU(L)3 19	1	1	16	2	1	1	1	19	1	1	33	1	/	1	2	4	2	1	1	2	1	4	19	1	1	1	1	2	/	1	1
EVMSU(L)3 20	1	1	17	2	1	1	1	20	1	1	35	1	/	1	2	4	2	1	1	2	1	4	20	1	1	1	1	2	/	1	1
EVMSU(L)3 21	1	1	18	2	1	1	1	21	1	1	37	1	1	1	2	4	2	1	1	2	1	4	21	1	1	1	1	2	/	1	1
EVMSU(L)3 22	1	1	19	2	1	1	1	22	1	1	39	1	/	1	2	4	2	1	1	2	1	4	22	1	1	1	1	2	/	1	1
EVMSU(L)3 23	1	1	20	2	1	1	1	23	1	1	41	1	/	1	2	4	2	1	1	2	1	4	23	1	1	1	1	2	/	1	1

Pump Type	N°																						
	120-1	120-3	120-6	120-11*	128-1	128-5	128-6	130-1	130-2	131-1	135-1	135-6	137-1	140	160	162	212	212-1	212-2	219*	245	273-1	615**
EVMSU(L)3 2	4	4	4	4	4	4	4	3	4	1	4	4	1	2	1	1	1	2	1	2	2	2	2
EVMSU(L)3 3	4	4	4	4	4	4	4	3	4	1	4	4	1	2	1	1	1	2	1	2	2	2	2
EVMSU(L)3 4	4	4	4	4	4	4	4	3	4	1	4	4	1	2	1	1	1	2	1	2	2	2	2
EVMSU(L)3 5	4	4	4	4	4	4	4	3	4	1	4	4	1	2	1	1	1	2	1	2	2	2	2
EVMSU(L)3 6	4	4	4	4	4	4	4	3	4	1	4	4	1	2	1	1	1	2	1	2	2	2	2
EVMSU(L)3 7	4	4	4	4	4	4	4	3	4	1	4	4	1	2	1	1	1	2	1	2	2	2	2
EVMSU(L)3 8	4	4	4	4	4	4	4	3	4	1	4	4	1	2	1	1	1	2	1	2	2	2	2
EVMSU(L)3 9	4	4	4	4	4	4	4	3	4	1	4	4	1	2	1	1	1	2	1	2	2	2	2
EVMSU(L)3 10	4	4	4	4	4	4	4	3	4	1	4	4	1	2	1	1	1	2	1	2	2	2	2
EVMSU(L)3 11	4	4	4	4	4	4	4	3	4	1	4	4	1	2	1	1	1	2	1	2	2	2	2
EVMSU(L)3 12	4	4	4	4	4	4	4	3	4	1	4	4	1	2	1	1	1	2	1	2	2	2	2
EVMSU(L)3 13	4	4	4	4	4	4	4	3	4	1	4	4	1	2	1	1	1	2	1	2	2	2	2
EVMSU(L)3 14	4	4	4	4	4	4	4	3	4	1	4	4	1	2	1	1	1	2	1	2	2	2	2
EVMSU(L)3 15	4	4	4	4	4	4	4	3	4	1	4	4	1	2	1	1	1	2	1	2	2	2	2
EVMSU(L)3 16	4	4	4	/	4	4	4	3	4	1	4	4	1	2	1	1	1	2	1	/	2	2	2
EVMSU(L)3 17	4	4	4	/	4	4	4	3	4	1	4	4	1	2	1	1	1	2	1	/	2	2	2
EVMSU(L)3 19	4	4	4	/	4	4	4	3	4	1	4	4	1	2	1	1	1	2	1	/	2	2	2
EVMSU(L)3 20	4	4	4	/	4	4	4	3	4	1	4	4	1	2	1	1	1	2	1	/	2	2	2
EVMSU(L)3 21	4	4	4	/	4	4	4	3	4	1	4	4	1	2	1	1	1	2	1	/	2	2	2
EVMSU(L)3 22	4	4	4	/	4	4	4	3	4	1	4	4	1	2	1	1	1	2	1	/	2	2	2
EVMSU(L)3 23	4	4	4	/	4	4	4	3	4	1	4	4	1	2	1	1	1	2	1	/	2	2	2

\* only for Oval flange (N)

\*\* only for Loose round flange (L)



**SECTIONAL VIEW**  
**EVMSU(L)5**

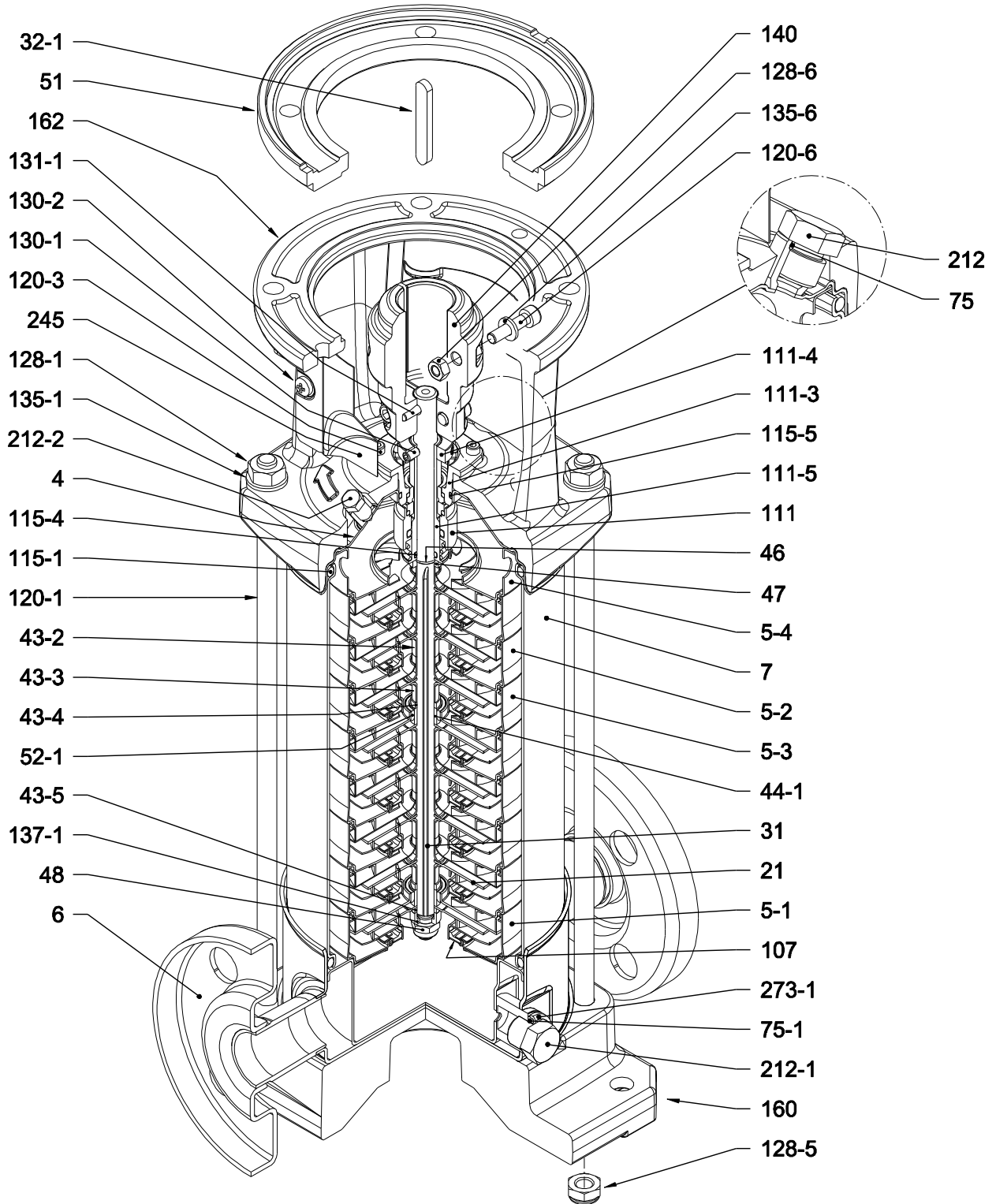

with Round (ANSI Compatible) flange (F)

**PIPE CONNECTION**  
**EVMSU(L)5**

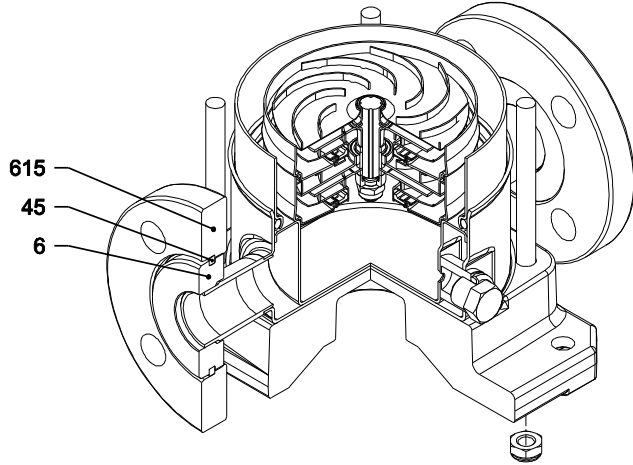

with Loose round ANSI compatible flange (L)

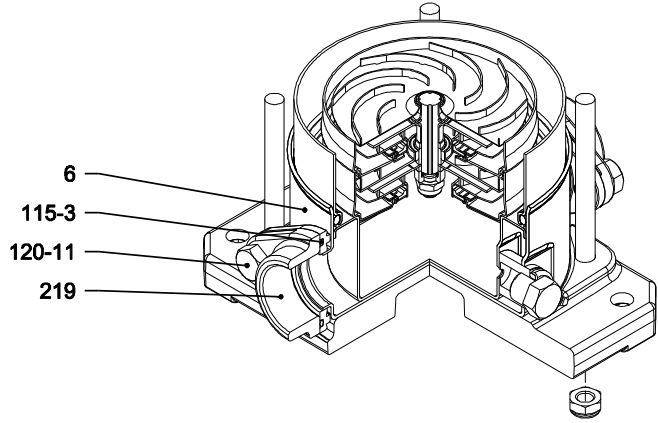

with Oval flange (N)

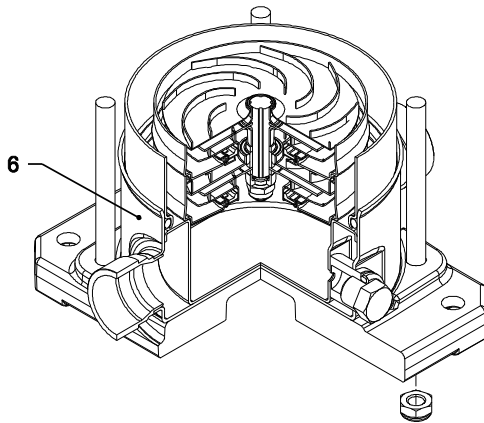

with victaulic connection (V)

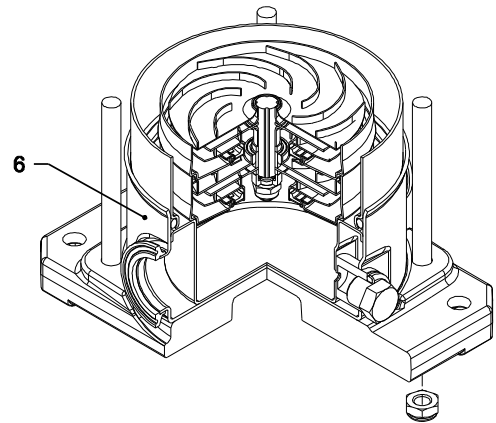

with Clamp connection (C)

**SECTIONAL VIEW PART REFERENCE**
**EVMSU(L)5**

N°	PART NAME	MATERIAL		DIMENSIONS [mm]	STANDARD
		EVMSU	EVMSUL		
4	Casing cover	AISI 304 (EN 1.4301)	AISI 316 (EN 1.4401)		
5-1	Suction casing	AISI 304 (EN 1.4301)	AISI 316 (EN 1.4401)		
5-2	Intermediate Casing	AISI 304 (EN 1.4301)	AISI 316 (EN 1.4401)		
5-3	Intermediate casing bearing	AISI 304 (EN 1.4301)	AISI 316 (EN 1.4401)		
5-4	Discharge casing	AISI 304 (EN 1.4301)	AISI 316 (EN 1.4401)		
6	Bottom casing	AISI 304 (EN 1.4301)	AISI 316 (EN 1.4401)		
7	Outer casing	AISI 304 (EN 1.4301)	AISI 316L (EN 1.4404)		
21	Impeller	AISI 304 (EN 1.4301)	AISI 316 (EN 1.4401)		
31	Shaft	AISI 304 (EN 1.4301) - AISI 329A (EN 1.4462)	AISI 316L (EN 1.4404) - AISI 329A (EN 1.4462)		
32-1	Adjuster Key	AISI 304 (EN 1.4301)			
43-2	Shaft sleeve (intermediate)	AISI 304 (EN 1.4301)	AISI 316L (EN 1.4404)		
43-3	Shaft sleeve (bearing)	AISI 304 (EN 1.4301)	AISI 316 (EN 1.4401)		
43-4	Shaft sleeve (adjustment)	AISI 316L (EN 1.4404)			
43-5	Shaft sleeve (last stage)	AISI 304 (EN 1.4301)	AISI 316 (EN 1.4401)		
44-1	Shaft sleeve bearing	Tungsten carbide			
45	Flange holder	AISI 304 (EN 1.4301)			
46	Ring (mechanical seal)	AISI 316L (EN 1.4404)			
47	Ring Holder	AISI 304 (EN 1.4301)	AISI 316 (EN 1.4401)		
48	Impeller nut	A2-70 UNI 7323 with inox insert	A4-70 UNI 7323 with inox insert	M8	
51	Motor adapter	Cast iron EN-GJL-200-EN 1561			
52-1	Bearing	Tungsten carbide			
75	O-Ring (plug)	FPM		D. 12.37x2.62	OR 3050
75-1	O-Ring (plug)	FPM			
107	Liner ring	AISI 304 (EN 1.4301) + PPS	AISI 316 (EN 1.4401) + PPS		
111	Mechanical Seal	SiC/Carbon/FPM			
111-3	Mechanical seal seat	AISI 304 (EN 1.4301)	AISI 316 (EN 1.4401)		
111-4	Seal holder	AISI 304 (EN 1.4301)			
111-5	Mechanical seal cartridge	AISI 304 (EN 1.4301)	AISI 316 (EN 1.4401)		
115-1	O-Ring (outer casing)	FPM		D. 129.54x5.34	OR 6510
115-3	O-Ring	FPM			
115-4	O-Ring (cartridge sleeve)	FPM		D. 11.91x2.62	OR 115
115-5	O-Ring (seal cover)	FPM		D. 32.99x2.62	OR 3131
120-1	Tie-rod	Galvanized steel 6.8 strength class ISO 898/1		M10	
120-3	Screw	A2-70 UNI 7323		M4x10	ISO 4762
120-6	Screw for coupling	Galvanized steel		M6x25	ISO 4762
	up to 5 HP above 7.5 HP			M8x20	ISO 4762
120-11	Screw for counterflange	A2-70 UNI 7323			
128-1	Nut for tie rod	Galvanized steel		M10	UNI 5588
128-5	Nut for tie rod	A2-70 UNI 7323		M10	UNI 7474
128-6	Nut for coupling	Galvanized steel		M6	ISO 4032
130-1	Set screw	A2-70 UNI 7323		M5x8	UNI 5923
130-2	Screw for coupling guard	A2-70 UNI 7323		M5x6	UNI 7687
131-1	Pin for shaft	Carbon Steel		D. 4x32	UNI 4838
135-1	Washer	Galvanized steel		D. 10.5x21x2	UNI 6592
135-6	Washer	Carbon Steel		Ø6	
137-1	Impeller spacer	AISI 304 (EN 1.4301)	AISI 316 (EN 1.4401)		
140	Coupling	Die cast Aluminium EN AB-AISI11Cu2 (Fe)			
160	Base	Cast Iron			
162	Motor bracket	Die cast Aluminium EN AB-AISI11Cu2 (Fe)			
212	Plug	Cast iron EN-GJL-200-EN 1561			
212	Plug	AISI 304 (EN 1.4301)	AISI 316 (EN 1.4401)	G 3/8 (BSPP)	
212-1	Plug	AISI 304 (EN 1.4301)	AISI 316 (EN 1.4401)	G 3/8 (BSPP)	
212-2	Venting plug	AISI 316L (EN 1.4404)			
219	Counter flange	AISI 304 (EN 1.4301)	AISI 316 (EN 1.4401)		
245	Coupling guard	AISI 304 (EN 1.4301)			
273-1	Plug Washer	AISI 304 (EN 1.4301)	AISI 316 (EN 1.4401)		
615	Flange	Nodular Cast Iron			

**PART QUANTITY FOR MODEL  
EVMSU(L)5**

Pump Type	N°																																	
	4	5-1	5-2	5-3	5-4	6	7	21	31***	32-1	43-2	43-3	43-4	43-5	44-1	45**	46	47	48	51	52-1	75	75-1	107	111	111-3	111-4	111-5	115-1	115-3*	115-4	115-5		
EVMSU(L)5 2	1	1	/	1	1	1	1	2	1	1	1	1	1	/	1	4	2	1	1	/	1	1	2	2	1	1	1	1	1	2	2	1	1	
EVMSU(L)5 3	1	1	1	1	1	1	1	3	1	1	3	1	1	1	1	4	2	1	1	/	1	1	2	3	1	1	1	1	1	2	2	1	1	
EVMSU(L)5 4	1	1	2	1	1	1	1	4	1	1	5	1	1	1	/	1	4	2	1	1	/	1	1	2	4	1	1	1	1	2	2	1	1	
EVMSU(L)5 5	1	1	3	1	1	1	1	5	1	1	7	1	1	1	/	1	4	2	1	1	/	1	1	2	5	1	1	1	1	1	2	2	1	1
EVMSU(L)5 6	1	1	4	1	1	1	1	6	1	1	9	1	1	1	1	4	2	1	1	/	1	1	2	6	1	1	1	1	1	2	2	1	1	
EVMSU(L)5 7	1	1	5	1	1	1	1	7	1	1	11	1	1	1	/	1	4	2	1	1	/	1	1	2	7	1	1	1	1	2	2	1	1	
EVMSU(L)5 8	1	1	6	1	1	1	1	8	1	1	13	1	1	1	/	1	4	2	1	1	/	1	1	2	8	1	1	1	1	2	2	1	1	
EVMSU(L)5 9	1	1	7	1	1	1	1	9	1	1	15	1	1	1	1	4	2	1	1	/	1	1	2	9	1	1	1	1	1	2	2	1	1	
EVMSU(L)5 10	1	1	8	1	1	1	1	10	1	1	17	1	1	1	/	1	4	2	1	1	/	1	1	2	10	1	1	1	1	1	2	2	1	1
EVMSU(L)5 11	1	1	8	2	1	1	1	11	1	1	17	2	2	/	2	4	2	1	1	/	2	1	2	11	1	1	1	1	1	2	2	1	1	
EVMSU(L)5 12	1	1	9	2	1	1	1	12	1	1	19	2	2	1	2	4	2	1	1	1	2	1	2	12	1	1	1	1	1	2	2	1	1	
EVMSU(L)5 13	1	1	10	2	1	1	1	13	1	1	21	2	2	/	2	4	2	1	1	1	2	1	2	13	1	1	1	1	1	2	/	1	1	
EVMSU(L)5 14	1	1	11	2	1	1	1	14	1	1	23	2	2	/	2	4	2	1	1	1	2	1	2	14	1	1	1	1	1	2	/	1	1	
EVMSU(L)5 15	1	1	12	2	1	1	1	15	1	1	25	2	2	1	2	4	2	1	1	1	2	1	2	15	1	1	1	1	1	2	/	1	1	
EVMSU(L)5 16	1	1	13	2	1	1	1	16	1	1	27	2	2	/	2	4	2	1	1	1	2	1	2	16	1	1	1	1	1	2	/	1	1	
EVMSU(L)5 17	1	1	14	2	1	1	1	17	1	1	29	2	2	/	2	4	2	1	1	1	2	1	2	17	1	1	1	1	1	2	/	1	1	
EVMSU(L)5 19	1	1	16	2	1	1	1	19	1	1	33	2	2	/	2	4	2	1	1	1	2	1	2	19	1	1	1	1	1	2	/	1	1	

Pump Type	N°																						
	120-1	120-3	120-6	120-11*	128-1	128-5	128-6	130-1	130-2	131-1	135-1	135-6	137-1	140	160	162	212	212-1	212-2	219*	245	273-1	615**
EVMSU(L)5 2	4	4	4	4	4	4	4	3	4	1	4	4	1	2	1	1	1	2	1	2	2	2	2
EVMSU(L)5 3	4	4	4	4	4	4	4	3	4	1	4	4	1	2	1	1	1	2	1	2	2	2	2
EVMSU(L)5 4	4	4	4	4	4	4	4	3	4	1	4	4	1	2	1	1	1	2	1	2	2	2	2
EVMSU(L)5 5	4	4	4	4	4	4	4	3	4	1	4	4	1	2	1	1	1	2	1	2	2	2	2
EVMSU(L)5 6	4	4	4	4	4	4	4	3	4	1	4	4	1	2	1	1	1	2	1	2	2	2	2
EVMSU(L)5 7	4	4	4	4	4	4	4	3	4	1	4	4	1	2	1	1	1	2	1	2	2	2	2
EVMSU(L)5 8	4	4	4	4	4	4	4	3	4	1	4	4	1	2	1	1	1	2	1	2	2	2	2
EVMSU(L)5 9	4	4	4	4	4	4	4	3	4	1	4	4	1	2	1	1	1	2	1	2	2	2	2
EVMSU(L)5 10	4	4	4	4	4	4	4	3	4	1	4	4	1	2	1	1	1	2	1	2	2	2	2
EVMSU(L)5 11	4	4	4	4	4	4	4	3	4	1	4	4	1	2	1	1	1	2	1	2	2	2	2
EVMSU(L)5 12	4	4	4	4	4	4	4	3	4	1	4	4	1	2	1	1	1	2	1	2	2	2	2
EVMSU(L)5 13	4	4	4	/	4	4	4	3	4	1	4	4	1	2	1	1	1	2	1	/	2	2	2
EVMSU(L)5 14	4	4	4	/	4	4	4	3	4	1	4	4	1	2	1	1	1	2	1	/	2	2	2
EVMSU(L)5 15	4	4	4	/	4	4	4	3	4	1	4	4	1	2	1	1	1	2	1	/	2	2	2
EVMSU(L)5 16	4	4	4	/	4	4	4	3	4	1	4	4	1	2	1	1	1	2	1	/	2	2	2
EVMSU(L)5 17	4	4	4	/	4	4	4	3	4	1	4	4	1	2	1	1	1	2	1	/	2	2	2
EVMSU(L)5 19	4	4	4	/	4	4	4	3	4	1	4	4	1	2	1	1	1	2	1	/	2	2	2

\* only for Oval flange (N)

\*\* only for Loose round flange (L)

\*\*\* ■ shaft in AISI 329A (EN 1.4462)

**SECTIONAL VIEW**  
**EVMSU(L)10**

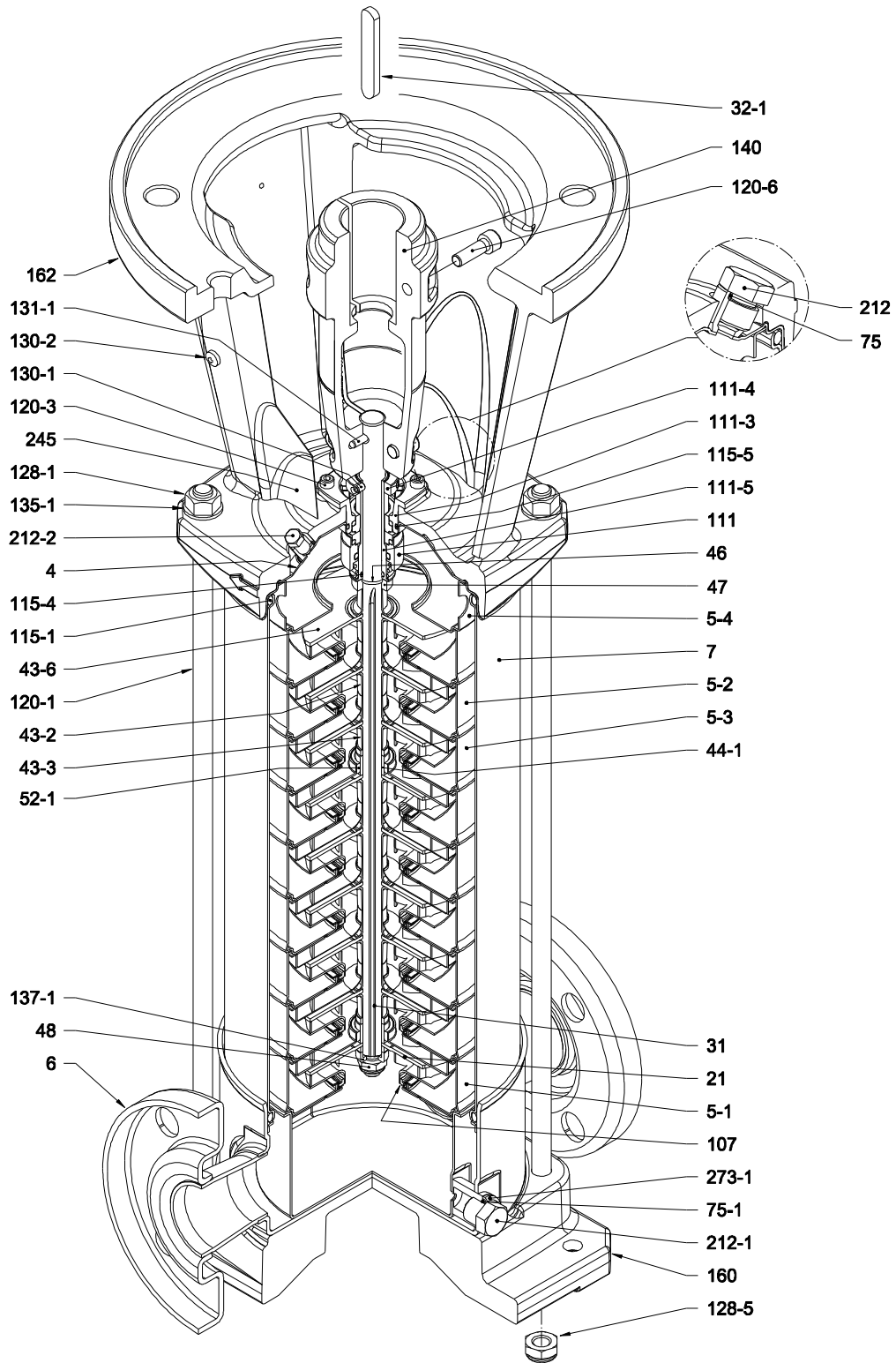

with Round (ANSI Compatible) flange (F)

**PIPE CONNECTION**

**EVMSU(L)10**

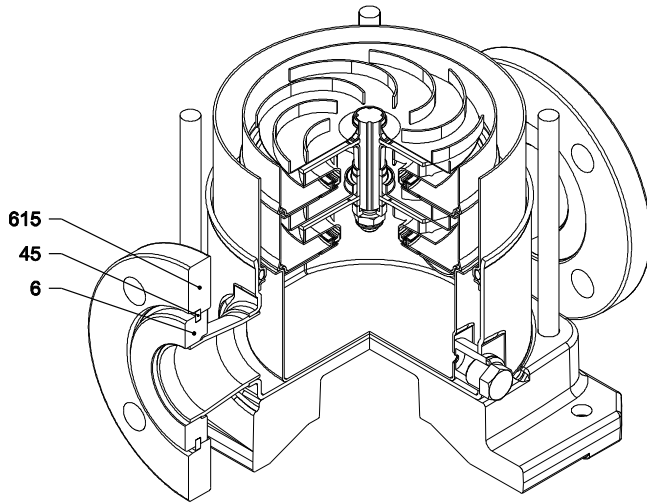

with Loose round ANSI compatible flange (L)

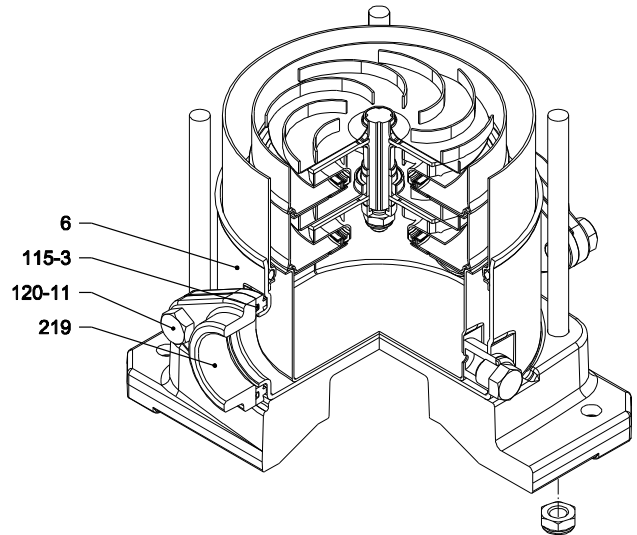

with Oval flange (N)

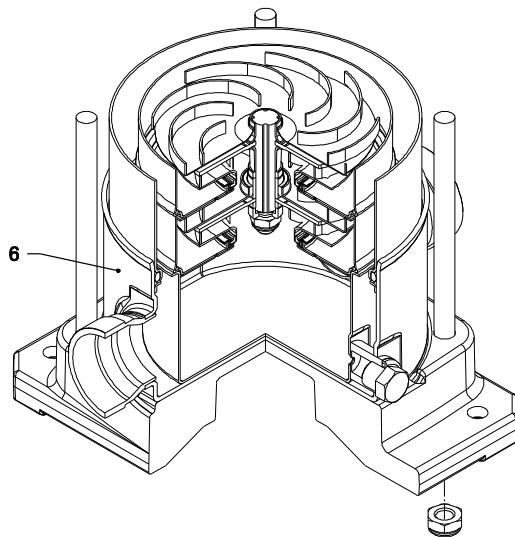

with victaulic connection (V)

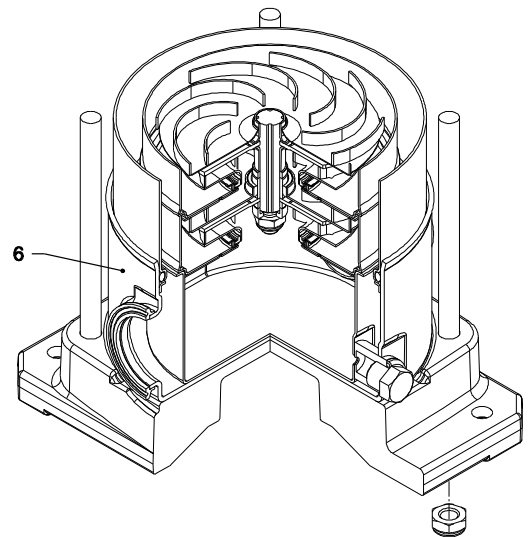

with Clamp connection (C)

**SECTIONAL VIEW PART REFERENCE**
**EVMSU(L)10**

N°	PART NAME	MATERIAL		DIMENSIONS [mm]	STANDARD
		EVMSU	EVMSUL		
4	Casing cover	AISI 304 (EN 1.4301)	AISI 316 (EN 1.4401)		
5-1	Suction casing	AISI 304 (EN 1.4301)	AISI 316 (EN 1.4401)		
5-2	Intermediate Casing	AISI 304 (EN 1.4301)	AISI 316 (EN 1.4401)		
5-3	Intermediate casing bearing	AISI 304 (EN 1.4301)	AISI 316 (EN 1.4401)		
5-4	Discharge casing	AISI 304 (EN 1.4301)	AISI 316 (EN 1.4401)		
6	Bottom casing	AISI 304 (EN 1.4301)	AISI 316 (EN 1.4401)		
7	Outer casing	AISI 304 (EN 1.4301)	AISI 316L (EN 1.4404)		
21	Impeller	AISI 304 (EN 1.4301)	AISI 316 (EN 1.4401)		
31	Shaft	AISI 304 (EN 1.4301)	AISI 316L (EN 1.4404)		
32-1	Adjuster Key	AISI 304 (EN 1.4301)			
43-2	Shaft sleeve (intermediate)	AISI 304 (EN 1.4301)	AISI 316L (EN 1.4404)		
43-3	Shaft sleeve (bearing)	AISI 304 (EN 1.4301)	AISI 316 (EN 1.4401)		
43-6	Washer	AISI 316L (EN 1.4404)		D. 26x1.2	
44-1	Shaft sleeve bearing	Tungsten carbide			
45	Flange holder	AISI 304 (EN 1.4301)			
46	Ring (mechanical seal)	AISI 316L (EN 1.4404)			
47	Ring Holder	AISI 304 (EN 1.4301)	AISI 316 (EN 1.4401)		
48	Impeller nut	A2-70 UNI 7323 with inox insert	A4-70 UNI 7323 with inox insert	M10	
52-1	Bearing	Tungsten carbide			
75	O-Ring (plug)	FPM		D. 12.37x2.62	OR 3050
75-1	O-Ring (plug)	FPM			
107	Liner ring	AISI 304 (EN 1.4301) + PPS	AISI 316 (EN 1.4401) + PPS		
111	Mechanical Seal	SiC/Carbon/FPM			
111-3	Mechanical seal seat	AISI 304 (EN 1.4301)	AISI 316 (EN 1.4401)		
111-4	Seal holder	AISI 304 (EN 1.4301)			
111-5	Mechanical seal cartridge	AISI 304 (EN 1.4301)	AISI 316 (EN 1.4401)		
115-1	O-Ring (outer casing)	FPM		D. 164,46x5,34	OR 6645
115-3	O-Ring	FPM			
115-4	O-Ring (cartridge sleeve)	FPM		D. 15,88x2,62	OR 121
115-5	O-Ring (seal cover)	FPM		D. 37.77x2.62	OR 3150
120-1	Tie-rod	Galvanized steel 6.8 strength class ISO 898/1		M12	
120-3	Screw	A2-70 UNI 7323		M5x12	ISO 4762
120-6	Screw for coupling	up to 5 HP from 7.5 HP to 11 HP above 15 HP	Galvanized steel	M6x25	ISO 4762
				M8x20	ISO 4762
				M10x30	ISO 4762
120-11	Screw for counterflange	A2-70 UNI 7323			
128-1	Nut for tie rod	Galvanized steel		M12	UNI 5588
128-5	Nut for tie rod	Galvanized steel		M12	UNI 7474
130-1	Set screw	A2-70 UNI 7323		M5x8	UNI 5923
130-2	Screw for coupling guard	A2-70 UNI 7323		M5x6	UNI 7687
131-1	Pin for shaft	Carbon Steel		D. 5x35	UNI 4838
135-1	Washer	Galvanized steel		D. 13x24x2,5	UNI 6592
137-1	Impeller spacer	AISI 304 (EN 1.4301)	AISI 316 (EN 1.4401)		
140	Coupling	up to 5 HP above 7.5 HP	Die cast Aluminium EN AB-AISI11Cu2 (Fe)		
			Cast iron		
160	Base	Die cast Aluminium EN AB-AISI11Cu2 (Fe)			
162	Motor bracket	Cast iron EN-GJL-200-EN 1561			
212	Plug	AISI 304 (EN 1.4301)	AISI 316 (EN 1.4401)	G 3/8 (BSPP)	
212-1	Plug	AISI 304 (EN 1.4301)	AISI 316 (EN 1.4401)	G 3/8 (BSPP)	
212-2	Venting plug	AISI 316L (EN 1.4404)			
219	Counter flange	AISI 304 (EN 1.4301)	AISI 316 (EN 1.4401)		
245	Coupling guard	AISI 304 (EN 1.4301)			
273-1	Plug Washer	AISI 304 (EN 1.4301)	AISI 316 (EN 1.4401)		
615	Flange	Nodular Cast Iron			

**PART QUANTITY FOR MODEL**  
**EVMSU(L)10**

Pump Type	N°																														
	4	5-1	5-2	5-3	5-4	6	7	21	31	32-1	43-2	43-3	43-6	44-1	45**	46	47	48	52-1	75	75-1	107	111	111-3	111-4	111-5	115-1	115-3*	115-4	115-5	
EVMSU(L)10 1	1	1	/	1	1	1	1	1	1	1	/	1	1	1	4	2	1	1	1	1	2	1	1	1	1	1	1	2	2	1	1
EVMSU(L)10 2	1	1	/	1	1	1	1	2	1	1	1	1	/	1	4	2	1	1	1	1	2	2	1	1	1	1	1	2	2	1	1
EVMSU(L)10 3	1	1	1	1	1	1	1	3	1	1	3	1	/	1	4	2	1	1	1	1	2	3	1	1	1	1	1	2	2	1	1
EVMSU(L)10 4	1	1	2	1	1	1	1	4	1	1	5	1	/	1	4	2	1	1	1	1	2	4	1	1	1	1	1	2	2	1	1
EVMSU(L)10 5	1	1	3	1	1	1	1	5	1	1	7	1	/	1	4	2	1	1	1	1	2	5	1	1	1	1	1	2	2	1	1
EVMSU(L)10 6	1	1	4	1	1	1	1	6	1	1	9	1	/	1	4	2	1	1	1	1	2	6	1	1	1	1	1	2	2	1	1
EVMSU(L)10 7	1	1	5	1	1	1	1	7	1	1	11	1	/	1	4	2	1	1	1	1	2	7	1	1	1	1	1	2	2	1	1
EVMSU(L)10 8	1	1	5	2	1	1	1	8	1	1	11	2	/	2	4	2	1	1	2	1	2	8	1	1	1	1	1	2	2	1	1
EVMSU(L)10 9	1	1	6	2	1	1	1	9	1	1	13	2	/	2	4	2	1	1	2	1	2	9	1	1	1	1	1	2	2	1	1
EVMSU(L)10 10	1	1	7	2	1	1	1	10	1	1	15	2	/	2	4	2	1	1	2	1	2	10	1	1	1	1	1	2	2	1	1
EVMSU(L)10 11	1	1	8	2	1	1	1	11	1	1	17	2	/	2	4	2	1	1	2	1	2	11	1	1	1	1	1	2	/	1	1
EVMSU(L)10 12	1	1	9	2	1	1	1	12	1	1	19	2	/	2	4	2	1	1	2	1	2	12	1	1	1	1	1	2	/	1	1
EVMSU(L)10 14	1	1	11	2	1	1	1	14	1	1	23	2	/	2	4	2	1	1	2	1	2	14	1	1	1	1	1	2	/	1	1
EVMSU(L)10 15	1	1	12	2	1	1	1	15	1	1	25	2	/	2	4	2	1	1	2	1	2	15	1	1	1	1	1	2	/	1	1
EVMSU(L)10 16	1	1	13	2	1	1	1	16	1	1	27	2	/	2	4	2	1	1	2	1	2	16	1	1	1	1	1	2	/	1	1

Pump Type	N°																				
	120-1	120-3	120-6	120-11*	128-1	128-5	130-1	130-2	131-1	135-1	137-1	140	160	162	212	212-1	212-2	219*	245	273-1	615**
EVMSU(L)10 1	4	4	4	4	4	4	3	4	1	4	1	2	1	1	1	2	1	2	2	2	2
EVMSU(L)10 2	4	4	4	4	4	4	3	4	1	4	1	2	1	1	1	2	1	2	2	2	2
EVMSU(L)10 3	4	4	4	4	4	4	3	4	1	4	1	2	1	1	1	2	1	2	2	2	2
EVMSU(L)10 4	4	4	4	4	4	4	3	4	1	4	1	2	1	1	1	2	1	2	2	2	2
EVMSU(L)10 5	4	4	4	4	4	4	3	4	1	4	1	2	1	1	1	2	1	2	2	2	2
EVMSU(L)10 6	4	4	4	4	4	4	3	4	1	4	1	2	1	1	1	2	1	2	2	2	2
EVMSU(L)10 7	4	4	4	4	4	4	3	4	1	4	1	2	1	1	1	2	1	2	2	2	2
EVMSU(L)10 8	4	4	4	4	4	4	3	4	1	4	1	2	1	1	1	2	1	2	2	2	2
EVMSU(L)10 9	4	4	4	4	4	4	3	4	1	4	1	2	1	1	1	2	1	2	2	2	2
EVMSU(L)10 10	4	4	4	4	4	4	3	4	1	4	1	2	1	1	1	2	1	2	2	2	2
EVMSU(L)10 11	4	4	4	/	4	4	3	4	1	4	1	2	1	1	1	2	1	/	2	2	2
EVMSU(L)10 12	4	4	4	/	4	4	3	4	1	4	1	2	1	1	1	2	1	/	2	2	2
EVMSU(L)10 14	4	4	4	/	4	4	3	4	1	4	1	2	1	1	1	2	1	/	2	2	2
EVMSU(L)10 15	4	4	4	/	4	4	3	4	1	4	1	2	1	1	1	2	1	/	2	2	2
EVMSU(L)10 16	4	4	4	/	4	4	3	4	1	4	1	2	1	1	1	2	1	/	2	2	2

\* only for Oval flange (N)

\*\* only for Loose round flange (L)

128-6 / 135-6 : with Aluminium coupling



**SECTIONAL VIEW**  
**EVMSU(L)15**

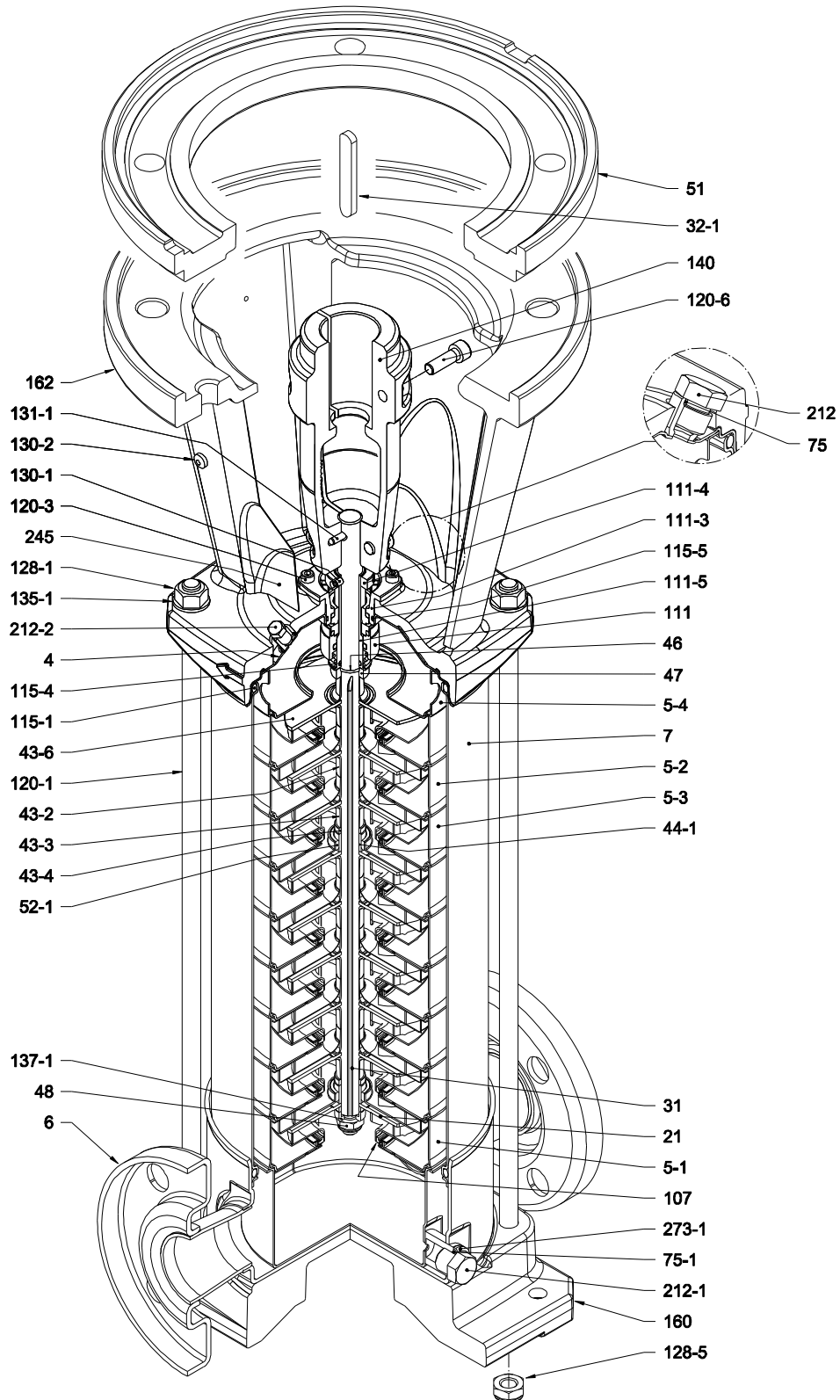

with Round (ANSI Compatible) flange (F)

**PIPE CONNECTION**

**EVMSU(L)15**

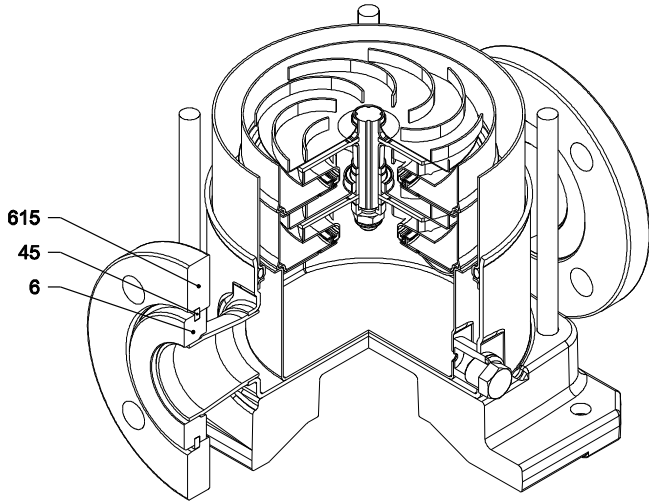

with Loose round ANSI compatible flange (L)

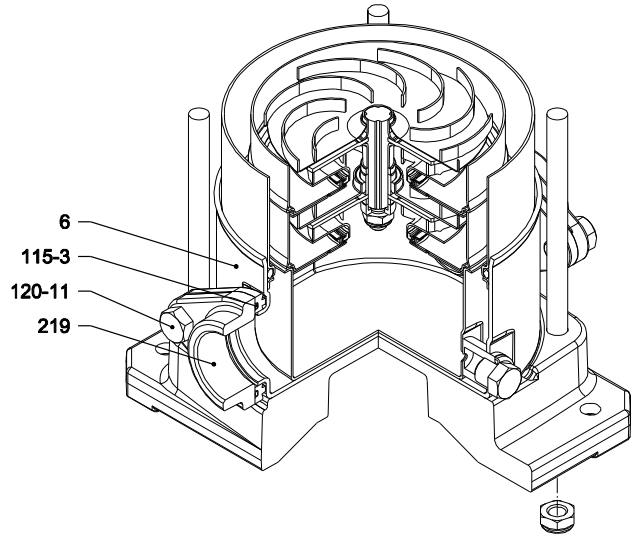

with Oval flange (N)

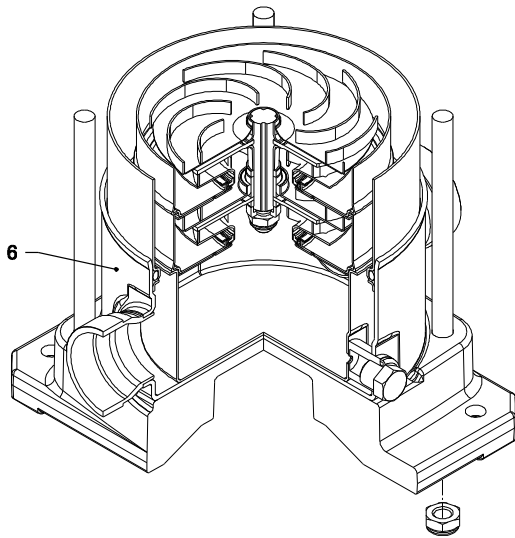

with victaulic connection (V)

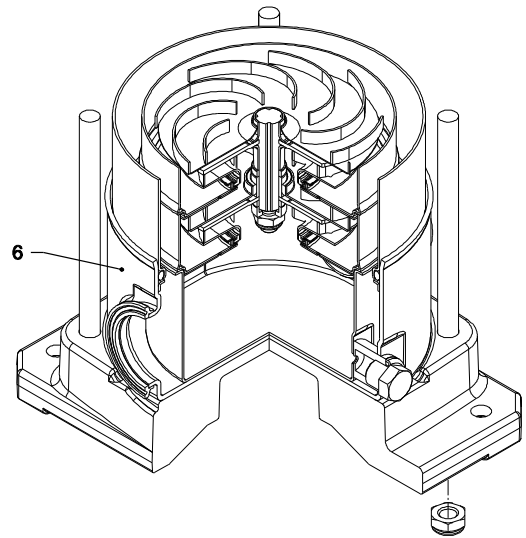

with Clamp connection (C)

**SECTIONAL VIEW PART REFERENCE**
**EVMSU(L)15**

N°	PART NAME	MATERIAL		DIMENSIONS [mm]	STANDARD
		EVMSU	EVMSUL		
4	Casing cover	AISI 304 (EN 1.4301)	AISI 316 (EN 1.4401)		
5-1	Suction casing	AISI 304 (EN 1.4301)	AISI 316 (EN 1.4401)		
5-2	Intermediate Casing	AISI 304 (EN 1.4301)	AISI 316 (EN 1.4401)		
5-3	Intermediate casing bearing	AISI 304 (EN 1.4301)	AISI 316 (EN 1.4401)		
5-4	Discharge casing	AISI 304 (EN 1.4301)	AISI 316 (EN 1.4401)		
6	Bottom casing	AISI 304 (EN 1.4301)	AISI 316 (EN 1.4401)		
7	Outer casing	AISI 304 (EN 1.4301)	AISI 316L (EN 1.4404)		
21	Impeller	AISI 304 (EN 1.4301)	AISI 316 (EN 1.4401)		
31	Shaft	AISI 304 (EN 1.4301) - AISI 329A (EN 1.4462)	AISI 316L (EN 1.4404) - AISI 329A (EN 1.4462)		
32-1	Adjuster Key	AISI 304 (EN 1.4301)			
43-2	Shaft sleeve (intermediate)	AISI 304 (EN 1.4301)	AISI 316L (EN 1.4404)		
43-3	Shaft sleeve (bearing)	AISI 304 (EN 1.4301)	AISI 316 (EN 1.4401)		
43-4	Shaft sleeve (adjustment)	AISI 304 (EN 1.4301)	AISI 316 (EN 1.4401)		
43-6	Washer	AISI 316L (EN 1.4404)		D. 26x1.2	
44-1	Shaft sleeve bearing	Tungsten carbide			
45	Flange holder	AISI 304 (EN 1.4301)			
46	Ring (mechanical seal)	AISI 316L (EN 1.4404)			
47	Ring Holder	AISI 304 (EN 1.4301)	AISI 316 (EN 1.4401)		
48	Impeller nut	A2-70 UNI 7323 with inox insert	A4-70 UNI 7323 with inox insert	M10	
51	Motor adapter	Cast iron EN-GJL-200-EN 1561			
52-1	Bearing	Tungsten carbide			
75	O-Ring (plug)	FPM		D. 12.37x2.62	OR 3050
75-1	O-Ring (plug)	FPM			
107	Liner ring	AISI 304 (EN 1.4301) + PPS	AISI 316 (EN 1.4401) + PPS		
111	Mechanical Seal	SiC/Carbon/FPM			
111-3	Mechanical seal seat	AISI 304 (EN 1.4301)	AISI 316 (EN 1.4401)		
111-4	Seal holder	AISI 304 (EN 1.4301)			
111-5	Mechanical seal cartridge	AISI 304 (EN 1.4301)	AISI 316 (EN 1.4401)		
115-1	O-Ring (outer casing)	FPM		D. 164.46x5.34	OR 6645
115-3	O-Ring	FPM			
115-4	O-Ring (cartridge sleeve)	FPM		D. 15.88x2.62	OR 121
115-5	O-Ring (seal cover)	FPM		D. 37.77x2.62	OR 3150
120-1	Tie-rod	Galvanized steel 6.8 strength class ISO 898/1		M12	
120-3	Screw	A2-70 UNI 7323		M5x12	ISO 4762
120-6	Screw for coupling	up to 5 HP from 7.5 HP to 11 HP above 15 HP	Galvanized steel	M6x25	ISO 4762
				M8x20	ISO 4762
				M10x30	ISO 4762
120-11	Screw for counterflange	A2-70 UNI 7323			
128-1	Nut for tie rod	Galvanized steel		M12	UNI 5588
128-5	Nut for tie rod	Galvanized steel		M12	UNI 7474
130-1	Set screw	A2-70 UNI 7323		M5x8	UNI 5923
130-2	Screw for coupling guard	A2-70 UNI 7323		M5x6	UNI 7687
131-1	Pin for shaft	Carbon Steel		D. 5x35	UNI 4838
135-1	Washer	Galvanized steel		D. 13x24x2.5	UNI 6592
137-1	Impeller spacer	AISI 304 (EN 1.4301)	AISI 316 (EN 1.4401)		
140	Coupling	Die cast Aluminium EN AB-AISI11Cu2 (Fe) Cast iron EN-GJL-200-EN 1561			
160	Base	Die cast Aluminium EN AB-AISI11Cu2 (Fe)			
162	Motor bracket	Cast iron EN-GJL-200-EN 1561			
212	Plug	AISI 304 (EN 1.4301)	AISI 316 (EN 1.4401)	G 3/8 (BSPP)	
212-1	Plug	AISI 304 (EN 1.4301)	AISI 316 (EN 1.4401)	G 3/8 (BSPP)	
212-2	Venting plug	AISI 316L (EN 1.4404)			
219	Counter flange	AISI 304 (EN 1.4301)	AISI 316 (EN 1.4401)		
245	Coupling guard	AISI 304 (EN 1.4301)			
273-1	Plug Washer	AISI 304 (EN 1.4301)	AISI 316 (EN 1.4401)		
615	Flange	Carbon steel			

**PART QUANTITY FOR MODEL  
EVMSU(L)15**

Pump Type	N°																															
	4	5-1	5-2	5-3	5-4	6	7	21	31***	32-1	43-2	43-3	43-4	43-6	44-1	45**	46	47	48	51	52-1	75	75-1	107	111	111-3	111-4	111-5	115-1	115-3*	115-4	115-5
EVMSU(L)15 1	1	1	/	1	1	1	1	1	1	/	1	1	1	1	4	2	1	1	/	1	1	2	1	1	1	1	1	1	2	2	1	1
EVMSU(L)15 2	1	1	/	1	1	1	2	1	1	1	1	1	/	1	4	2	1	1	/	1	1	2	2	1	1	1	1	1	2	2	1	1
EVMSU(L)15 3	1	1	1	1	1	1	3	1	1	3	1	1	/	1	4	2	1	1	/	1	1	2	3	1	1	1	1	1	2	2	1	1
EVMSU(L)15 4	1	1	2	1	1	1	4	1	1	5	1	1	/	1	4	2	1	1	/	1	1	2	4	1	1	1	1	1	2	2	1	1
EVMSU(L)15 5	1	1	3	1	1	1	5	1	1	7	1	1	/	1	4	2	1	1	/	1	1	2	5	1	1	1	1	1	2	2	1	1
EVMSU(L)15 6	1	1	3	2	1	1	6	1	1	7	2	2	/	2	4	2	1	1	/	2	1	2	6	1	1	1	1	2	2	1	1	
EVMSU(L)15 7	1	1	4	2	1	1	7	1	1	9	2	2	/	2	4	2	1	1	/	2	1	2	7	1	1	1	1	2	2	1	1	
EVMSU(L)15 8	1	1	5	2	1	1	8	1	1	11	2	2	/	2	4	2	1	1	/	2	1	2	8	1	1	1	1	2	/	1	1	
EVMSU(L)15 9	1	1	6	2	1	1	9	1	1	13	2	2	/	2	4	2	1	1	/	2	1	2	9	1	1	1	1	2	/	1	1	
EVMSU(L)15 10	1	1	7	2	1	1	10	1	1	15	2	2	/	2	4	2	1	1	/	2	1	2	10	1	1	1	1	2	/	1	1	
EVMSU(L)15 11	1	1	8	2	1	1	11	1	1	17	2	2	/	2	4	2	1	1	/	2	1	2	11	1	1	1	1	2	/	1	1	
EVMSU(L)15 12	1	1	9	2	1	1	12	1	1	19	2	2	/	2	4	2	1	1	/	2	1	2	12	1	1	1	1	2	/	1	1	

Pump Type	N°																				
	120-1	120-3	120-6	120-11*	128-1	128-5	130-1	130-2	131-1	135-1	137-1	140	160	162	212	212-1	212-2	219*	245	273-1	615**
EVMSU(L)15 1	4	4	4	4	4	4	3	4	1	4	1	2	1	1	1	2	1	2	2	2	2
EVMSU(L)15 2	4	4	4	4	4	4	3	4	1	4	1	2	1	1	1	2	1	2	2	2	2
EVMSU(L)15 3	4	4	4	4	4	4	3	4	1	4	1	2	1	1	1	2	1	2	2	2	2
EVMSU(L)15 4	4	4	4	4	4	4	3	4	1	4	1	2	1	1	1	2	1	2	2	2	2
EVMSU(L)15 5	4	4	4	4	4	4	3	4	1	4	1	2	1	1	1	2	1	2	2	2	2
EVMSU(L)15 6	4	4	4	4	4	4	3	4	1	4	1	2	1	1	1	2	1	2	2	2	2
EVMSU(L)15 7	4	4	4	4	4	4	3	4	1	4	1	2	1	1	1	2	1	2	2	2	2
EVMSU(L)15 8	4	4	4	/	4	4	3	4	1	4	1	2	1	1	1	2	1	/	2	2	2
EVMSU(L)15 9	4	4	4	/	4	4	3	4	1	4	1	2	1	1	1	2	1	/	2	2	2
EVMSU(L)15 10	4	4	4	/	4	4	3	4	1	4	1	2	1	1	1	2	1	/	2	2	2
EVMSU(L)15 11	4	4	4	/	4	4	3	4	1	4	1	2	1	1	1	2	1	/	2	2	2
EVMSU(L)15 12	4	4	4	/	4	4	3	4	1	4	1	2	1	1	1	2	1	/	2	2	2

- \* only for Oval flange (N)
- \*\* only for Loose round flange (L)
- \*\*\* ■ shaft in AISI 329A (EN 1.4462)
- 128-6 / 135-6 : with Aluminium coupling

**SECTIONAL VIEW**  
**EVMSU(L)20**

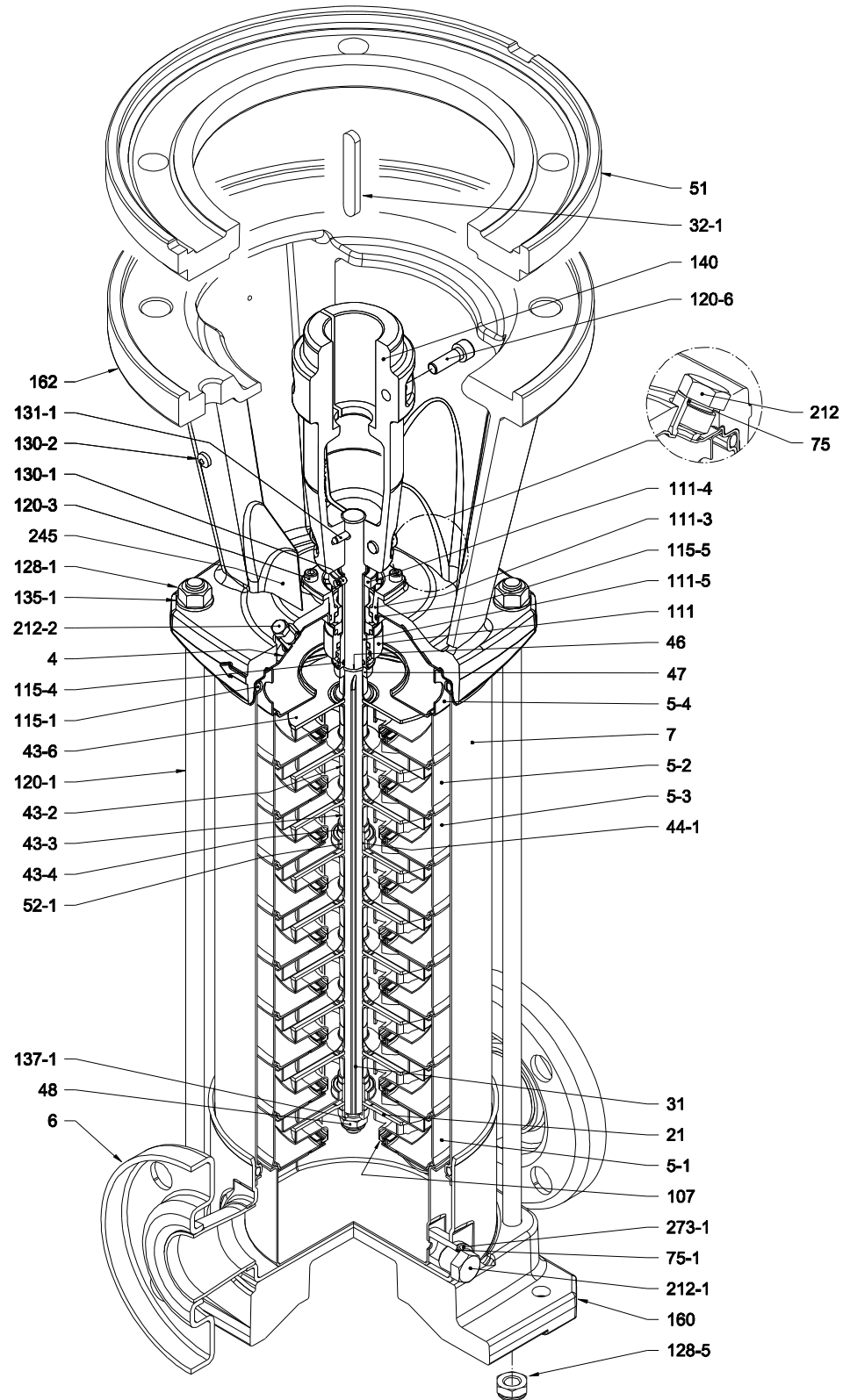

with Round (ANSI Compatible) flange (F)

**PIPE CONNECTION**  
**EVMSU(L)20**

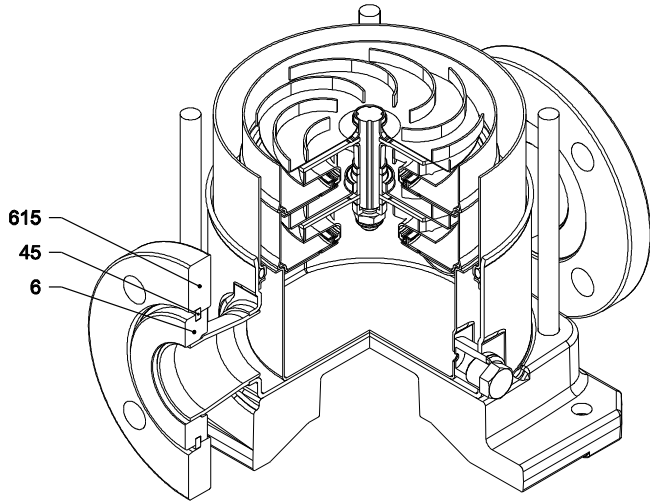

with Loose round ANSI compatible flange (L)

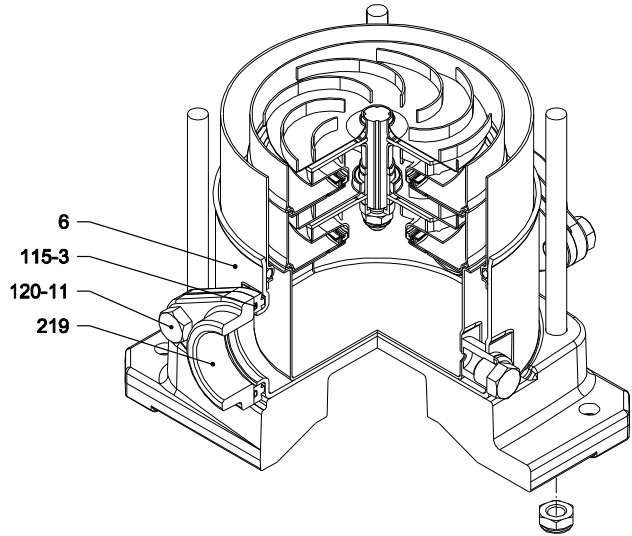

with Oval flange (N)

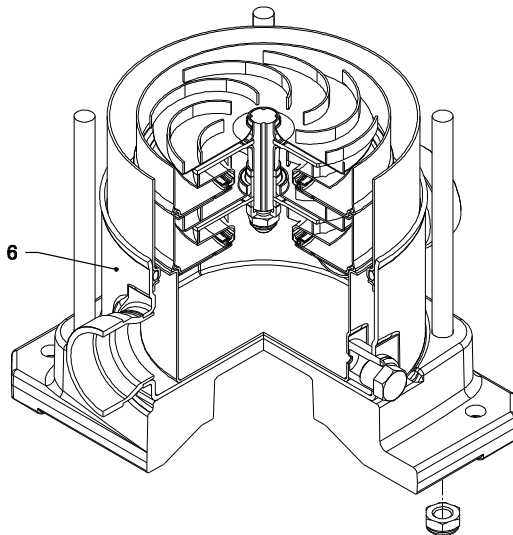

with victaulic connection (V)

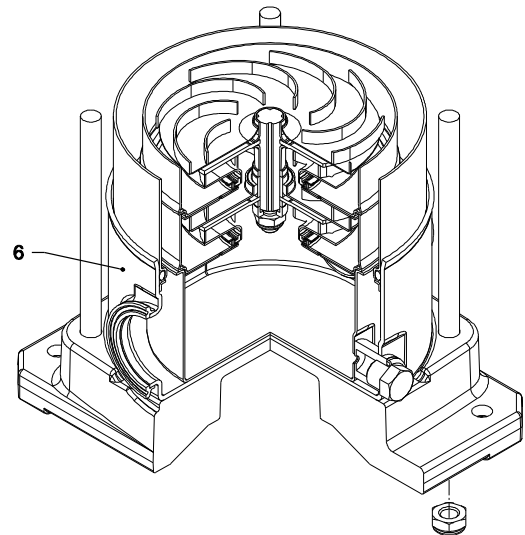

with Clamp connection (C)

**SECTIONAL VIEW PART REFERENCE**
**EVMSU(L)20**

N°	PART NAME	MATERIAL		DIMENSIONS [mm]	STANDARD
		EVMSU	EVMSUL		
4	Casing cover	AISI 304 (EN 1.4301)	AISI 316 (EN 1.4401)		
5-1	Suction casing	AISI 304 (EN 1.4301)	AISI 316 (EN 1.4401)		
5-2	Intermediate Casing	AISI 304 (EN 1.4301)	AISI 316 (EN 1.4401)		
5-3	Intermediate casing bearing	AISI 304 (EN 1.4301)	AISI 316 (EN 1.4401)		
5-4	Discharge casing	AISI 304 (EN 1.4301)	AISI 316 (EN 1.4401)		
6	Bottom casing	AISI 304 (EN 1.4301)	AISI 316 (EN 1.4401)		
7	Outer casing	AISI 304 (EN 1.4301)	AISI 316L (EN 1.4404)		
21	Impeller	AISI 304 (EN 1.4301)	AISI 316 (EN 1.4401)		
31	Shaft	AISI 304 (EN 1.4301) - AISI 329A (EN 1.4462)	AISI 316L (EN 1.4404) - AISI 329A (EN 1.4462)		
32-1	Adjuster Key	AISI 304 (EN 1.4301)			
43-2	Shaft sleeve (intermediate)	AISI 304 (EN 1.4301)	AISI 316L (EN 1.4404)		
43-3	Shaft sleeve (bearing)	AISI 304 (EN 1.4301)	AISI 316 (EN 1.4401)		
43-4	Shaft sleeve (adjustment)	AISI 304 (EN 1.4301)	AISI 316 (EN 1.4401)		
43-6	Washer	AISI 316L (EN 1.4404)		D. 26x1.2	
44-1	Shaft sleeve bearing	Tungsten carbide			
45	Flange holder	AISI 304 (EN 1.4301)			
46	Ring (mechanical seal)	AISI 316L (EN 1.4404)			
47	Ring Holder	AISI 304 (EN 1.4301)	AISI 316 (EN 1.4401)		
48	Impeller nut	A2-70 UNI 7323 with inox insert	A4-70 UNI 7323 with inox insert	M10	
51	Motor adapter	Cast iron EN-GJL-200-EN 1561			
52-1	Bearing	Tungsten carbide			
75	O-Ring (plug)	FPM		D. 12.37x2.62	OR 3050
75-1	O-Ring (plug)	FPM			
107	Liner ring	AISI 304 (EN 1.4301) + PPS	AISI 316 (EN 1.4401) + PPS		
111	Mechanical Seal	SiC/Carbon/FPM			
111-3	Mechanical seal seat	AISI 304 (EN 1.4301)	AISI 316 (EN 1.4401)		
111-4	Seal holder	AISI 304 (EN 1.4301)			
111-5	Mechanical seal cartridge	AISI 304 (EN 1.4301)	AISI 316 (EN 1.4401)		
115-1	O-Ring (outer casing)	FPM		D. 164.46x5.34	OR 6645
115-3	O-Ring	FPM			
115-4	O-Ring (cartridge sleeve)	FPM		D. 15.88x2.62	OR 121
115-5	O-Ring (seal cover)	FPM		D. 37.77x2.62	OR 3150
120-1	Tie-rod	Galvanized steel 6.8 strength class ISO 898/1		M12	
120-3	Screw	A2-70 UNI 7323		M5x12	ISO 4762
120-6	Screw for coupling	up to 5 HP from 7.5 HP to 11 HP above 15 HP	Galvanized steel	M6x25	ISO 4762
				M8x20	ISO 4762
				M10x30	ISO 4762
120-11	Screw for counterflange	A2-70 UNI 7323			
128-1	Nut for tie rod	Galvanized steel		M12	UNI 5588
128-5	Nut for tie rod	Galvanized steel		M12	UNI 7474
130-1	Set screw	A2-70 UNI 7323		M5x8	UNI 5923
130-2	Screw for coupling guard	A2-70 UNI 7323		M5x6	UNI 7687
131-1	Pin for shaft	Carbon Steel		D. 5x35	UNI 4838
135-1	Washer	Galvanized steel		D. 13x24x2.5	UNI 6592
137-1	Impeller spacer	AISI 304 (EN 1.4301)	AISI 316 (EN 1.4401)		
140	Coupling	Die cast Aluminium EN AB-AISI11Cu2 (Fe) Cast iron EN-GJL-200-EN 1561			
160	Base	Die cast Aluminium EN AB-AISI11Cu2 (Fe)			
162	Motor bracket	Cast iron EN-GJL-200-EN 1561			
212	Plug	AISI 304 (EN 1.4301)	AISI 316 (EN 1.4401)	G 3/8 (BSPP)	
212-1	Plug	AISI 304 (EN 1.4301)	AISI 316 (EN 1.4401)	G 3/8 (BSPP)	
212-2	Venting plug	AISI 316L (EN 1.4404)			
219	Counter flange	AISI 304 (EN 1.4301)	AISI 316 (EN 1.4401)		
245	Coupling guard	AISI 304 (EN 1.4301)			
273-1	Plug Washer	AISI 304 (EN 1.4301)	AISI 316 (EN 1.4401)		
615	Flange	Carbon steel			

**PART QUANTITY FOR MODEL  
EVMSU(L)20**

Pump Type	N°																																
	4	5-1	5-2	5-3	5-4	6	7	21	31***	32-1	43-2	43-3	43-4	43-6	44-1	45**	46	47	48	51	52-1	75	75-1	107	111	111-3	111-4	111-5	115-1	115-3*	115-4	115-5	
EVMSU(L)20 1	1	1	/	1	1	1	1	1	1	1	/	1	1	1	1	4	2	1	1	/	1	1	2	1	1	1	1	1	1	2	2	1	1
EVMSU(L)20 2	1	1	/	1	1	1	1	2	1	1	1	1	1	/	1	4	2	1	1	/	1	1	2	2	1	1	1	1	1	2	2	1	1
EVMSU(L)20 3	1	1	1	1	1	1	1	3	1	1	3	1	1	/	1	4	2	1	1	/	1	1	2	3	1	1	1	1	1	2	2	1	1
EVMSU(L)20 4	1	1	2	1	1	1	1	4	1	1	5	1	1	/	1	4	2	1	1	/	1	1	2	4	1	1	1	1	1	2	2	1	1
EVMSU(L)20 5	1	1	2	2	1	1	1	5	1	1	5	2	2	/	2	4	2	1	1	/	2	1	2	5	1	1	1	1	2	2	1	1	
EVMSU(L)20 6	1	1	3	2	1	1	1	6	1	1	7	2	2	/	2	4	2	1	1	/	2	1	2	6	1	1	1	1	2	2	1	1	
EVMSU(L)20 7	1	1	4	2	1	1	1	7	1	1	9	2	2	/	2	4	2	1	1	1	2	1	2	7	1	1	1	1	2	/	1	1	
EVMSU(L)20 8	1	1	5	2	1	1	1	8	1	1	11	2	2	/	2	4	2	1	1	1	2	1	2	8	1	1	1	1	2	/	1	1	
EVMSU(L)20 9	1	1	6	2	1	1	1	9	1	1	13	2	2	/	2	4	2	1	1	1	2	1	2	9	1	1	1	1	2	/	1	1	
EVMSU(L)20 10	1	1	7	2	1	1	1	10	1	1	15	2	2	/	2	4	2	1	1	1	2	1	2	10	1	1	1	1	2	/	1	1	

Pump Type	N°																				
	120-1	120-3	120-6	120-11*	128-1	128-5	130-1	130-2	131-1	135-1	137-1	140	160	162	212	212-1	212-2	219*	245	273-1	615**
EVMSU(L)20 1	4	4	4	4	4	4	3	4	1	4	1	2	1	1	1	2	1	2	2	2	2
EVMSU(L)20 2	4	4	4	4	4	4	3	4	1	4	1	2	1	1	1	2	1	2	2	2	2
EVMSU(L)20 3	4	4	4	4	4	4	3	4	1	4	1	2	1	1	1	2	1	2	2	2	2
EVMSU(L)20 4	4	4	4	4	4	4	3	4	1	4	1	2	1	1	1	2	1	2	2	2	2
EVMSU(L)20 5	4	4	4	4	4	4	3	4	1	4	1	2	1	1	1	2	1	2	2	2	2
EVMSU(L)20 6	4	4	4	4	4	4	3	4	1	4	1	2	1	1	1	2	1	2	2	2	2
EVMSU(L)20 7	4	4	4	/	4	4	3	4	1	4	1	2	1	1	1	2	1	/	2	2	2
EVMSU(L)20 8	4	4	4	/	4	4	3	4	1	4	1	2	1	1	1	2	1	/	2	2	2
EVMSU(L)20 9	4	4	4	/	4	4	3	4	1	4	1	2	1	1	1	2	1	/	2	2	2
EVMSU(L)20 10	4	4	4	/	4	4	3	4	1	4	1	2	1	1	1	2	1	/	2	2	2

\* only for Oval flange (N)  
 \*\* only for Loose round flange (L)  
 \*\*\* ■ shaft in AISI 329A (EN 1.4462)  
 128-6 / 135-6 : with Aluminium coupling



**SECTIONAL VIEW**

**MODEL EVMUG32  
EVMUL32**

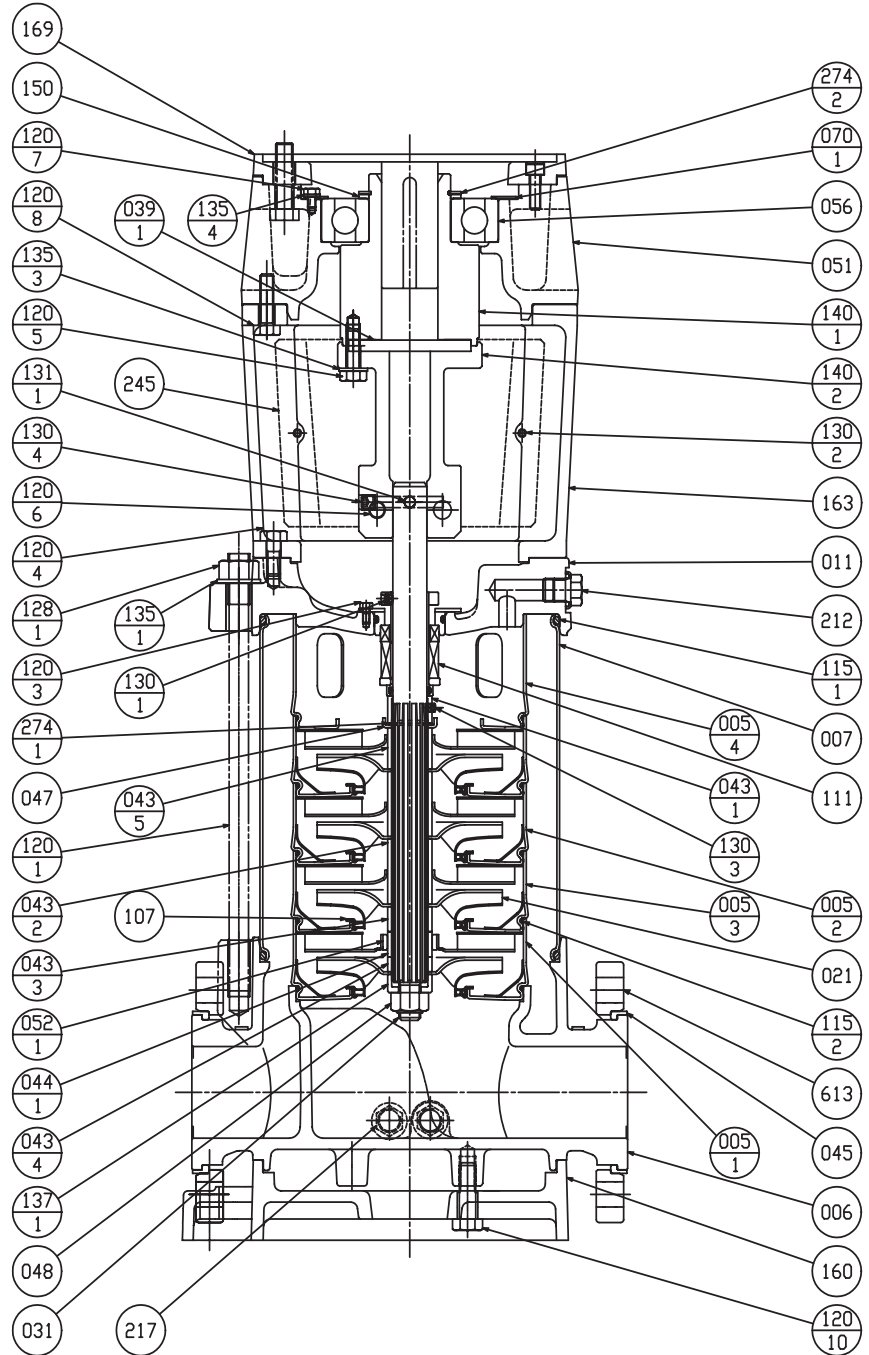
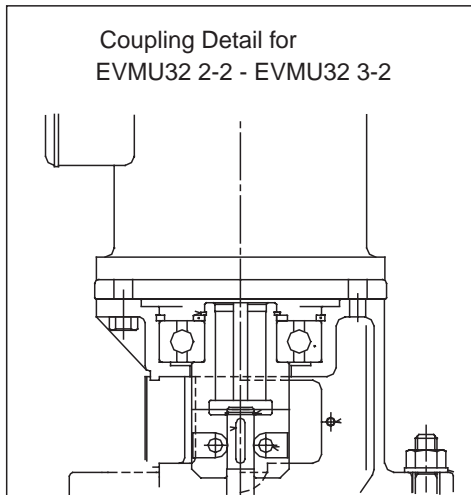
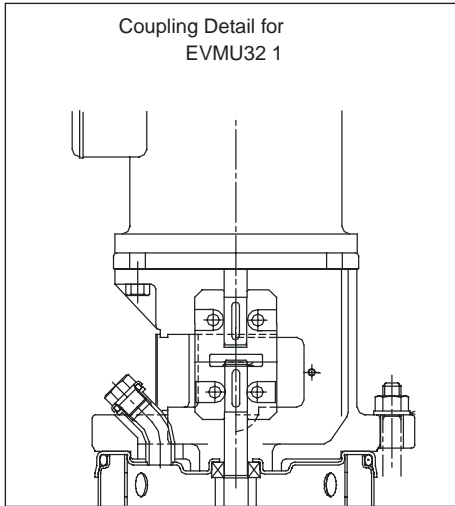

*(For reference only. See pricing for part availability.)*

**SECTIONAL VIEW**

**MODEL EVMUG32  
EVMUL32**

NO.	PART NAME	MATERIAL	
		EVMUG	EVMUL
005-1	Stage casing (suction)	AISI304	AISI316
005-2	Stage casing	AISI304	AISI316
005-3	Stage casing (bearing)	AISI304	AISI316
005-4	Stage casing (Top)	AISI304	AISI316
006	Bottom casing	Cast iron EN-GJL-250	Cast AISI316 (G-X6CrNiMo18 0)
007	Outer sleeve	AISI304	AISI316
011	Casing cover	Cast iron EN-GJS-400-15	Cast iron EN-GJS-400-15+AISI304
021	Impeller	AISI304	AISI316
031	Shaft	AISI316	
039-1	Key (coupling)	C45	
043-1	Shaft sleeve (mechanical seal)	AISI304	AISI316
043-2	Shaft sleeve (stage)	AISI304	AISI316
043-3	Shaft sleeve (bearing/upper)	AISI304	AISI316
043-4	Shaft sleeve (bearing/lower)	AISI304	AISI316
043-5	Shaft sleeve (top)	AISI304	AISI316
044-1	Bearing sleeve (stage)	Tungsten carbide	
045	Adjusting ring	C40	
047	Split ring retainer	AISI304	AISI316
048	Friction nut	AISI304	AISI316
051	Bearing housing	Cast iron EN-GJL-200	
052-1	Bearing (stage)	Tungsten carbide	
056	Ball bearing	-	
070-1	Bearing holder	AISI304	
107	Wear ring	AISI316+PTFE	
111	Mechanical seal Cartridge ass'y	SiC/Carbon/FPM/316	
115-1	O-ring (outer)	FPM	
115-2	O-ring (stage)	FPM	
120-1	Tie-rod bolt	Zincate steel with 6.8 strength class ISO 898/1	
120-3	Bolt (mechanical seal)	Stainless steel A2-70 ISO3506	
120-4	Bolt (casing cover)	Stainless steel A2-70 ISO3506	
120-5	Bolt (coupling M-side)	Zincate steel with 8.8 strength class ISO 898/1	
120-6	Bolt (coupling P-side)	Zincate steel with 8.8 strength class ISO 898/1	
120-7	Bolt (bearing)	Zincate steel with 8.8 strength class ISO 898/1	
120-8	Bolt (bearing housing)	Zincate steel with 8.8 strength class ISO 898/1	
120-10	Bolt (base plate)	Zincate steel with 8.8 strength class ISO 898/1	
128-1	Nut (tie-rod bolt)	Zincate steel with 6S strength class ISO 898/2	
130-1	Screw (mechanical seal)	Stainless steel A2-70 ISO3506	
130-2	Screw (coupling guard)	Stainless steel A2-70 ISO3506	
130-3	Screw (mechanical seal)	Stainless steel A2-70 ISO3506	
130-4	Screw (coupling pin)	Strength class 45H ISO898/5	
131-1	Pin (shaft)	CF35SMnPb10	
135-1	Washer (tie-rod bolt)	Zincate steel	
135-3	Spring washer (coupling bolt M-side)	Zincate steel	
135-4	Spring washer (bearing)	Zincate steel	
137-1	Shaft end sleeve	AISI304	AISI316
140-1	Coupling upper half	Steel (36SMnPb14)	
140-2	Coupling lower half	Steel (36SMnPb14)	
150	Spacer (coupling)	C45	
160	Base plate	Cast iron EN-GJL-200	
163	Motor stool	Cast iron EN-GJL-200	
169	Motor liner	Cast iron EN-GJL-200	
212	Vent plug (with seal ring)	AISI304/FPM	AISI316/FPM
217	Plug (with seal ring)	AISI304/FPM	AISI316/FPM
245	Coupling guard	AISI304	
274-1	C-ring (top)	AISI304	AISI316
274-2	C-ring (coupling)	Carbon tool steel (TC80)	
613	Pump flange	C40	

*(For reference only. See pricing for part availability.)*

**SECTIONAL VIEW**

**MODEL EVMUG45  
EVMUG64  
EVMUL45  
EVMUL64**

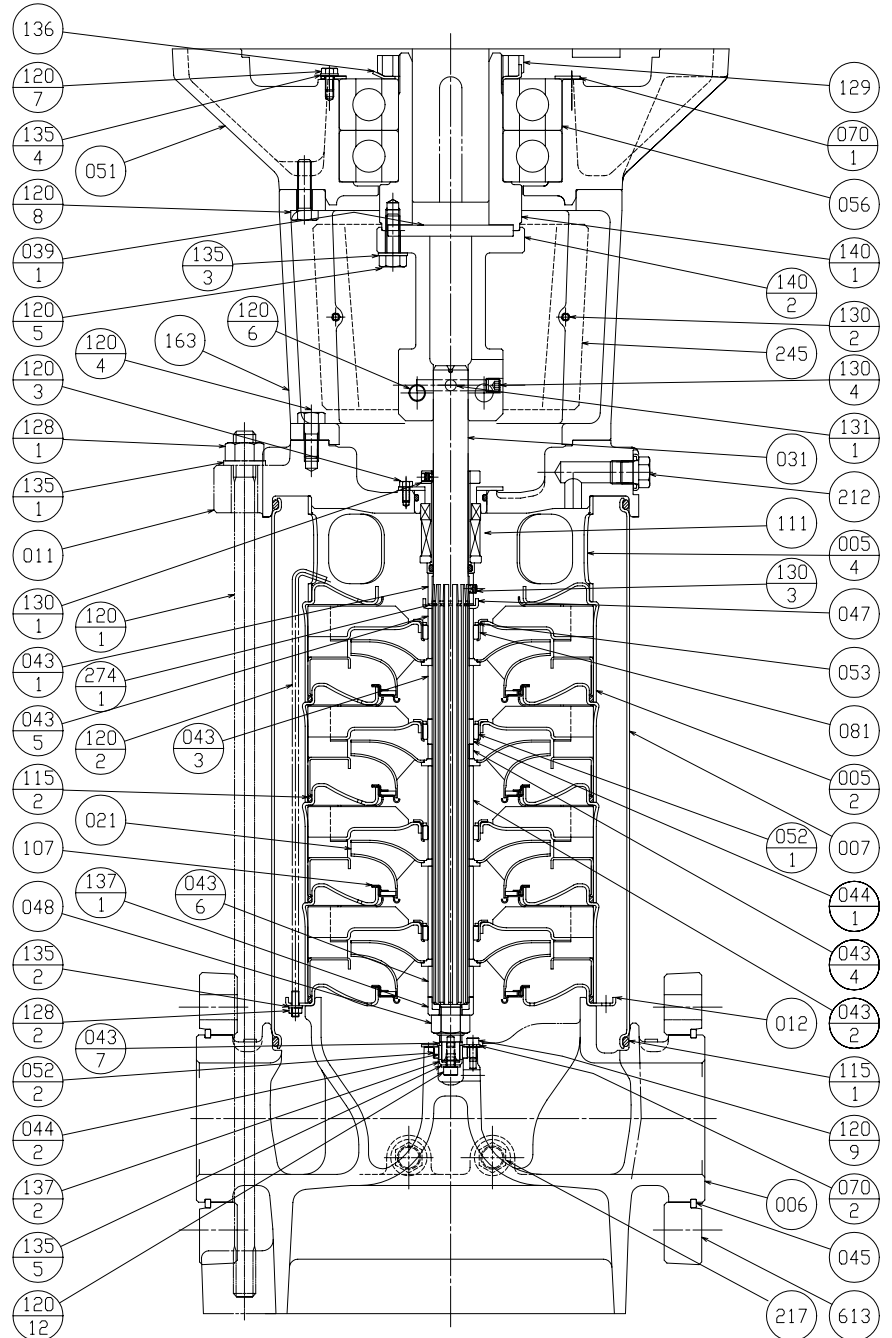
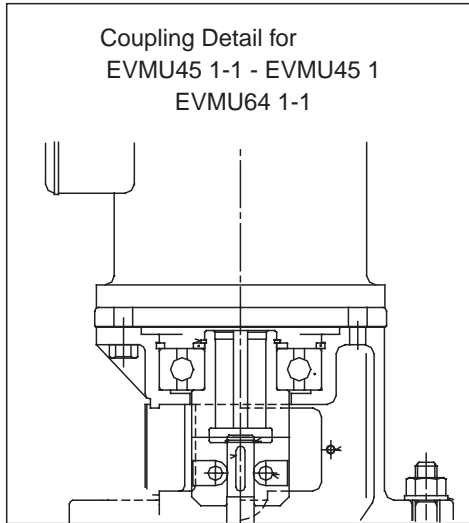

*(For reference only. See pricing for part availability.)*

**SECTIONAL VIEW – PART REFERENCE**

**Model EVMUG45 EVMUG64  
EVMUL45 EVMUL64**

NO.	PART NAME	MATERIAL	
		EVMUG	EVMUL
005-2	Stage casing	AISI304	AISI316
005-4	Top casing	AISI304	AISI316
006	Bottom casing	16bar:Cast iron EN-GJL-250 25bar:Cast iron EN-GJS-400-15	Cast AISI316 (G-X6CrNiMo18 0)
007	Outer sleeve	AISI304	AISI316
011	Casing cover	Cast iron EN-GJS-400-15	Cast iron EN-GJS-400-15+AISI316
012	Suction cover	AISI304	AISI316
021	Impeller	AISI304	AISI316
031	Shaft	AISI316	
039-1	Key (coupling)	C45	
043-1	Shaft sleeve (mechanical seal)	AISI304	AISI316
043-2	Shaft sleeve (stage)	AISI304	AISI316
043-3	Shaft sleeve (bearing/upper)	AISI304	AISI316
043-4	Shaft sleeve (bearing/lower)	AISI304	AISI316
043-5	Shaft sleeve (top)	AISI304	AISI316
043-6	Shaft sleeve (suction)	AISI304	AISI316
043-7	Shaft sleeve (bottom bearing)	AISI304	AISI316
044-1	Bearing sleeve (stage)	Tungsten carbide	
044-2	Bearing sleeve (bottom bearing)	Tungsten carbide	
045	Adjusting ring	C40	
047	Split ring retainer	AISI304	AISI316
048	Friction nut	AISI304	AISI316
051	Bearing housing	Cast iron EN-GJL-200	
052-1	Bearing (stage)	Tungsten carbide	
052-2	Bearing (bottom)	Tungsten carbide	
053	Bush holder	AISI304	AISI316
056	Ball bearing	-	
070-1	Bearing holder	AISI304	
070-2	Bearing holder (bottom bearing)	AISI304	AISI316
081	Bush	PTFE(ally)	
107	Wear ring	AISI316+PTFE	
111	Mechanical seal Cartridge ass'y	SiC/Carbon/FPM316	
115-1	O-ring (outer)	FPM	
115-2	O-ring (stage)	FPM	
120-1	Tie-rod bolt	Zincate steel with 6.8 strength class ISO 898/1	
120-2	Stack bolt	AISI304	AISI316
120-3	Bolt (mechanical seal)	Stainless steel A2-70 ISO3506	
120-4	Bolt (casing cover)	Stainless steel A2-70 ISO3506	
120-5	Bolt (coupling M-side)	Zincate steel with 8.8 strength class ISO 898/1	
120-6	Bolt (coupling P-side)	Zincate steel with 8.8 strength class ISO 898/1	
120-7	Bolt (bearing)	Zincate steel with 8.8 strength class ISO 898/1	
120-8	Bolt (bearing housing)	Zincate steel with 8.8 strength class ISO 898/1	
120-9	Bolt (bottom bearing)	Stainless steel A2-70 ISO3506	
120-12	Bolt (shaft end)	Stainless steel A2-70 ISO3506	
128-1	Nut (tie-rod bolt)	Zincate steel with 6S strength class ISO 898/2	
128-2	Nut (Stack bolt)	AISI304	
129	Bearing nut (coupling)	Carbon steel	
130-1	Screw (mechanical seal)	Stainless steel A2-70 ISO3506	
130-2	Screw (coupling guard)	Stainless steel A2-70 ISO3506	
130-3	Screw (mechanical seal)	Stainless steel A2-70 ISO3506	
130-4	Screw (coupling pin)	Strength class 45H ISO898/5	
131-1	Pin (shaft)	CF35SMnPb10	
135-1	Washer (tie-rod bolt)	Zincate steel	
135-2	Spring washer (Stack bolt)	AISI304	AISI316
135-3	Spring washer (coupling bolt M-side)	Zincate steel	
135-4	Spring washer (bearing)	Zincate steel	
135-5	Spring washer (shaft end)	AISI304	AISI316
136	Bearing washer (coupling)	Carbon steel	
137-1	Shaft end sleeve	AISI304	AISI316
137-2	Shaft end sleeve	AISI304	AISI316
140-1	Coupling upper half	Steel (36SMnPb14)	
140-2	Coupling lower half	Steel (36SMnPb14)	
163	Motor stool	Cast iron EN-GJL-200	
212	Vent plug (with seal ring)	AISI304/FPM	AISI316/FPM
217	Plug (with seal ring)	AISI304/FPM	AISI316/FPM
245	Coupling guard	AISI304	
274-1	C-ring (top)	AISI304	AISI316
613	Pump flange	C40	

*(For reference only. See pricing for part availability.)*