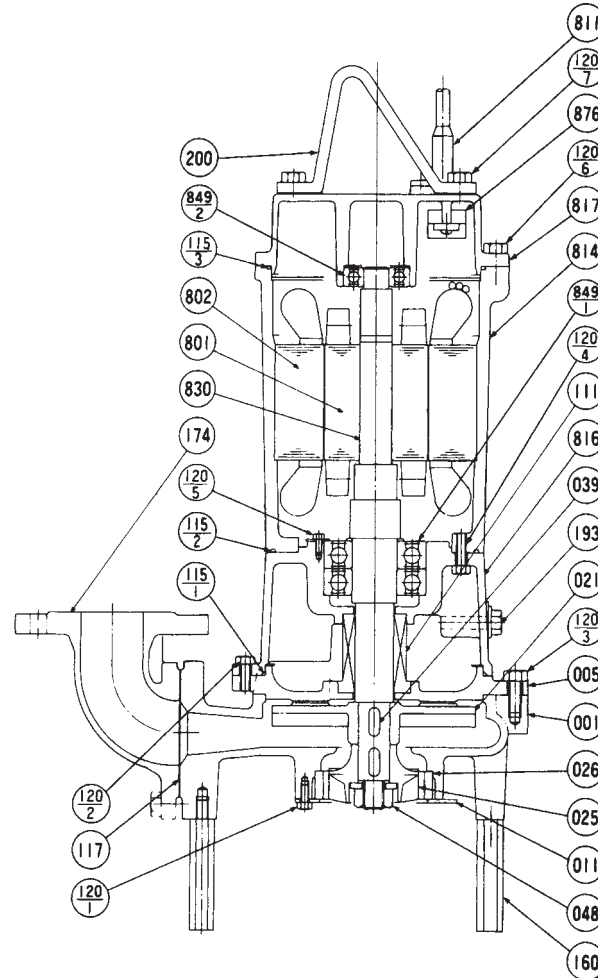

Model CGUI/CGFU
EBARA PRO Cast Grinder Pumps
Sectional View
Single Phase
32CGUII

| PART NO. | PART NAME | MATERIAL | ASTM, AISI CODE | NO. FOR 1 UNIT |
|----------|---------------------|--------------------------|-----------------|----------------|
| 001 | CASING | CAST IRON | A48 Class 30 | 1 |
| 005 | INTERMEDIATE CASING | CAST IRON | A48 Class 30 | 1 |
| 011 | DISK COVER | 304 STAINLESS | AISI304 | 1 |
| †021 | IMPELLER | CAST IRON | A48 Class 30 | 1 |
| †025 | GRINDER IMPELLER | CHROME ALLOYED CAST IRON | | 1 |
| †026 | CUTTER RING | CHROME ALLOYED CAST IRON | | 1 |
| 039 | KEY | 420 STAINLESS | AISI420 | 2 |
| 048 | IMPELLER NUT | 304 STAINLESS | AISI304 | 1 |
| †111 | MECHANICAL SEAL | — | | 1 SET |
| †115-1 | O-RING | RUBBER (NBR) | | 1 |
| †115-2 | O-RING | RUBBER (NBR) | | 1 |
| †115-3 | O-RING | RUBBER (NBR) | | 1 |
| †117 | GASKET | | | 1 |
| 120-1 | BOLT | 304 STAINLESS | AISI304 | 4 |
| 120-2 | BOLT | 304 STAINLESS | AISI304 | 4 |
| 120-3 | BOLT | 304 STAINLESS | AISI304 | 4 |
| 120-4 | BOLT | 304 STAINLESS | AISI304 | 4 |

| PART NO. | PART NAME | MATERIAL | ASTM, AISI CODE | NO. FOR 1 UNIT |
|----------|-------------------|---------------|-----------------|----------------|
| 120-5 | BOLT | 304 STAINLESS | AISI304 | 2 |
| 120-6 | BOLT | 304 STAINLESS | AISI304 | 4 |
| 120-7 | BOLT | 304 STAINLESS | AISI304 | 2 |
| 160 | PUMP STAND | STEEL | A283 Grade D | 3 |
| 174 | DISCHARGE ELBOW | CAST IRON | A48 Class 30 | 1 |
| 193 | OIL PLUG | 304 STAINLESS | AISI304 | 1 |
| 200 | LIFTING HANGER | STEEL | A283 Grade D | 1 |
| 801 | ROTOR | — | | 1 |
| 802 | STATOR | — | | 1 |
| †811 | SUBMERSIBLE CABLE | — | | 1 |
| 814 | MOTOR FRAME | CAST IRON | A48 Class 30 | 1 |
| 816 | BRACKET | CAST IRON | A48 Class 30 | 1 |
| 817 | BRACKET | CAST IRON | A48 Class 30 | 1 |
| 830 | SHAFT | 403 STAINLESS | AISI403 | 1 |
| †849-1 | BALL BEARING | — | | 1 |
| †849-2 | BALL BEARING | — | | 1 |
| 876 | MOTOR PROTECTOR | — | | 1 |

Motors are purchased as a complete unit

†: Recommended spare parts

Model CGUI/CGFU
EBARA PRO Cast Grinder Pumps
Sectional View
Single and Three Phase

32CGFU, 2HP

50CGFU 3 to 5HP

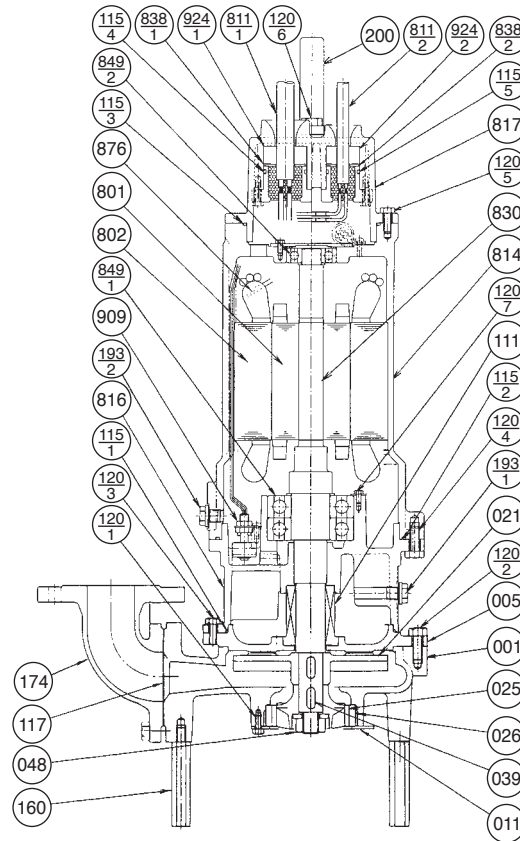

| PART NO. | PART NAME | MATERIAL | ASTM, AISI CODE | NO. FOR 1 UNIT | PART NO. | PART NAME | MATERIAL | ASTM, AISI CODE | NO. FOR 1 UNIT |
|----------|---------------------|--------------------------|-----------------|----------------|----------|------------------|---------------|-----------------|----------------|
| 001 | CASING | CAST IRON | A48 Class 30 | 1 | 160 | PUMP STAND | STEEL | A283 Grade D | 3 |
| 005 | INTERMEDIATE CASING | CAST IRON | A48 Class 30 | 1 | 174 | DISCHARGE ELBOW | CAST IRON | A48 Class 30 | 1 |
| 011 | DISK COVER | 304 STAINLESS | AISI304 | 1 | 193-1 | PLUG | 304 STAINLESS | AISI304 | 1 |
| †021 | IMPELLER | CAST IRON | A48 Class 30 | 1 | 193-2 | PLUG | 304 STAINLESS | AISI304 | 1 |
| †025 | GRINDER IMPELLER | CHROME ALLOYED CAST IRON | | 1 | 200 | LIFTING HANGER | STEEL | A283 Grade D | 1 |
| †026 | CUTTER RING | CHROME ALLOYED CAST IRON | | 1 | 801 | ROTOR | — | | 1 |
| 039 | KEY | 420 STAINLESS | AISI420 | 2 | 802 | STATOR | — | | 1 |
| 048 | IMPELLER NUT | 304 STAINLESS | AISI304 | 1 | 811-1 | POWER CABLE | — | | 1 |
| †111 | MECHANICAL SEAL | — | | 1 SET | 811-2 | CONTROL CABLE | — | | 1 |
| †115-1 | O-RING | RUBBER (NBR) | | 1 | 814 | MOTOR FRAME | CAST IRON | A48 Class 30 | 1 |
| †115-2 | O-RING | RUBBER (NBR) | | 1 | 816 | BRACKET | CAST IRON | A48 Class 30 | 1 |
| †115-3 | O-RING | RUBBER (NBR) | | 1 | 817 | BRACKET | CAST IRON | A48 Class 30 | 1 |
| †115-4 | O-RING | RUBBER (NBR) | | 1 | 830 | SHAFT | 403 STAINLESS | AISI403 | 1 |
| †115-5 | O-RING | RUBBER (NBR) | | 1 | 838-1 | WASHER | 304 STAINLESS | AISI304 | 1 |
| †117 | GASKET | | | 1 | 838-2 | WASHER | 304 STAINLESS | AISI304 | 1 |
| 120-1 | BOLT | 304 STAINLESS | AISI304 | 4 | †849-1 | BALL BEARING | — | | 1 SET |
| 120-2 | BOLT | 304 STAINLESS | AISI304 | 4 | †849-2 | BALL BEARING | — | | 1 |
| 120-3 | BOLT | 304 STAINLESS | AISI304 | 4 | 876 | MOTOR PROTECTOR | — | | 3 |
| 120-4 | BOLT | 304 STAINLESS | AISI304 | 4 | 909 | LEAKAGE DETECTOR | — | | 1 |
| 120-5 | BOLT | 304 STAINLESS | AISI304 | 4 | 924-1 | PACKING | RUBBER (NBR) | | 1 |
| 120-6 | BOLT | 304 STAINLESS | AISI304 | 2 | 924-2 | PACKING | RUBBER (NBR) | | 1 |
| 120-7 | BOLT | 304 STAINLESS | AISI304 | 3 | | | | | |

Motors are purchased as a complete unit

†: Recommended spare parts