

# MP PUMPS SERVICE PARTS LIST

- Self-Priming
- Pumpak
- Pedestal Mount Hydraulic Motor Drive

**FLOMAX 5 1 1/2" x 1 1/2" Pipe Size**  
**FLOMAX 8 2" x 2" Pipe Size**

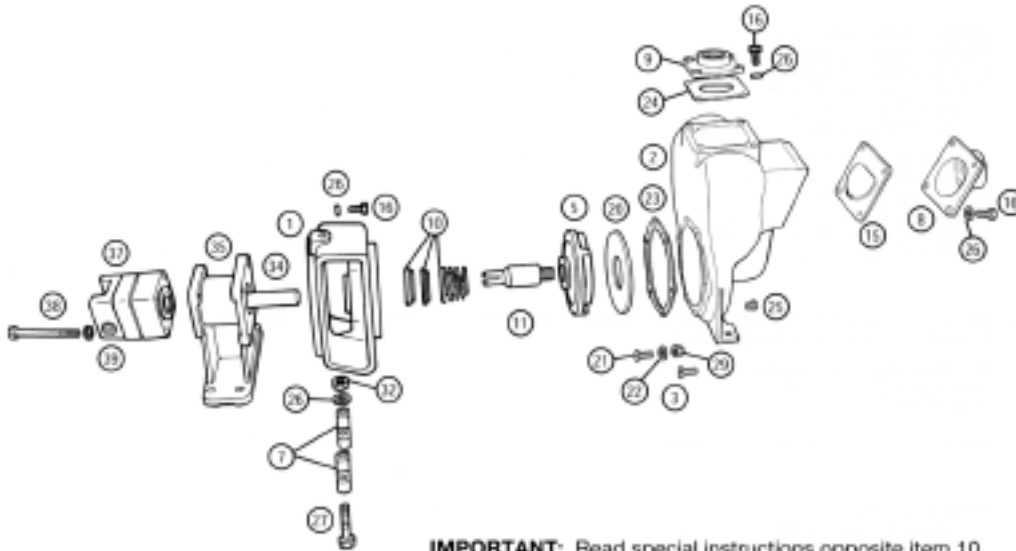

**IMPORTANT:** Read special instructions opposite item 10.  
 When ordering parts, specify MODEL and SERIAL NUMBER shown on nameplate.  
 N/S means "not shown" in exploded view of parts.

ITEM	PART NO.	DESCRIPTION	QUANTITY REQUIRED PER MODEL						
			CAST IRON		ALUMINUM		BRONZE		
			FLOMAX						
<b>ADAPTOR</b>									
1	22247	Adaptor — Cast Iron	1	1					
1	22245	Adaptor — Aluminum			1	1			
1	22246	Adaptor — Bronze					1	1	
1	24865	Adaptor — Cast Iron — Grease Seal	1	1					
1	24007	Adaptor — Aluminum — Grease Seal			1	1			
<b>HOUSING</b>									
2	23021	Housing Assembly — Cast Iron — Inc.:	1	1					
		Housing — Cast Iron	1	1					
16	21242	Capscrew — Discharge Flange	8	8					
3	24865	Capscrew S.S. 5/16" x 3/4"	6	6					
26	21238	Lockwasher	8	8					
25	21267	Pipe Plug	1	1					
2	23019	Housing Assembly — Aluminum — Inc.:			1	1			
		Housing — Aluminum			1	1			
16	21242	Capscrew — Flange — Dis. & Suc.			8	8			
3	24865	Capscrew S.S. 5/16" x 3/4"			6	6			
26	21238	Lockwasher			8	8			
25	21267	Pipe Plug			1	1			
2	23019	Housing Assembly — Bronze — Inc.:					1	1	
		Housing — Bronze					1	1	
16	21242	Capscrew — Flange — Dis. & Suc.					8	8	
3	24865	Capscrew S.S. 5/16" x 3/4"					6	6	
26	21238	Lockwasher					8	8	
25	21267	Pipe Plug					1	1	
<b>IMPELLER</b>									
5	22293	Impeller — Cast Iron	1	1					
5	22294	Impeller — Stainless Steel— Optional	1	1	1	1	1	1	
5	22291	Impeller — Aluminum			1	1			
5	22292	Impeller — Bronze					1	1	
N/S	22555	Impeller Lock Nut — Stainless Steel	1	1	1	1	1	1	



**MP PUMPS, INC.**

34800 BENNETT • FRASER, MI 48026-1686  
 (586) 293-8240 • FAX (586) 293-8469  
 (800) 563-8006 • www.mppumps.com

**FORM 7053-C**

PRINTED IN U.S.A. (11-98)

ITEM	PART NO.	DESCRIPTION	QUANTITY REQUIRED PER MODEL						
			FLOMAX	CAST IRON		ALUMINUM		BRONZE	
				5	8	5	8	5	8
<b>CLAMP</b>									
7	23002	Clamp Assembly — Includes: Clamp	1	1	1	1	1	1	
27	21254	Capscrew 5/16"-18 x 1-3/4"	2	2	2	2	2	2	
32	21284	Hex Nut 5/16"-18	2	2	2	2	2	2	
26	21238	Lockwasher 5/16"	2	2	2	2	2	2	
<b>FLANGE</b>									
8	22263	Flange — Inlet — Cast Iron — 1-1/2"	1						
8	22387	Flange — Inlet — Cast Iron — 2"		1					
8	22261	Flange — Inlet — Aluminum — 1-1/2"			1				
8	22385	Flange — Inlet — Aluminum — 2"				1			
8	22262	Flange — Inlet — Bronze — 1-1/2"					1		
8	22386	Flange — Inlet — Bronze — 2"						1	
9	22266	Flange — Outlet — Cast Iron — 1-1/2"	1						
9	22311	Flange — Outlet — Cast Iron — 2"		1					
9	22264	Flange — Outlet — Aluminum — 1-1/2"			1				
9	22309	Flange — Outlet — Aluminum — 2"				1			
9	22265	Flange — Outlet — Bronze — 1-1/2"					1		
9	22310	Flange — Outlet — Bronze — 2"						1	
<b>SEAL</b>									
10		Be sure you specify whether you want the self-lubricated seal or the grease-lubricated seal. Seals for special applications are available as listed in the "Accessories" section of our catalog.							
10	22272	Seal Assembly — Self-lubricated	1	1	1	1	1	1	
10	22290	Seal Assembly — Grease-lubricated	1	1	1	1	1	1	
18	22313	Grease Cup	1	1	1	1			
11	22286	Drive Sleeve — Stainless Steel 3/4" Bore	1	1	1	1	1	1	
<b>FLAPPER</b>									
15	22022	Flapper Assembly	1	1	1	1	1	1	
15	26097	Flapper Assembly — EPDM — Optional	1	1	1	1			
<b>WEAR PLATE</b>									
20	23024	Wear Plate Assembly — Steel — Inc.: Wear Plate — Steel	1	1					
21	21249	Flat Head Screw — 5/16"-18 x 1"	2	2					
22	21248	Annular Gasket	2	2					
20	22270	Wear Plate Assembly — Aluminum — Inc.: Wear Plate — Aluminum			1	1			
21	21249	Flat Head Screw — 5/16"-18 x 1"			2	2			
22	21248	Annular Gasket			2	2			
20	22271	Wear Plate Assembly — Bronze — Inc.: Wear Plate — Bronze					1	1	
21	22249	Flat Head Screw — 5/16"-18 x 1"					2	2	
22	21248	Annular Gasket					2	2	
<b>GASKET</b>									
23	22255	Gasket	1	1	1	1	1	1	
24	22256	Gasket — Outlet	1	1	1	1	1	1	
24	25933	Gasket — EPDM — Optional	1	1	1	1			
29	21237	Acorn Nut — 5/16"-18	2	2	2	2	2	2	
<b>HYDRAULIC MOTOR &amp; PEDESTAL ASSEMBLY</b>									
37 & 35	29962	Hydraulic Motor (M11) & Pedestal Assy.	1	1	1	1	1	1	
37 & 35	29963	Hydraulic Motor (M20) & Pedestal Assy.	1	1	1	1	1	1	
37 & 35	29961	Hydraulic Motor (M9) & Pedestal Assy.	1	1	1	1	1	1	
35	29990	Pedestal Assembly	1	1	1	1	1	1	
34	29502	Shaft	1	1	1	1	1	1	
N/S	25470	Pedestal Casting	1	1	1	1	1	1	
N/S	22301	Ball Bearings	2	2	2	2	2	2	
N/S	25478	Retaining Ring	1	1	1	1	1	1	
16	21278	Capscrew S.S. 5/16"-18 x 7/8"	4	4	4	4	4	4	
26	21238	Lockwasher S.S. 5/16"	4	4	4	4	4	4	
37	29987	Hydraulic Motor — M11	1	1	1	1	1	1	
37	29988	Hydraulic Motor — M20	1	1	1	1	1	1	
37	29989	Hydraulic Motor — M9	1	1	1	1	1	1	
38	25477	Capscrew 5/16" x 4-1/2"	4	4	4	4	4	4	
39	21238	Lockwasher S.S. 5/16"	4	4	4	4	4	4	
N/S	30386	Service Kit Seal Hydraulic Motor	1	1	1	1	1	1	

N/S — NOT SHOWN



**MP PUMPS, INC.**

34800 BENNETT • FRASER, MI 48026-1686  
(586) 293-8240 • FAX (586) 293-8469  
(800) 563-8006 • www.mppumps.com

**FORM 7053-C**

PRINTED IN U.S.A. (11-98)